

# NOTICE OF LAND SALES

"McMurry Tract" - Listing #4349  
Pt. Sec.20,T12S, R20W,  
Nevada County, Arkansas,  
containing 24 acres, more or less.

"Bean 40 Tract" - Listing #4348  
SE 1/4 of NE 1/4 of S14,T12S, R20W  
Nevada County, Arkansas,  
containing 40 acres, more or less.

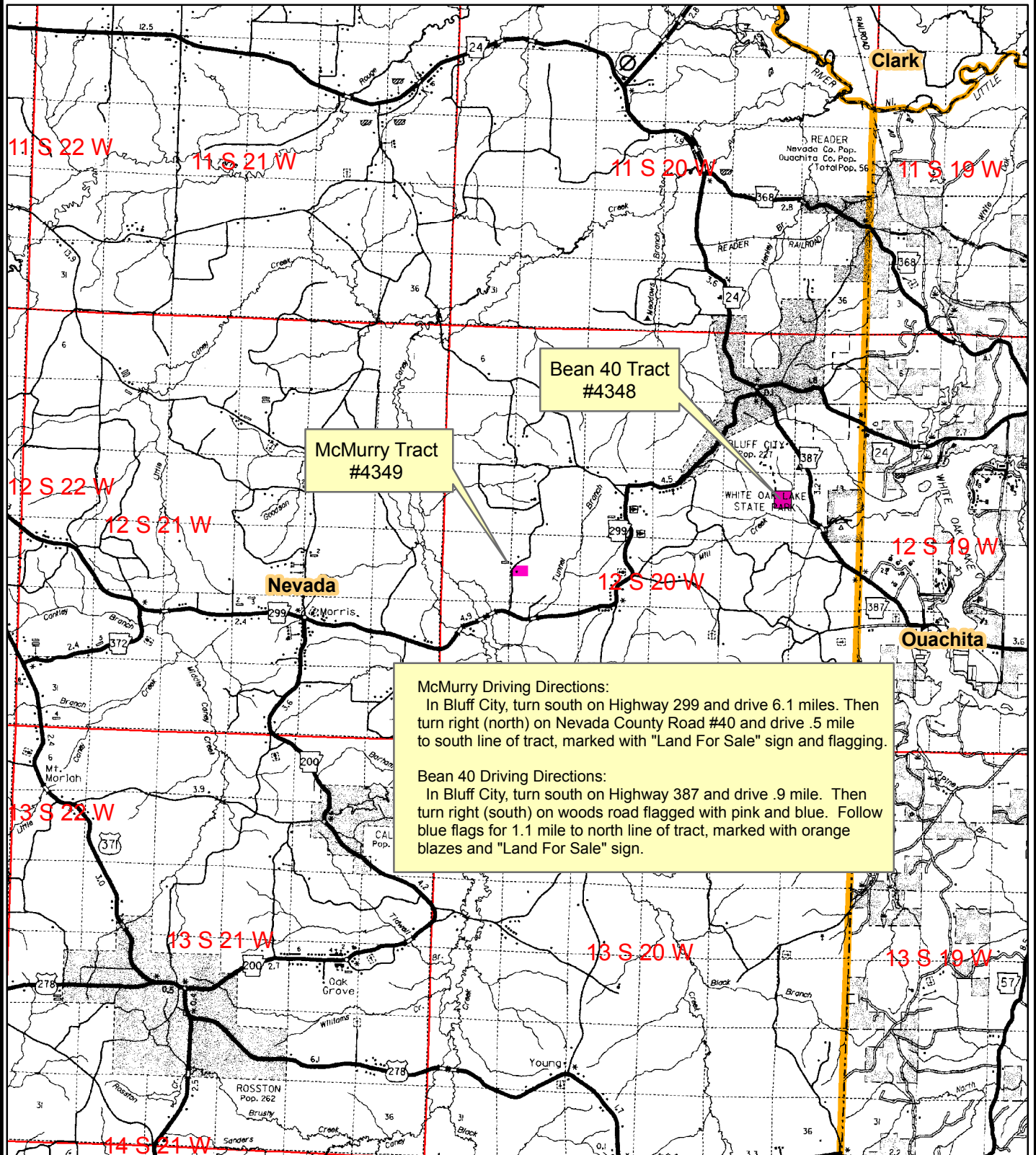

0 0.5 1 2 3  
Miles



Created: June, 2012  
Drawn By: JDT