

Soil Map—Reno County, Kansas
(Horton, Pamela)

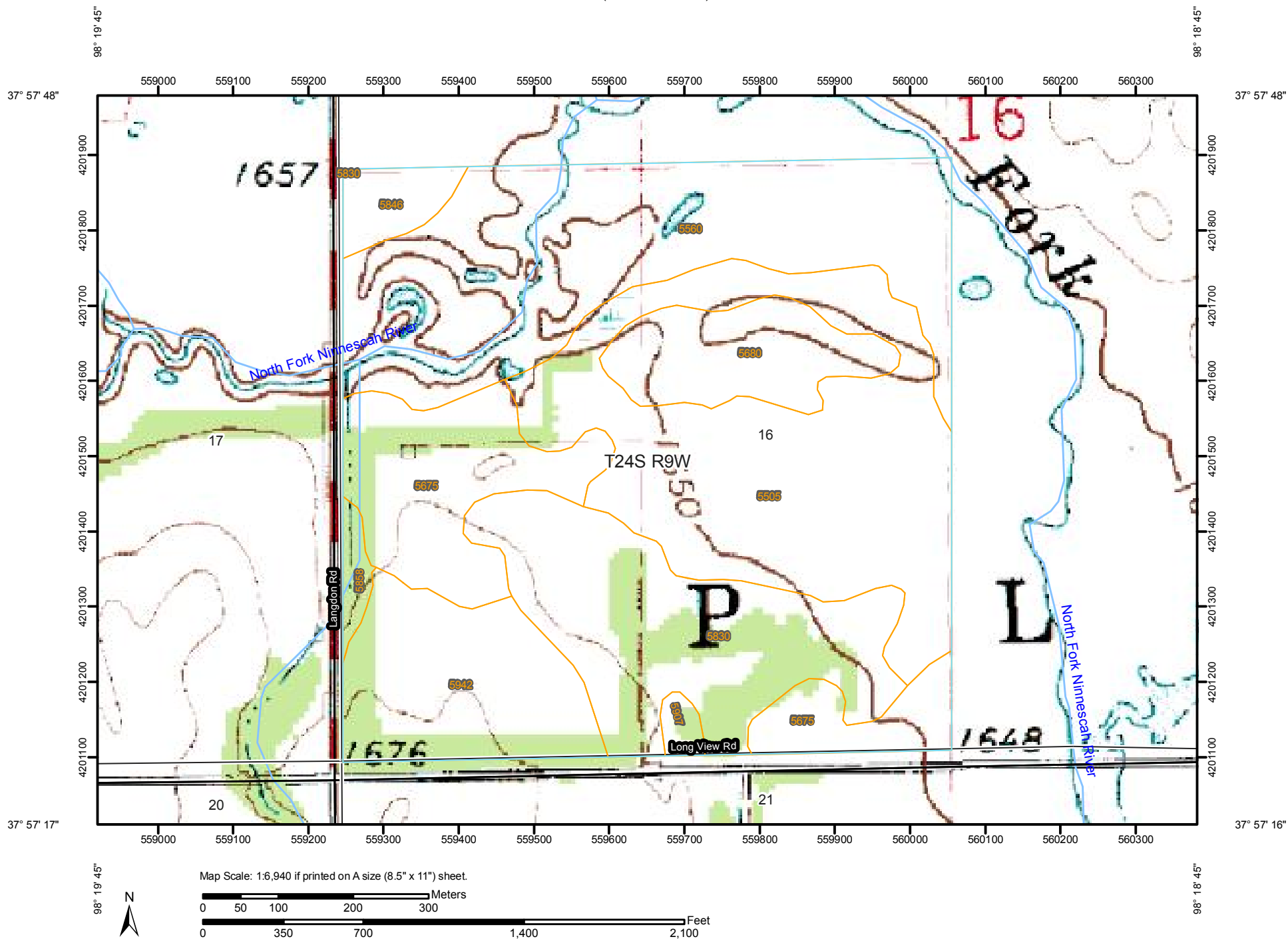

MAP LEGEND

Area of Interest (AOI)

 Area of Interest (AOI)

Soils

 Soil Map Units

Special Point Features

-  Blowout
-  Borrow Pit
-  Clay Spot
-  Closed Depression
-  Gravel Pit
-  Gravelly Spot
-  Landfill
-  Lava Flow
-  Marsh or swamp
-  Mine or Quarry
-  Miscellaneous Water
-  Perennial Water
-  Rock Outcrop
-  Saline Spot
-  Sandy Spot
-  Severely Eroded Spot
-  Sinkhole
-  Slide or Slip
-  Sodic Spot
-  Spoil Area
-  Stony Spot



Very Stony Spot



Wet Spot



Other

Special Line Features



Gully



Short Steep Slope



Other

Political Features



Cities



PLSS Township and Range



PLSS Section

Water Features



Streams and Canals

Transportation



Rails



Interstate Highways



US Routes



Major Roads



Local Roads

MAP INFORMATION

Map Scale: 1:6,940 if printed on A size (8.5" × 11") sheet.

The soil surveys that comprise your AOI were mapped at 1:24,000.

Warning: Soil Map may not be valid at this scale.

Enlargement of maps beyond the scale of mapping can cause misunderstanding of the detail of mapping and accuracy of soil line placement. The maps do not show the small areas of contrasting soils that could have been shown at a more detailed scale.

Please rely on the bar scale on each map sheet for accurate map measurements.

Source of Map: Natural Resources Conservation Service

Web Soil Survey URL: <http://websoilsurvey.nrcs.usda.gov>

Coordinate System: UTM Zone 14N NAD83

This product is generated from the USDA-NRCS certified data as of the version date(s) listed below.

Soil Survey Area: Reno County, Kansas

Survey Area Data: Version 8, Nov 29, 2010

Map Unit Legend

Reno County, Kansas (KS155)			
Map Unit Symbol	Map Unit Name	Acres in AOI	Percent of AOI
5505	Abbyville-Kisiwa complex, occasionally flooded	40.1	25.4%
5560	Kanza-Ninnescah sandy loams, frequently flooded	39.8	25.2%
5675	Willowbrook fine sandy loam, occasionally flooded	19.9	12.6%
5680	Yaggy-Saxman complex, occasionally flooded	10.2	6.5%
5830	Ninnescah fine sandy loam, occasionally flooded	26.0	16.5%
5846	Ninnescah fine sandy loam, occasionally flooded, saline	3.2	2.0%
5858	Albion-Shellabarger sandy loams, 1 to 3 percent slopes	1.3	0.9%
5907	Langdon fine sand, 0 to 15 percent slopes	1.0	0.6%
5942	Pratt-Turon fine sands, 1 to 5 percent slopes	16.1	10.2%
Totals for Area of Interest		157.7	100.0%