

Soils Map

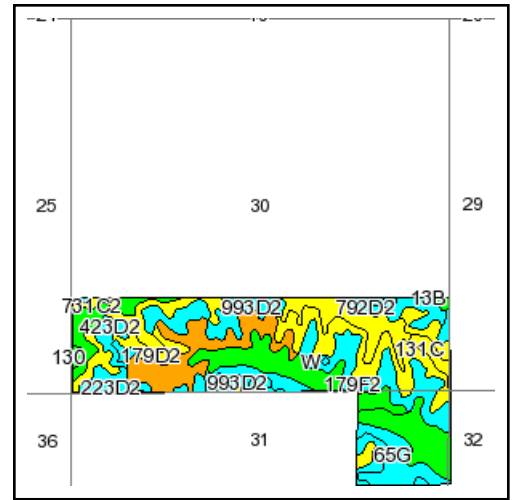

State: **Iowa**
 County: **Monroe**
 Location: **030-072N-018W**
 Township: **Guilford**
 Acres: **201.7**
 Date: **1/23/2012**

Fsa borders provided by the Farm Service Agency as of May 23, 2008.
 Soils data provided by USDA and NRCS.

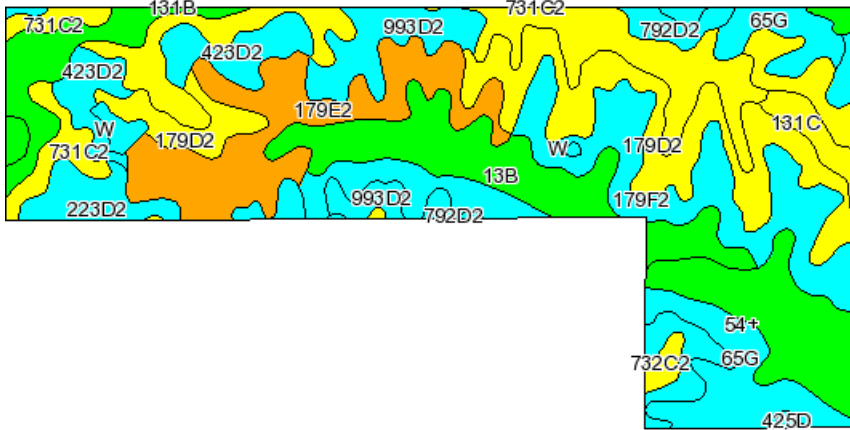
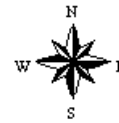

Maps provided by:



©AgriData, Inc 2008
 www.AgriDataInc.com

Code	Soil Description	Acres	Percent of field	CSR Legend	Non-Irr Class	CSR
179D2	Gara loam, 9 to 14 percent slopes, moderately eroded	28.9	14.3%		IVe	43
731C2	Pershing silty clay loam, 5 to 9 percent slopes, moderately eroded	26	12.9%		IIIe	45
65G	Lindley loam, 18 to 40 percent slopes	22.1	10.9%		VIIe	5
179E2	Gara loam, 14 to 18 percent slopes, moderately eroded	22	10.9%		VIe	33
179F2	Gara loam, 18 to 25 percent slopes, moderately eroded	21.4	10.6%		VIIe	13
13B	Olmitz-Colo-Vesser complex, 2 to 5 percent slopes	19.7	9.8%		Ile	60
54+	Zook silt loam, overwash, 0 to 2 percent slopes	14	6.9%		IIw	70
993D2	Gara-Armstrong loams, 9 to 14 percent slopes, moderately eroded	10	5.0%		IVe	20
423D2	Bucknell silty clay loam, 9 to 14 percent slopes, moderately eroded	9.7	4.8%		IVe	13
131B	Pershing silt loam, 2 to 5 percent slopes	8.2	4.1%		IIIe	67
223D2	Rinda silty clay loam, 9 to 14 percent slopes, moderately eroded	6.5	3.2%		IVe	9
424E2	Lindley-Keswick loams, 14 to 18 percent slopes, moderately eroded	3.7	1.8%		Ve	5
131C	Pershing silt loam, 5 to 9 percent slopes	3.1	1.5%		IIIe	49
792D2	Armstrong loam, 9 to 14 percent slopes, moderately eroded	2.6	1.3%		IVe	13
W	Water	1.4	0.7%			0
732C2	Weller silty clay loam, 5 to 9 percent slopes, moderately eroded	1.3	0.7%		IIIe	40
130	Belinda silt loam, 0 to 2 percent slopes	0.8	0.4%		IIIw	63
425D	Keswick loam, 9 to 14 percent slopes	0.3	0.2%		IVe	16
Weighted Average						34.4