

BEVERS REAL ESTATE

Serving Central Texas



Price: \$ 575,000
Type: Acreage
Address: 8600 Whiddon Rd.
City/County: Chappell Hill, Washington County
Acreage: ~162.893 Acres
Listing Name: Whiddon Acres
Status: Active

Whiddon Acres is located just south of Chappell Hill, Texas in a rural setting. It's southern boundary is Caney Creek, which flows year round, and is a great wildlife attraction. With the wildlife habitat, this property is well suited for recreation, cattle grazing, or hay pasture. Whiddon Acres has a gentle slope to the south running down to Caney Creek. It has about 22 acres that would make a great site to build a weekend getaway.

Washington County is one of the most rapidly developing areas in Texas. The beauty of the country side, with its pastoral views, wildflowers, and rolling hills, this area has been a favorite for Houstonians for years. Located within the heart of the [Texaplex](#), Washington County is positioned for increased growth. Check out information on [My290.com](#), TXDOT's web site today and see what plans are in store for this corridor to Houston.

Call Travis Bevers at 979-277-4920

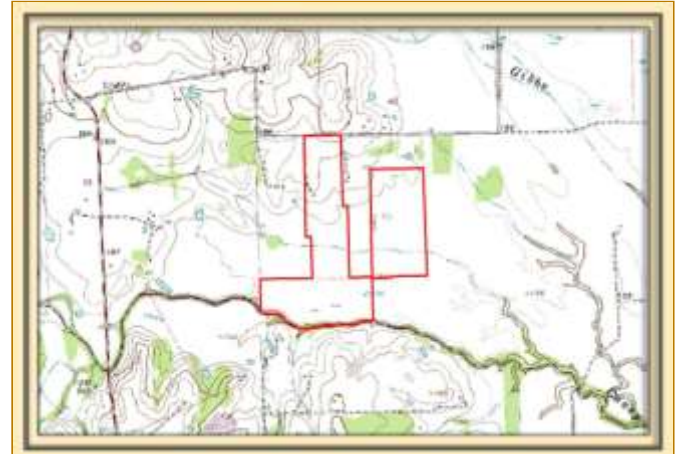

Land Features	Other	Financing
<ul style="list-style-type: none"> Live Creek County Road Frontage Minerals Conveyed: None Barn Well fencing 	<ul style="list-style-type: none"> School District: Brenham Taxes: \$ 298.26 AG Exempt 	<ul style="list-style-type: none"> Cash Conventional
<p>Directions: From Hwy 290: Turn South on FM 1371, go 4.8 miles turn left on Whiddon Rd, go 1.1 miles, property will be on your right.</p>		
<p>No representations or warranties either expressed or implied are made as to the accuracy of the information herein or with respect to the suitability, usability, feasibility, merchantability or condition of any property described herein. If your property is presently being offered for sale, this is not a solicitation of the listing.</p>		

WHIDDON ACRES



*162 AC WHIDDON RD
CHAPPELL HILL, TEXAS*

WHIDDON ACRES

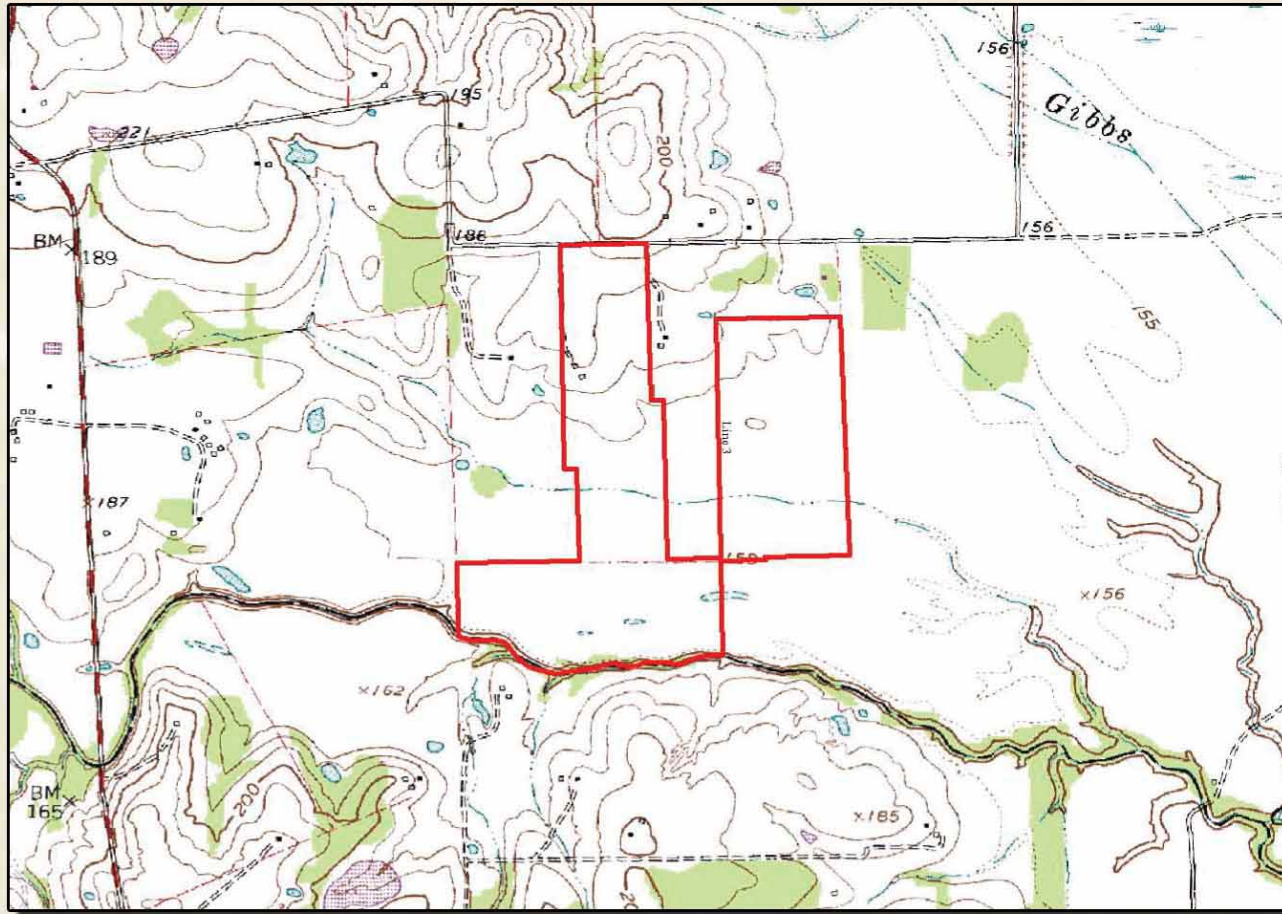

162 AC WHIDDON RD
CHAPPELL HILL, TEXAS