

FOR SALE: KITTSON COUNTY, MN FARM LAND

E 1/2 Section 32-159-48 • Approximately 319.07 Acres Near Hallock, MN



- ♦ Total Acres: 319.07
- ♦ Tillable Acres: 310.00
- ♦ 2011 Gross R.E. Taxes: \$1,746.⁰⁰
- ♦ Weighted Average Productivity: 69.7%

Driving Directions:

- ♦ From Hallock, MN take Hwy 75 14 miles South to Donaldson, MN.
- ♦ From Donaldson go 2 miles South on Hwy 75.
- ♦ Go 1/2 mile east on Hwy 18/460th St NW.
- ♦ You are now at the SW corner of the property.



STEVE JOHNSON
701-799-5213

FOR SALE: KITTSON COUNTY, MN FARM LAND

E 1/2 Section 32-159-48 • Approximately 319.07 Acres Near Hallock, MN

Soils Map

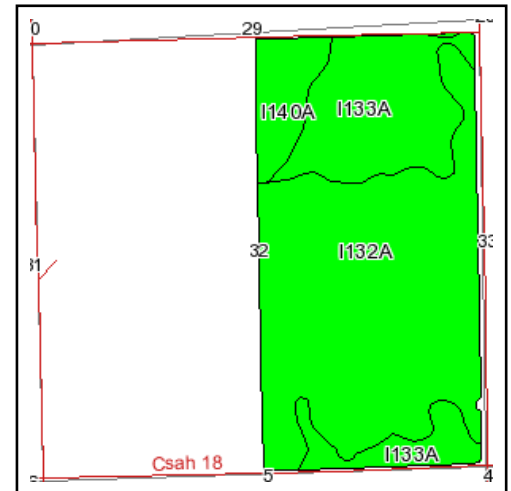
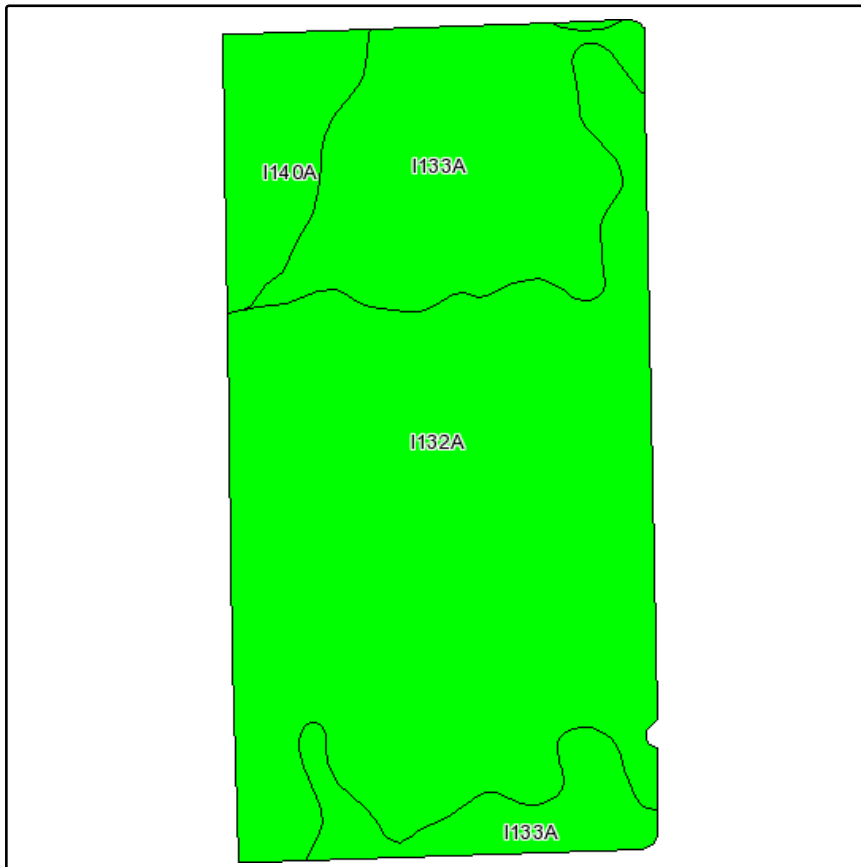

State: **Minnesota**
 County: **Kittson**
 Location: **032-159N-048W**
 Township: **Davis**
 Acres: **310**

Fsa borders provided by the Farm Service Agency as of May 23, 2008.
 Soils data provided by USDA and NRCS.

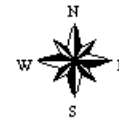

Code	Soil Description	Acres	Percent of field	Non-Irr Class Legend	Non-Irr Class	Productivity Index	Corn	Soybeans
I132A	Northcote-Eaglepoint clays, 0 to 2 percent slopes	199.8	64.5%		Ilw	69	73	28
I133A	Northcote clay, 0 to 1 percent slopes	86.8	28.0%		Ilw	73	77	29
I140A	Northcote clay, saline, 0 to 2 percent slopes	23.4	7.5%		Ilw	64	67	26
Weighted Average						69.7	73.7	28.1



Steve Johnson
 Farm Land Sales Realtor
 701-799-5213
steve@prglandsales.com



4265 45th Street South - Suite 200
 Fargo, North Dakota 58104
www.propertyresourcesgroup.com