

# BERRY PATCH TWO

A SUBDIVISION LOCATED ON

GOVERNMENT LOT 2, SEC 24,  
AND GOVERNMENT LOT 3, AND THE SE-SW, SEC 13,  
T 39N, R 11W, TOWN OF FIFIELD,  
PRICE COUNTY, WISCONSIN

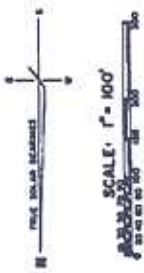

10/17/74  
Blaid & Associates

UNRESERVED LAND



**RESTRICTION:**  
LOTS 14, 15, 16, AND 18  
NO BUILDINGS SHALL BE LOCATED WITHIN  
25 FEET OF WELLS WITHIN 50 FEET OF  
THE ESTIMATED ABSORPTION AREA

**SITE**

PREPARED BY  
**SCHNEIDER ENGINEERING CORPORATION**  
PHELPS, WISCONSIN  
DRAFTED BY PETE MAHRE

**RESTRICTION:**  
NO BUILDINGS FOR ANIMAL HOUSING OR USE  
ADJACENT WELLS OR WELLS. WELLS SHALL  
BE LOCATED WITHIN 50 FEET OF  
THE ESTIMATED ABSORPTION AREA.

**LEGEND:**  
O - POINTS 20'-5' TO 10' FROM WELLS SHALL BE  
SET AS A MINIMUM POINT SET BY THE SURVEY.  
ALL DISTANCES MARKED TO THE NEAREST 1/8 FOOT.

**NOTE:**  
THIS PLAN MUST BE RECORDED WITHIN 90 DAYS OF  
THE DATE OF THE LAST OF THE PLAN AND  
MAY BE SUBJECT TO THE PLAN APPROVAL.

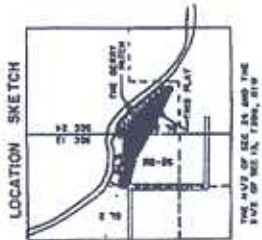

THE N-E 1/4 OF SEC. 24, AND THE  
S-E 1/4 OF SEC. 13, T39N, R11W