

FOR SALE: NORMAN COUNTY, MN FARM LAND

S 1/2 SW 1/4 Section 21-145-48

Approximately 74.37 Acres Near Halstad, MN



Driving Directions:

- ♦ From Halstad, MN take Highway 200 East 1.5 miles to 130th Street
- ♦ You are now at the SW corner of the property

- Total Acres: 74.37
- Tillable Acres: 72.00
- Weighted Average Productivity: 88.4%
- 2011 R. E. Taxes: \$995.12



Steve Johnson
Realtor
701-799-5213
steve@prglandsales.com



4265 45th Street South - Suite 200
Fargo, North Dakota 58104
www.propertyresourcesgroup.com

FOR SALE: NORMAN COUNTY, MN FARM LAND

S 1/2 SW 1/4 Section 21-145-48

Approximately 74.37 Acres Near Halstad, MN

Soils Map

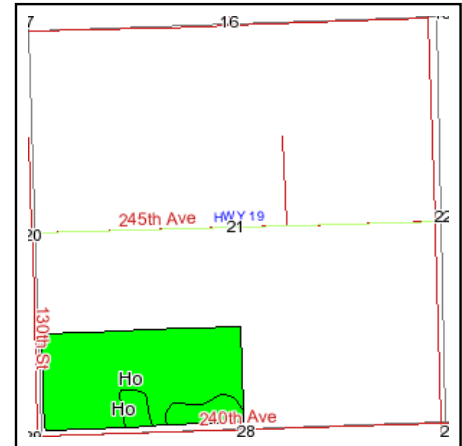
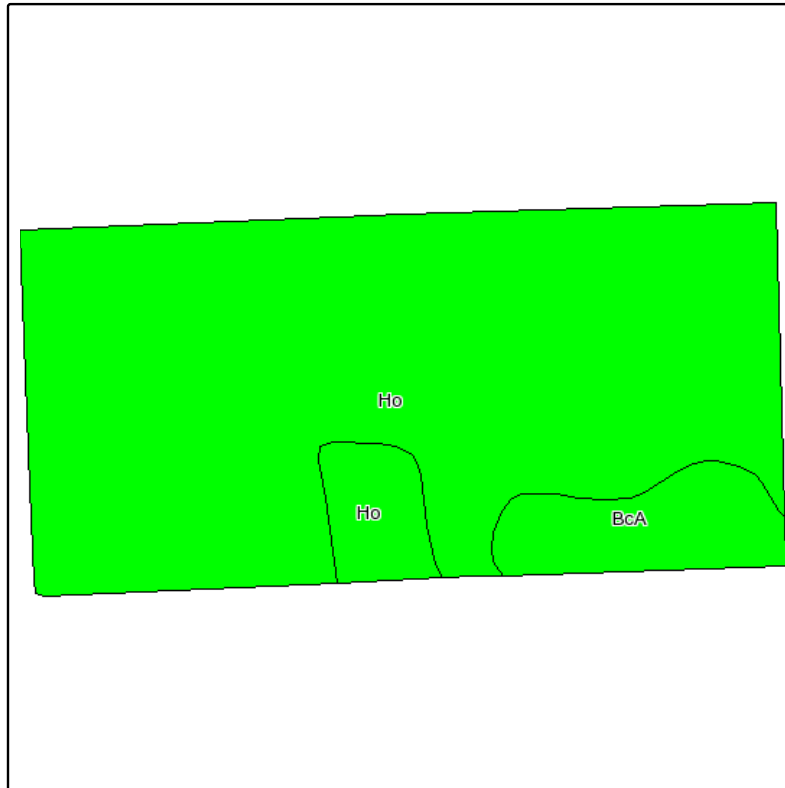

State: **Minnesota**
 County: **Norman**
 Location: **021-145N-048W**
 Township: **Halstad**
 Acres: **75.7**

Fsa borders provided by the Farm Service Agency as of May 23, 2008.
 Soils data provided by USDA and NRCS.



Code	Soil Description	Acres	Percent of field	Non-Irr Class Legend	Non-Irr Class	Productivity Index	Alfalfa hay	Barley	Brome grass alfalfa	Brome grass alfalfa hay	Corn	Corn silage	Kentucky bluegrass
Ho	Hegne-Fargo silty clays	69.1	91.2%		Ilw	88	4.8	100	5.5	4.2	121	14	3.6
BcA	Bearden silty clay loam, 0 to 2 percent slopes	6.6	8.8%		IlS	93	5	110	5.6	4.4	128	15	3.7
Weighted Average						88.4	4.8	100.9	5.5	4.2	121.6	14.1	3.6



Steve Johnson
 Realtor
 701-799-5213
steve@prglandsales.com



4265 45th Street South - Suite 200
 Fargo, North Dakota 58104
www.propertyresourcesgroup.com