

Soils Map

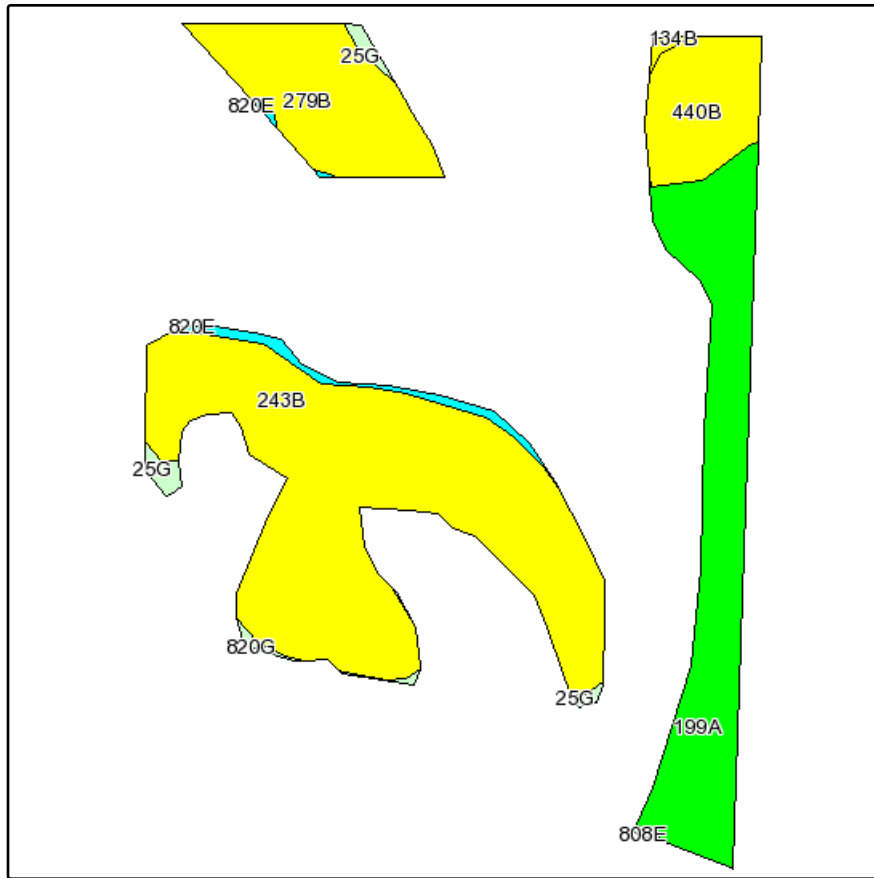

Fsa borders provided by the Farm Service Agency as of May 23, 2008.
Soils data provided by USDA and NRCS.
PLSS provided by Illinois State Geological Survey.

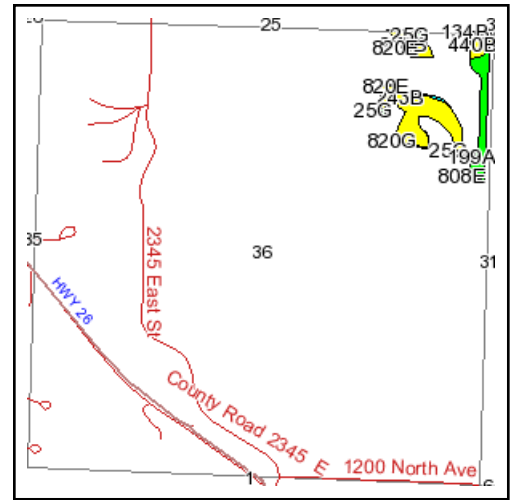

State: **Illinois**
County: **Bureau**
Location: **036-016N-009E**
Township: **Princeton**
Acres: **16.4**
Date: **10/12/2011**



**Capital
Agricultural
Property
Services, Inc.**

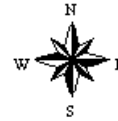

Maps provided by:



©AgriData, Inc 2008
www.AgriDataInc.com

Code	Soil Description	Acres	Percent of field	Il. State Productivity Index Legend	Corn Bu/A	Soybeans Bu/A	Wheat Bu/A	Crop productivity index for optimum management
**243B	St. Charles silt loam, 2 to 5 percent slopes	7.9	48.2%		**166	**51	**64	**121
199A	Plano silt loam, 0 to 2 percent slopes	4.1	24.9%		194	60	74	142
**279B	Rozetta silt loam, 2 to 5 percent slopes	2.3	13.9%		**162	**50	**64	**119
**440B	Jasper silt loam, 2 to 5 percent slopes	1.5	8.9%		**173	**56	**70	**129
**820E	Hennepin-Casco complex, 12 to 30 percent slopes	0.3	1.8%		**98	**33	**37	**73
**25G	Hennepin loam, 35 to 70 percent slopes	0.2	1.3%		**54	**18	**19	**41
**820G	Hennepin-Casco complex, 30 to 60 percent slopes	0.1	0.4%		**57	**19	**22	**43
Weighted Average					168.9	52.4	65.4	123.7

Table: Optimum Crop Productivity Ratings for Illinois Soil by K.R. Olson and J.M. Lang, Office of Research, ACES, University of Illinois at Champaign-Urbana. Version: 1/15/2011 Amended Table S2 B811 (Updated 3/1/2011)

Crop yields and productivity indices for optimum management (B811) are maintained at the following NRES web site: <http://soilproductivity.nres.illinois.edu/>

** Indexes adjusted for slope and erosion according to Bulletin 811 Table S3