

T. 32 S., R. 8 E., W.M.

Williamson Riv. Wells.

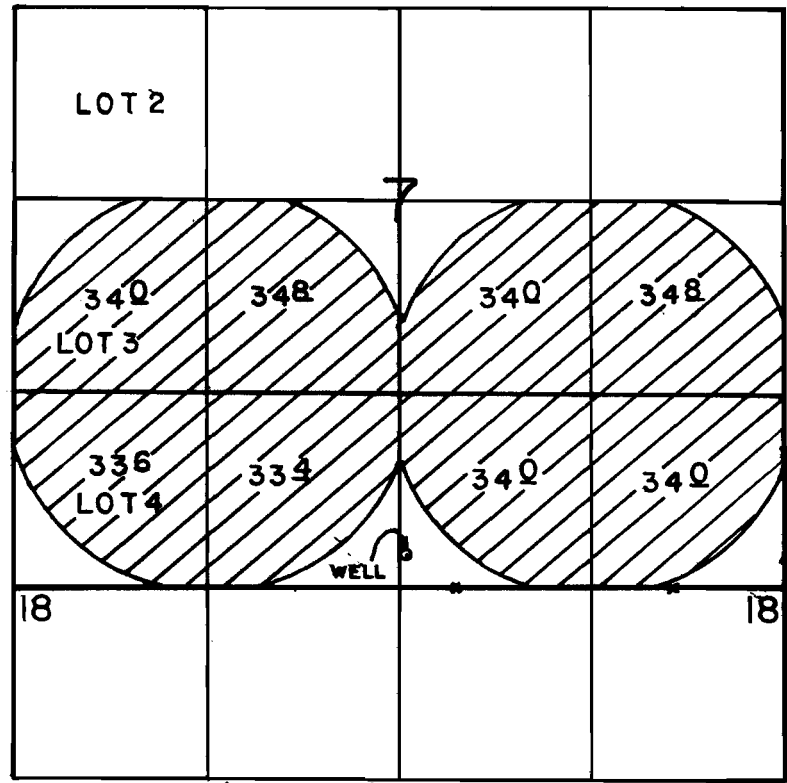

WELL LOC: 210' N & 2600' W FROM SE COR. OF SEC 7.

SCALE: 1" = 1320'

FINAL PROOF SURVEY

UNDER

Application No. G-8183 Permit No. G-7710
IN NAME OF

JAMES L. CHAPMAN

Surveyed JUNE 18, 1991, by B.W.BISHOP