

Topography Map

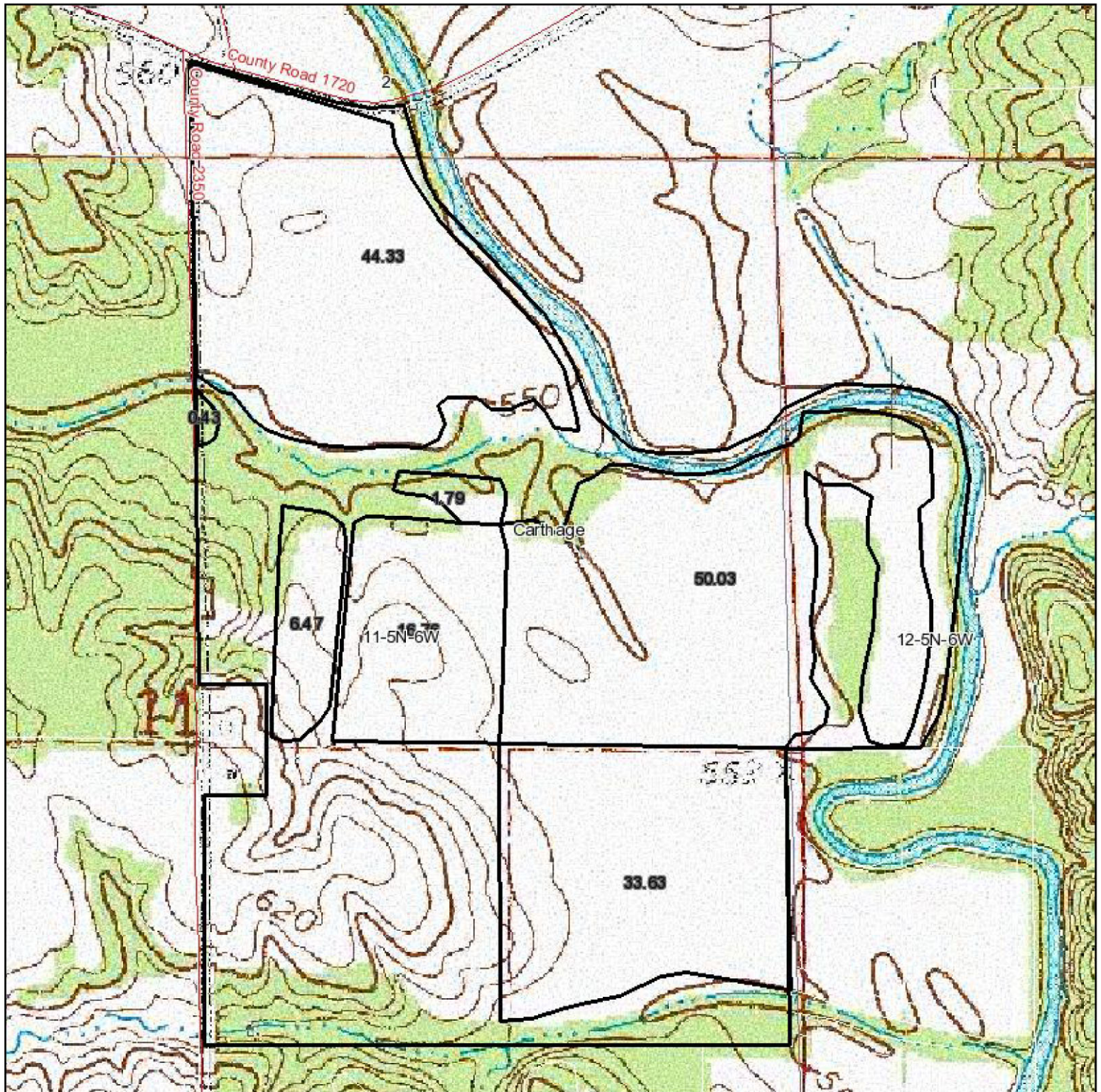

Capital
Agricultural
Property
Services, Inc.

Maps provided by:



©AgriData, Inc. 2011

www.AgriDataInc.com

11-5N-6W
Hancock County
Illinois

map center: 40° 26' 21.73, 91° 2' 50.69

scale: 8610

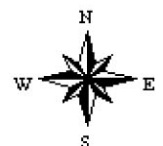

7/25/2011

Field borders provided by Farm Service Agency as of 5/21/2008. Aerial photography provided by Aerial Photography Field Office. PLSS provided