

NOTICE OF LAND SALE
Riverbank Tract - Listing #4268
Pt. Sec. 20 & 21, T6S, R23W, Pike County, Arkansas
containing 60 acres, more or less

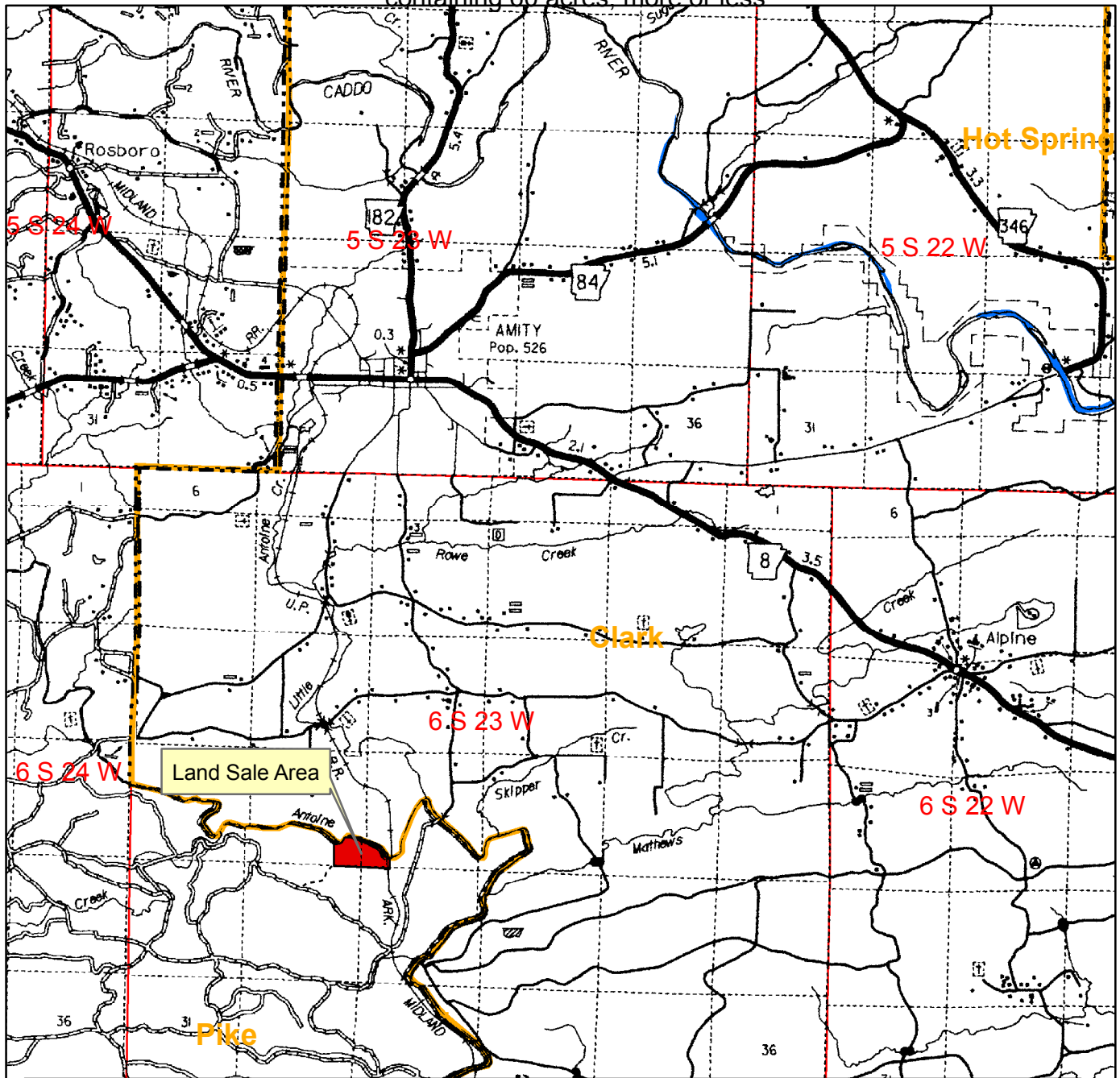

Driving Directions

From Alpine, turn on Center Ridge Road (west) and drive 4.6 miles. Turn left (south) on Antoine River Road and drive 2.5 miles, crossing Antoine River. Turn right (northwest) on Bare Rock Road and drive 1.0 mile. Turn right (northeast) at pink KFS flags and follow blue flags along woods road for .3 mile to southwest corner of tract.



Created: June, 2011
Drawn By: JDT