

Property Maps & Information

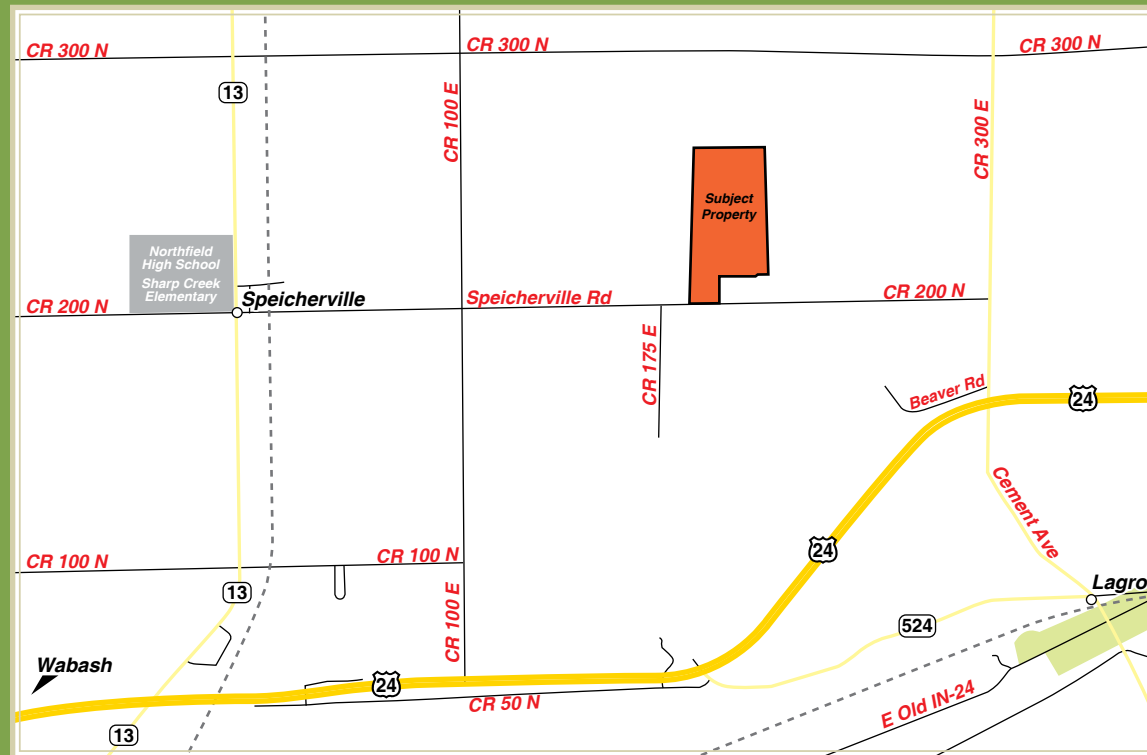

LOCATION:
2010 E 200 N
Wabash, IN 46992
Approximately 4 miles
northeast of Wabash, on
the north side of CR 200 N
(Speicherville Rd) and
2 miles east of SR 13.

HALDERMAN
REAL ESTATE
SERVICES

PO Box 297 • Wabash, IN 46992

**“Farm & Transitional Real Estate
Specialists Since 1930”**

800.424.2324
www.halderman.com

Jon Rosen

North Manchester, IN
260.740.1846
jonr@halderman.com

Bill Earle

North Manchester, IN
260.982.8351
bille@halderman.com

Martha Pence

Wabash, IN
260.563.8888
marthap@halderman.com

HALDERMAN
REAL ESTATE
SERVICES
HLS# JRR-10564
800.424.2324 | www.halderman.com

Welcome Home



5,156 sq. ft. Home

2010 E 200 N • Wabash, IN 46992 | Lagro Township, Wabash County, IN

*73[±] Acres 9.8[±] Acre Homesite 2.9[±] Acre Pond
27.3[±] Tillable 10.6[±] Woods 22.4[±] CRP Trees*



Jon Rosen

North Manchester, IN
260.740.1846
jonr@halderman.com

Bill Earle

North Manchester, IN
260.982.8351
bille@halderman.com

Martha Pence

Wabash, IN
260.563.8888
marthap@halderman.com

HALDERMAN
REAL ESTATE
SERVICES
HLS# JRR-10564
800.424.2324 | www.halderman.com

Welcome Home



5,156 sq. ft. Home

Lagro Township, Wabash County, IN | 2010 E 200 N • Wabash, IN 46992

*73[±] Acres 9.8[±] Acre Homesite 2.9[±] Acre Pond
27.3[±] Tillable 10.6[±] Woods 22.4[±] CRP Trees*

TOPOGRAPHY: Gently Rolling

ZONING: Agricultural

SCHOOL DISTRICT: MSD of Wabash County
Sharp Creek Elementary School & Northfield Jr/Sr High School

ANNUAL TAXES: \$1,588.52 (2010 due & payable in 2011)

CRP: Contract 10/1/1998 - 9/30/2013

15-year annual payments of \$1,847, not certified forest

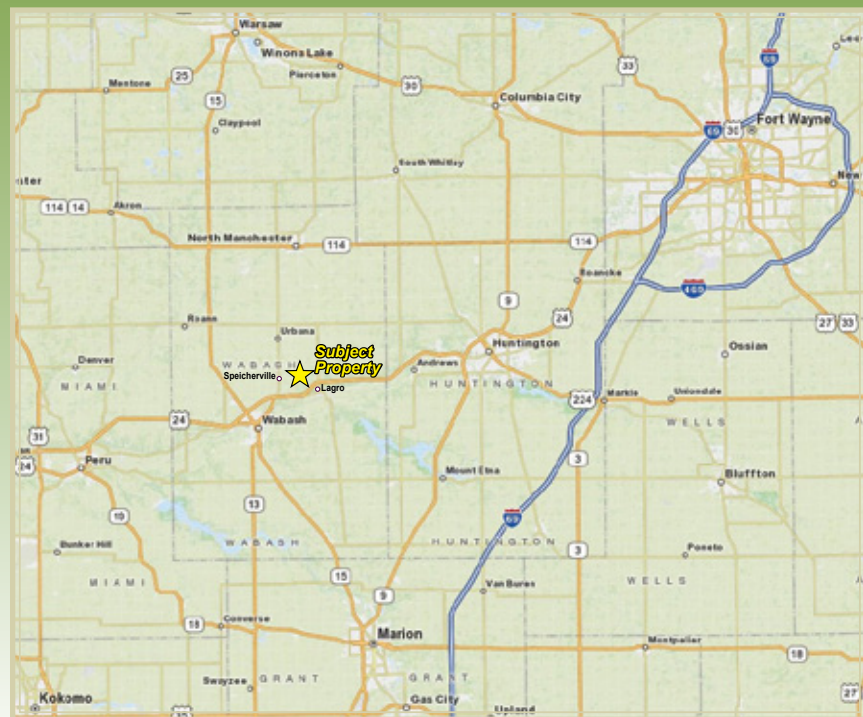

Your private, country retreat awaits . . .

Call to schedule a private showing of the home.
Visual Tour is available at www.halderman.com

HALDERMAN
REAL ESTATE
SERVICES

 **Richard Halderman, Broker**
800.424.2324 | www.halderman.com

DESCRIPTION OF HOME:

Exquisite, two-level brick home with 5,156 sq. ft. of living area and walk-out lower level. Open concept between living room, kitchen and dining area. Gourmet kitchen with Corian countertops, built-in appliances, baking center, double-ovens, wet bar with ice maker and small refrigerator. Spacious living room showcasing a beautiful, stone fireplace. Dining area with ample seating, perfect for entertaining. Three bedrooms, spacious walk-in closets, three full baths and two half baths. This professionally planned and designed residence, built in 2000, features a tornado shelter, two open loop geothermal units, circulator for the hot water system, two utility rooms, lower level walk-out, speaker and alarm systems, two separate 2-car attached garages with attics, in addition to ample storage areas.

This immaculate property affords a tranquil setting amid approximately 73 acres of tillable land, woods and CRP trees. A paved drive leads to this secluded estate overlooking a pond; offering country living at its finest! Conveniently located near Wabash, IN, approximately two miles from Sharp Creek Elementary and Northfield Jr-Sr High School. This property is also in close proximity to Fort Wayne and Warsaw.

Main Level: 2,621 sq ft Lower Level: 2,535 sq ft TOTAL: 5,156 sq ft

Garages: 23' x 16' and 23', 8 1/2" x 29', 6"

