

SKETCH ADDENDUM

Borrower or Owner

Property Address HOUSE TO BE MOVED-Cottontail

City County

State

Zip Code

Client

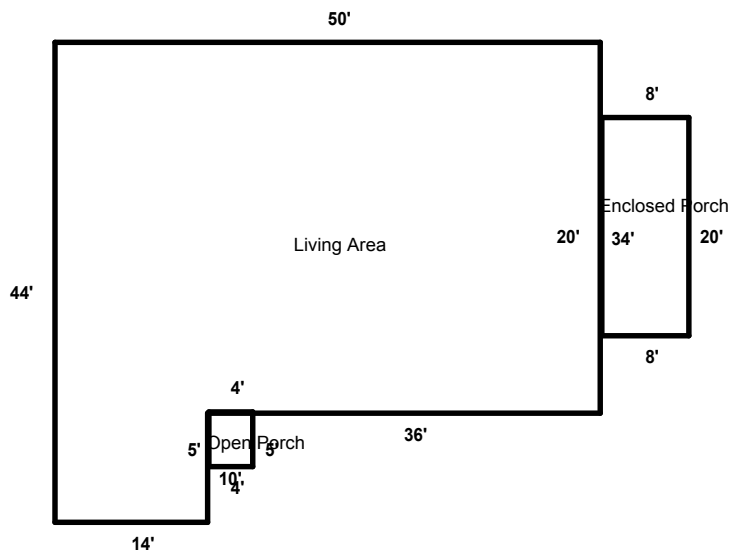

SUMMARY	SQ FT AREA	PERIMETER	AREA CALCULATION DETAILS			
Living Area			First Floor			
First Floor	1840	188	50.0 X 34.0 =	1700.0		
			14.0 X 10.0 =	140.0		
			Total	1840.0		
Porches/Patios						
Open Porch	20	18				
Porch	160	56				

Market Realty, Inc. / Roger D. Chambers

Roger Chambers

SKETCH-IT 1-800-623-0872