

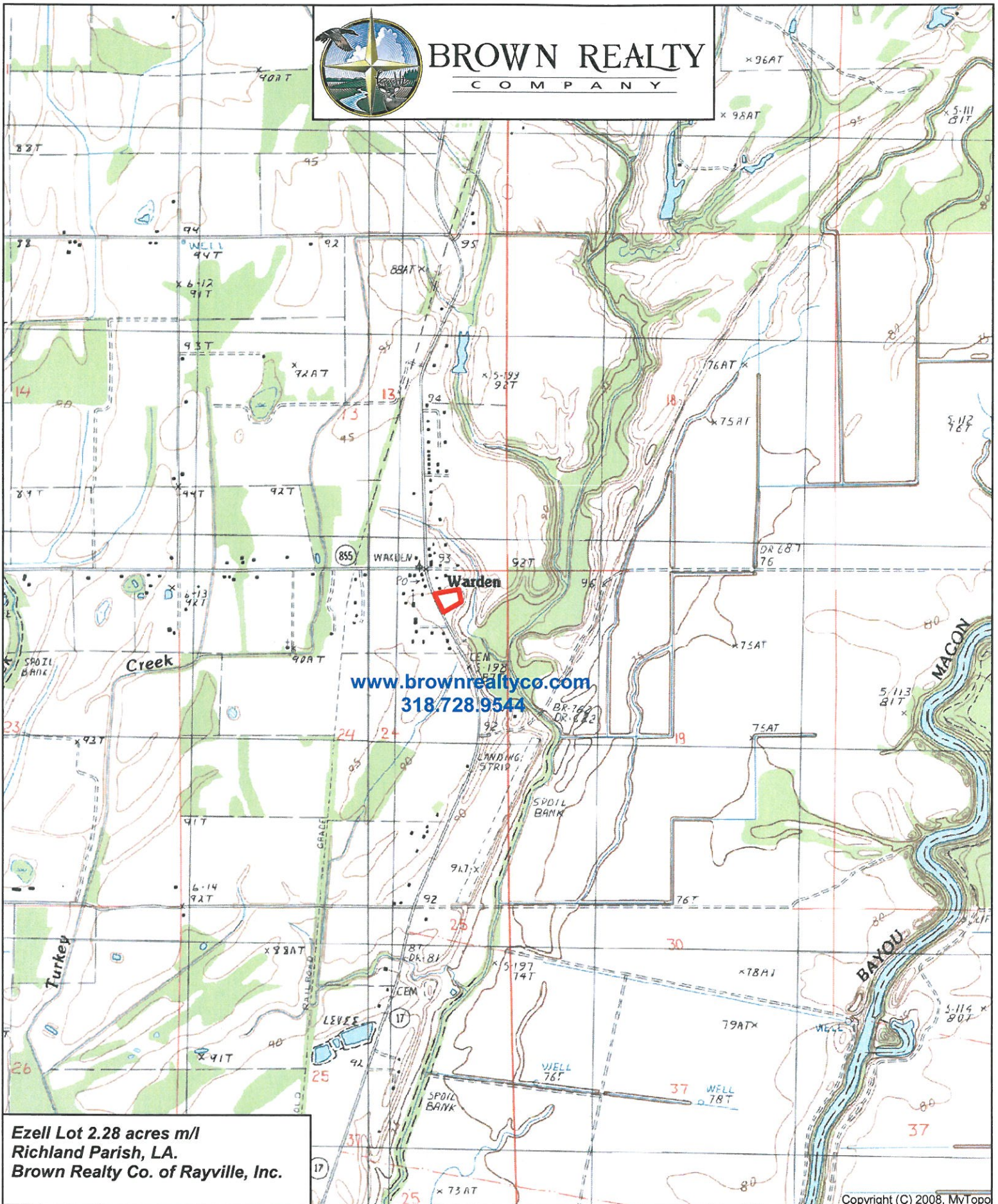

BROWN REALTY
COMPANY



**Ezell Lot 2.28 acres m/l
Richland Parish, LA.
Brown Realty Co. of Rayville, Inc.**

Copyright (C) 2008, MyTopo

Name: EPPS,
Date: 03/18/11
Scale: 1 inch = 2,000 ft.

Location: 032° 32' 10.21" N 091° 29' 35.74" W

Copyright (C) 2008, MyTopo

This information is believed to be accurate but not guaranteed. Interested parties should verify all information to their satisfaction.