

LAND FOR SALE

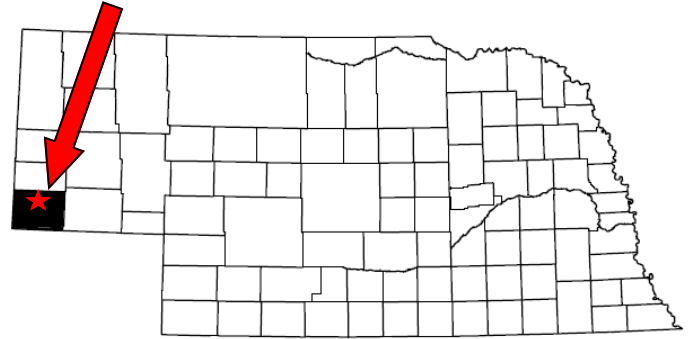

Hatton CRP Farm



- Location:** 7 miles north of Kimball, Nebraska on Hwy. 71 to CR 48, then east 3 miles, then 1/2 mile north on trail road to the southeast corner of the property.
- Legal Description:** NE1/4 Section 22 - T16N - R55W of the 6th P.M., Kimball County, Nebraska.
- Acres:** 142 tax assessed acres.
- Taxes:** \$523.06 for 2009.
- Land Use:** 142.2 acres enrolled in USDA Conservation Reserve Program (CRP). 104.3 acres with annual payment of \$3,186, expiring September 30, 2014. 37.9 acres with annual payment of \$1,037, expiring September 30, 2020.
- Soils:** 21% Class III Albinas-Cheyenne loams and Altvan fine sandy loam, 78.6% Class V Altvan-Eckley complex.
- Price:** \$60,000
- Comments:** This property has potential for a good return on your investment.
- Contact:** Jerry Sloan, Listing Agent—308-631-5520—jsloan@agriaffiliates.com
Roger Luehrs—308-631-2506, Mike Polk, Loren Johnson, Bruce Dodson, Jerry Weaver, Duane McClain at 308-534-9240.

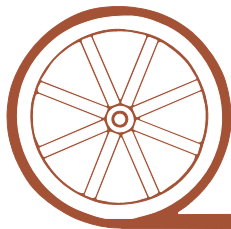

Offered Exclusively By:

AGRI AFFILIATES, INC.

...Providing Farm - Ranch Real Estate Services...

GERING OFFICE

P.O. Box 512
1915 10th Street
Gering, NE 69341

www.agriaffiliates.com

(308) 633-5505

Fax (308) 633-5507

NORTH PLATTE OFFICE

(308) 534-9240

Information contained herein was obtained from sources deemed reliable. We have no reason to doubt the accuracy, but we do not guarantee it. Prospective Buyers should verify all information, including items of income and expense. All maps provided by Agri Affiliates, Inc. are approximations only, to be used as a general guideline, and not intended as survey accurate.

Code	Soil Description	Acres	Percent of field	Non-Irr Class Legend	Non-Irr Class	Irr Class	SRPG	Barley	Millet	Oats	Winter wheat
1508	Altvan-Eckley complex, 3 to 9 percent slopes	111.8	78.6%		Vs	IVe	35	14	10	15	14
5800	Albinas-Cheyenne loams, rarely flooded	21.3	15.0%		IIIc	IIIs	48				
1500	Altvan fine sandy loam, 1 to 3 percent slopes	8.6	6.1%		IIIe	IIle	44				
6041	Tassel-Blanche sandy loams, 3 to 9 percent slopes	0.3	0.2%		Vle	IVe	16				
6032	Tassel-Blanche complex, 9 to 30 percent slopes	0.2	0.2%		Vle		14				
Weighted Average							37.5	11	7.9	11.8	11

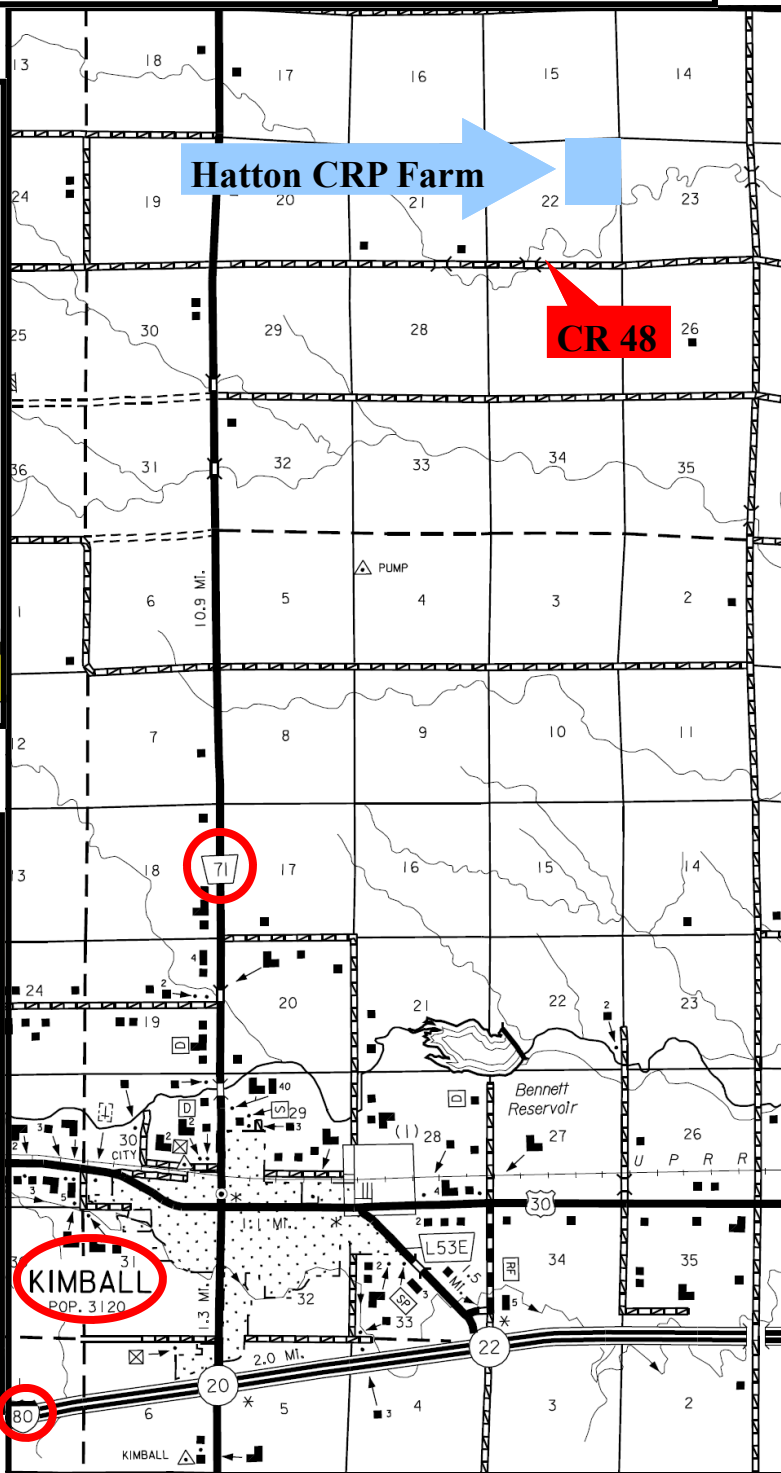
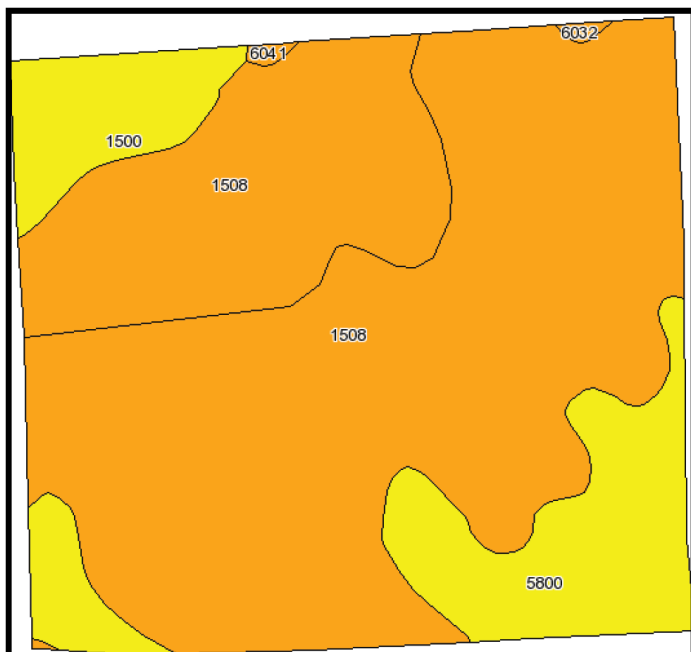

All maps provided by Agri Affiliates, Inc. are approximations only, to be used as a general guideline, and not intended as survey accurate.

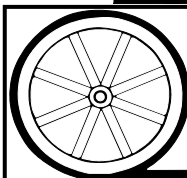

AGRI AFFILIATES, INC.

...Providing Farm - Ranch Real Estate Services...