

LAND FOR SALE
Caledonia Tract +/-45 Acres
Sec. 32, T19S, R15W
Union County, AR

Listing #
1127

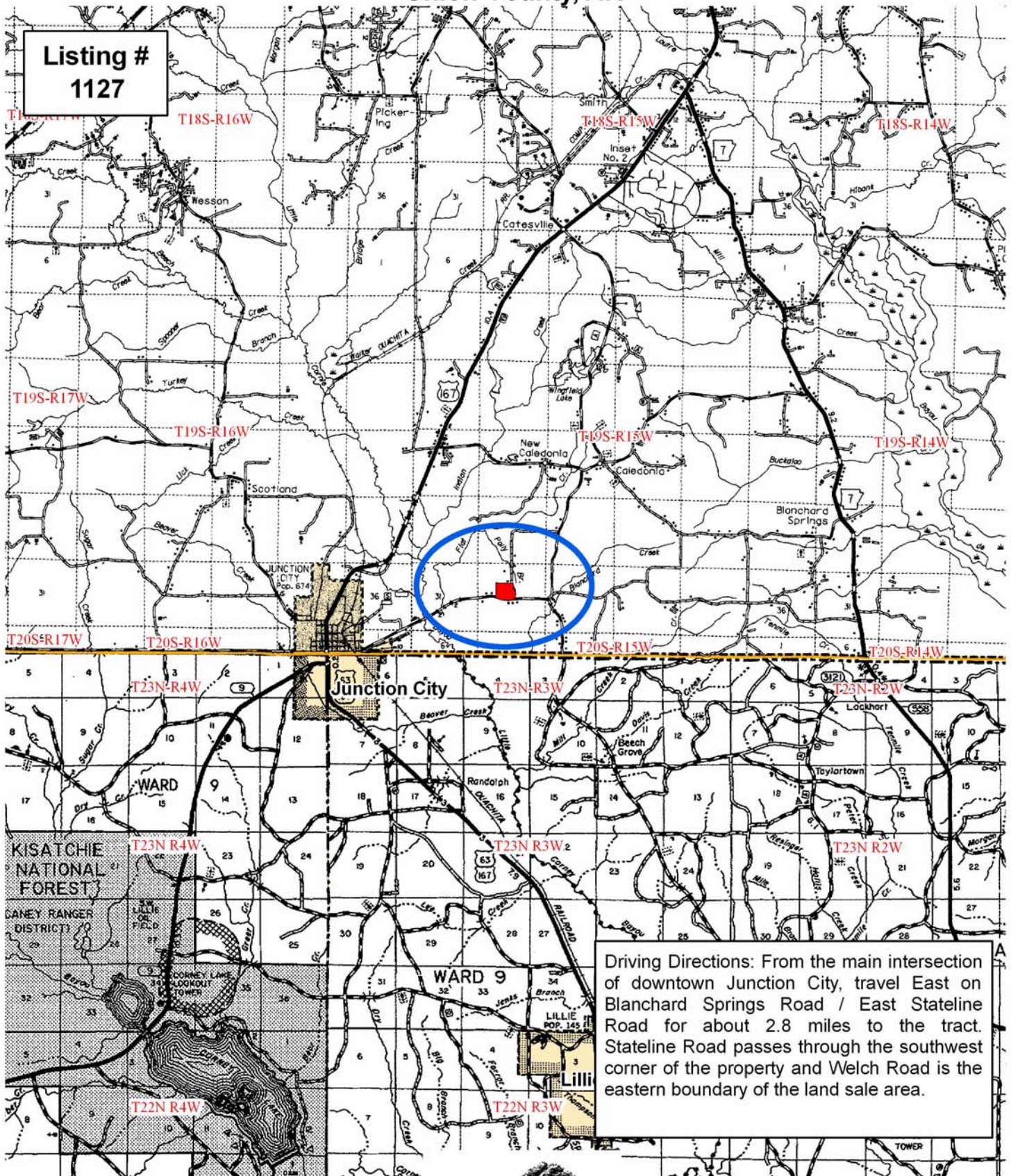

Driving Directions: From the main intersection of downtown Junction City, travel East on Blanchard Springs Road / East Stateline Road for about 2.8 miles to the tract. Stateline Road passes through the southwest corner of the property and Welch Road is the eastern boundary of the land sale area.