

Soils Map

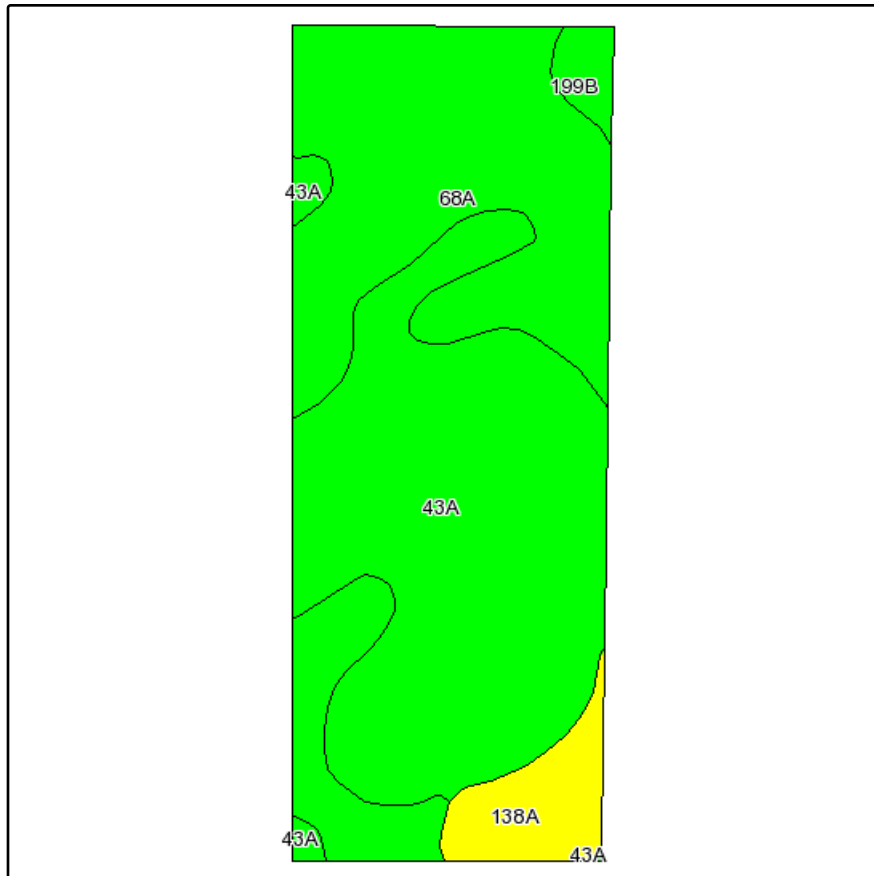

Fsa borders provided by the Farm Service Agency as of May 23, 2008.
Soils data provided by USDA and NRCS.
PLSS provided by Illinois State Geological Survey.

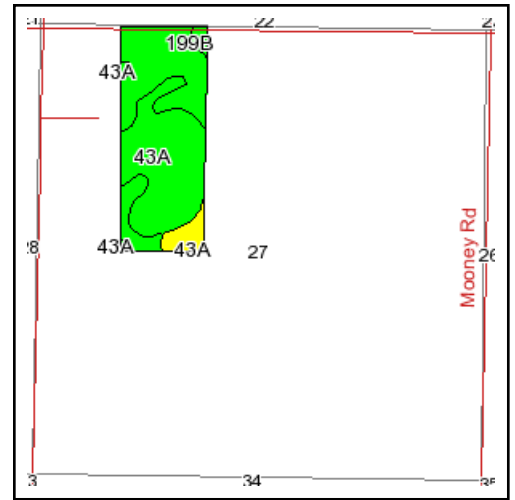

State: **Illinois**
County: **Macon**
Location: **027-017N-001W**
Township: **Niantic**
Acres: **59.7**
Date: **8/5/2010**



Maps provided by:



Code	Soil Description	Acres	Percent of field	Il. State Productivity Index Legend	Subsoil rooting ^a	Corn Bu/A	Soybeans Bu/A	Wheat Bu/A	Crop productivity index for optimum management
43A	Ipava silt loam, 0 to 2 percent slopes	30.1	50.4%		FAV	172	56	69	142
68A	Sable silty clay loam, 0 to 2 percent slopes	24.6	41.3%		FAV	173	57	67	143
138A	Shiloh silty clay loam, 0 to 2 percent slopes	3.8	6.3%		FAV	158	52	62	130
**199B	Plano silt loam, 2 to 5 percent slopes	1.2	1.9%		FAV	**173	**53	**66	**141
Weighted Average						171.4	56	67.6	141.5

Table: Optimum Crop Productivity Ratings for Illinois Soil by K.R. Olson and J.M. Lang, Office of Research, ACES, University of Illinois at Champaign-Urbana. Version: 12/21/2007 table S2rev B811

Crop yields and productivity indices for optimum management (B811) are maintained at the following NRES web site: <http://www.nres.uiuc.edu/soilproductivity>

** Indexes adjusted for slope and erosion according to Bulletin 811 Table S3

^a UNF = unfavorable; FAV = favorable