

# Soils Map

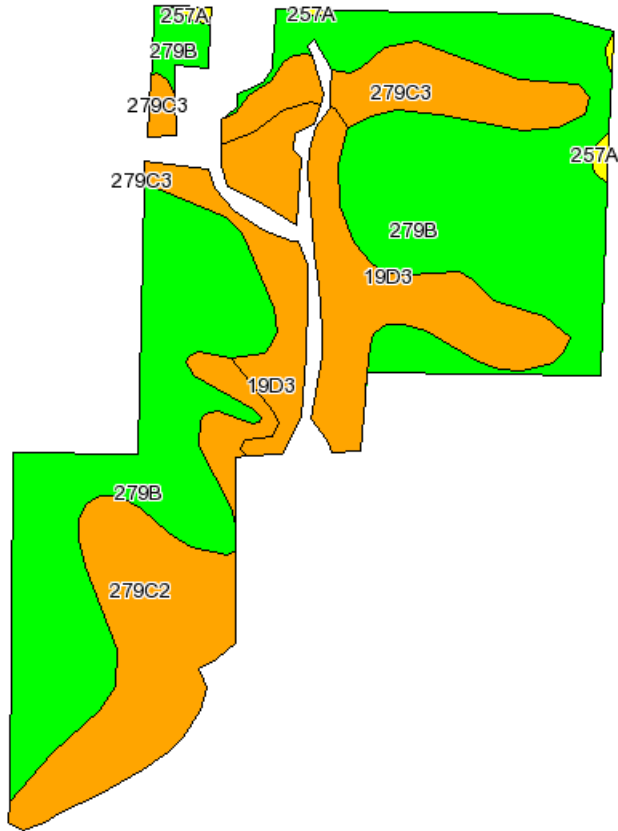

Fsa borders provided by the Farm Service Agency as of May 23, 2008.  
 Soils data provided by USDA and NRCS.  
 PLSS provided by Illinois State Geological Survey.

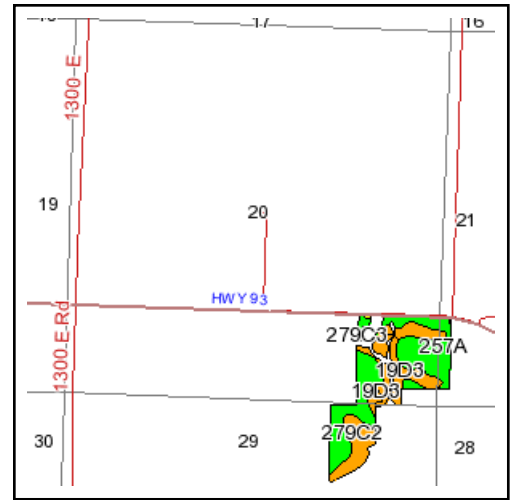

State: **Illinois**  
 County: **Stark**  
 Location: **020-014N-007E**  
 Township: **Osceola**  
 Acres: **45.2**  
 Date: **7/21/2010**



Capital  
 Agricultural  
 Property  
 Services, Inc.

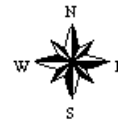

Maps provided by:



©AgriData, Inc 2008  
 www.AgriDataInc.com

Code	Soil Description	Acres	Percent of field	Non-Irr Class Legend	Non-Irr Class	Corn	Oats	Soybeans
279B	Rozetta silt loam, 2 to 5 percent slopes	25.1	55.7%		Ile	147	75	46
19D3	Sylvan silty clay loam, 10 to 18 percent slopes, severely eroded	8.5	18.7%		IVe	107	50	35
279C2	Rozetta silt loam, 5 to 10 percent slopes, eroded	7.6	16.7%		IIle	138	71	43
279C3	Rozetta silty clay loam, 5 to 10 percent slopes, severely eroded	3.7	8.2%		IVe	127	65	40
257A	Clarksdale silt loam, 0 to 2 percent slopes	0.3	0.6%		I	157	80	50
Weighted Average						136.3	68.8	42.9