

LAND FOR SALE

Scotts Bluff County Hilltop Home Site



- Location:** 12 miles east of Scottsbluff, NE on Hwy. 26, then 3 miles north on CR 35 and 1 1/2 miles east on CR L.
- Legal Description:** A Tract of Land in the SE1/4 of Section 20, T22N-R52W of the 6th P.M., Scotts Bluff County, Nebraska.
- Acres:** 25 Tax Assessed Acres.
- Taxes:** \$98.98 taxes for 2009.
- Land Use:** 25 Acre country home site on a hill. Panoramic views of the Platte Valley. Pasture grass, fence and good road frontage with Electric lines. Easy commute to Scottsbluff or Alliance. In Scottsbluff school district.
- Price:** **\$34,900**
- Comments:** Owner financing available to qualified buyer.
- Contact:** **Roger D. Luehrs, D.V.M.-Listing Agent -308-631-2506**
roger@agriaffiliates.com, Jerry Sloan - 308-631-5520
Mike Polk, Loren Johnson, Bruce Dodson, Jerry Weaver,
Duane McClain at 308-534-9240.

Offered Exclusively By:

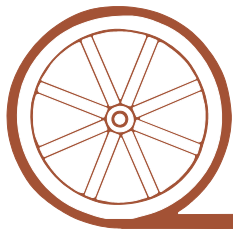

AGRI AFFILIATES, INC.

...Providing Farm - Ranch Real Estate Services...

GERING OFFICE

P.O. Box 512
1915 10th Street
Gering, NE 69341
www.agriaffiliates.com

(308) 633-5505

Fax (308) 633-5507

NORTH PLATTE OFFICE

(308) 534-9240

Information contained herein was obtained from sources deemed reliable. We have no reason to doubt the accuracy, but we do not guarantee it. Prospective Buyers should verify all information, including items of income and expense. All maps provided by Agri Affiliates, Inc. are approximations only, to be used as a general guideline, and not intended as survey accurate.

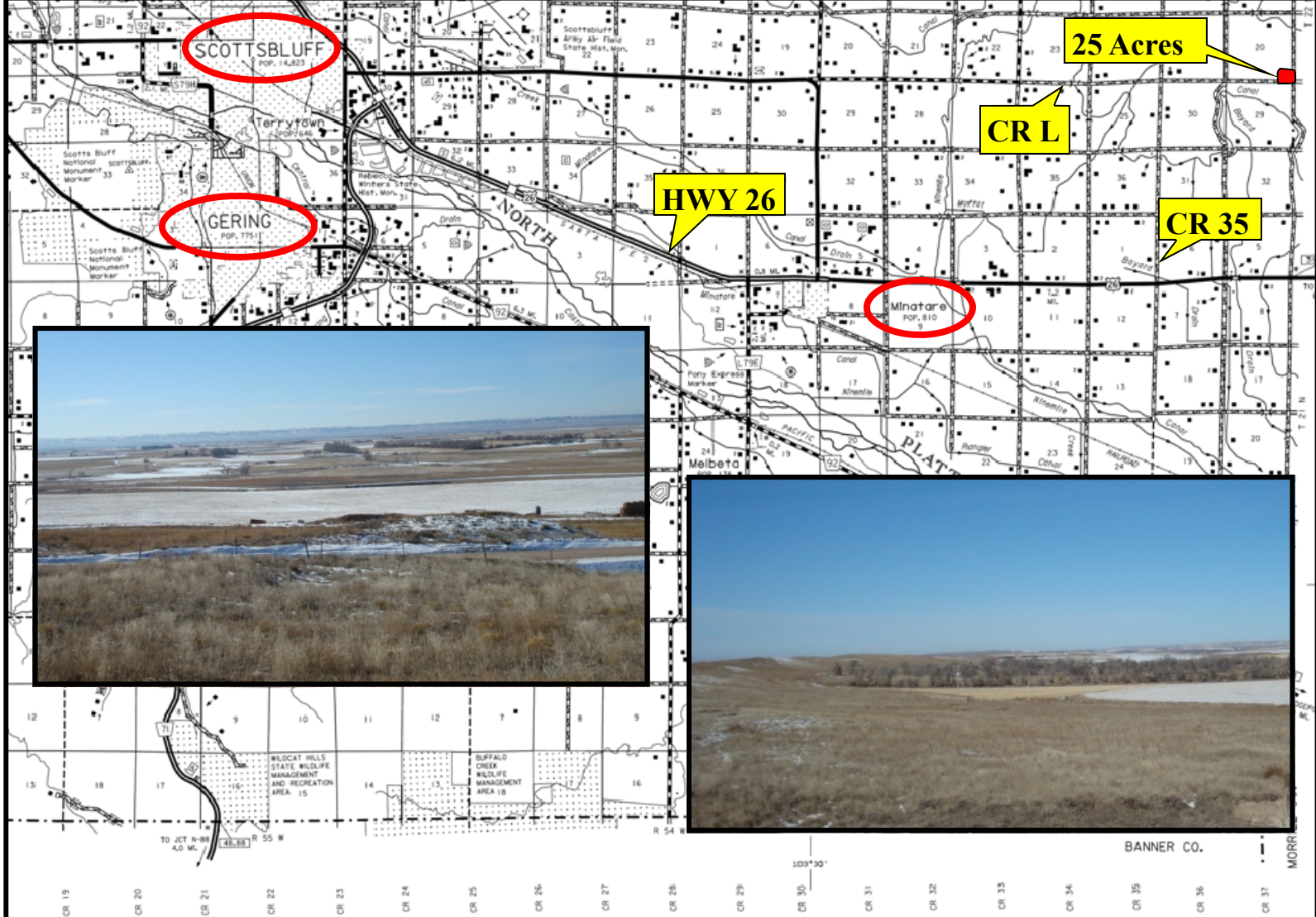

All maps provided by Agri Affiliates, Inc. are approximations only, to be used as a general guideline, and not intended as survey accurate.



AGRI AFFILIATES, INC.

...Providing Farm - Ranch Real Estate Services...