

# Topography Map

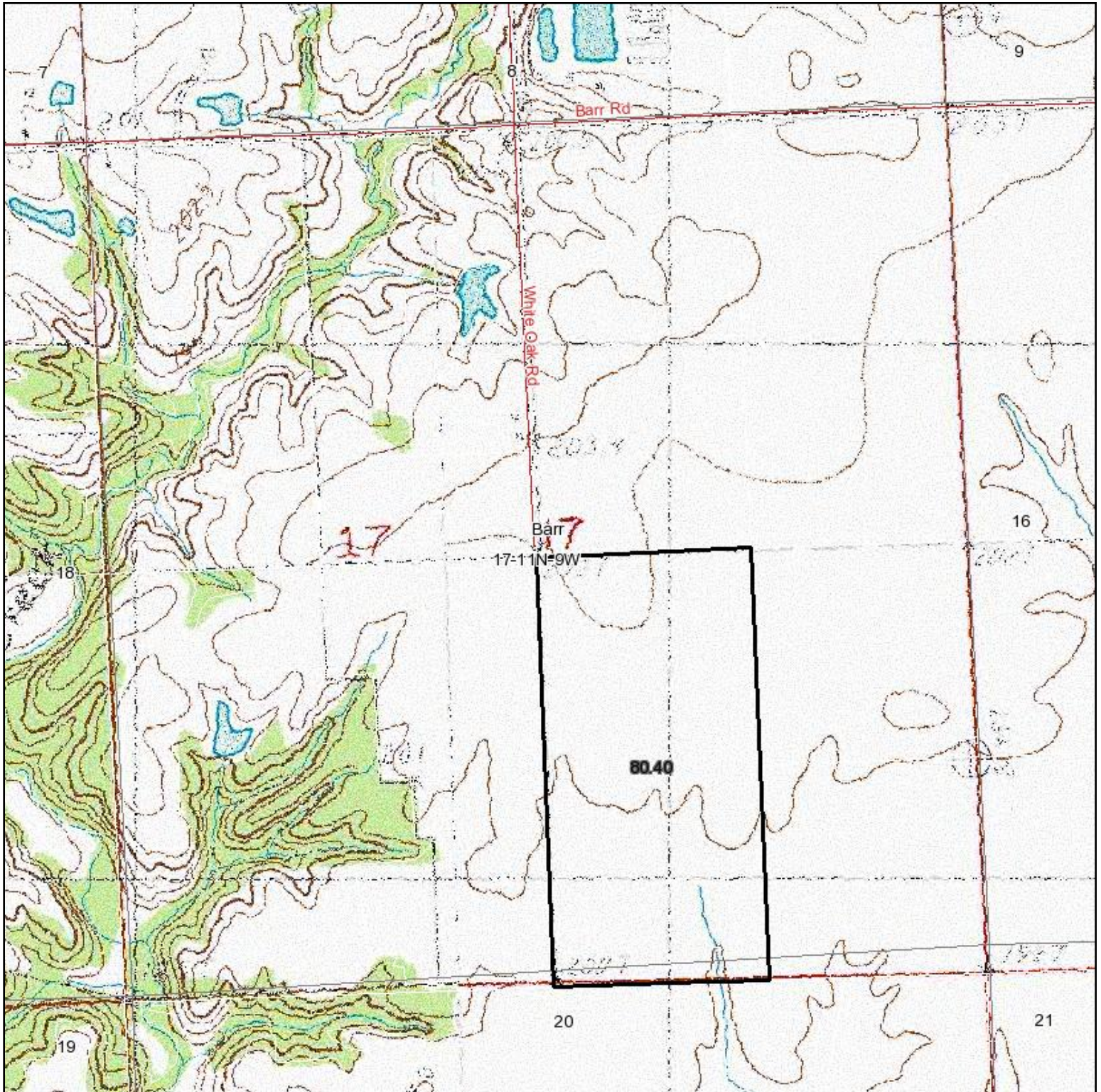

Capital  
Agricultural  
Property  
Services, Inc.

Maps provided by:



©AgriData, Inc. 2010

[www.AgriDataInc.com](http://www.AgriDataInc.com)

**17-11N-9W**  
**Macoupin County**  
**Illinois**

map center: 39° 23' 50.65, 90° 7' 22.24

scale: 11667



1/19/2010

Field borders provided by Farm Service Agency as of 5/23/2008. Aerial photography provided by Aerial Photography Field Office. PLSS provided