

Soils Map

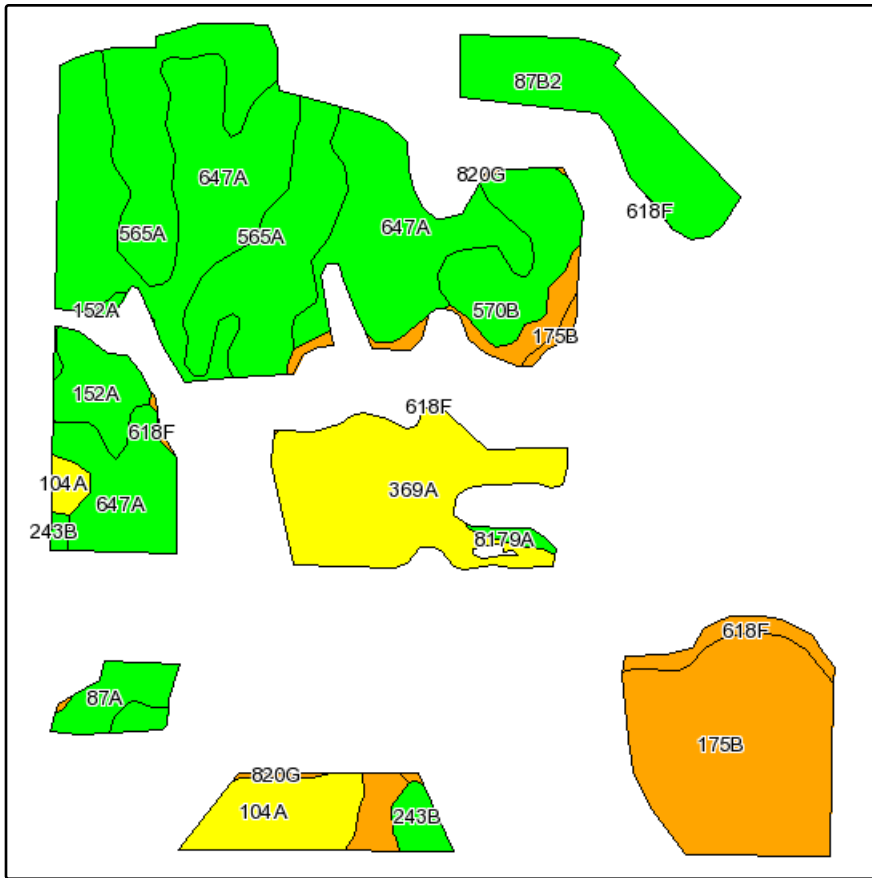

Fsa borders provided by the Farm Service Agency as of May 23, 2008.
Soils data provided by USDA and NRCS.
PLSS provided by Illinois State Geological Survey.

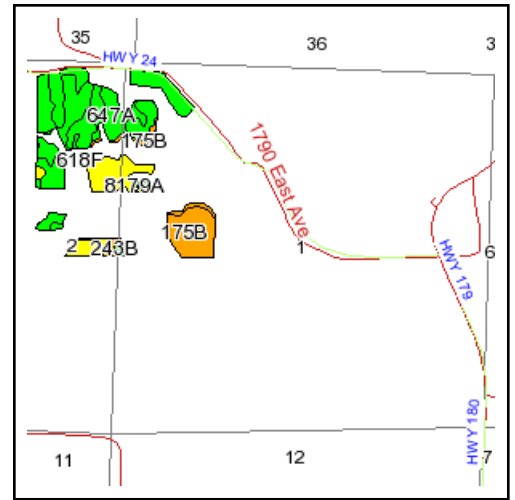

State: **Illinois**
County: **Bureau**
Location: **002-015N-008E**
Township: **Indiantown**
Acres: **71.9**
Date: **11/30/2009**



Capital
Agricultural
Property
Services, Inc.

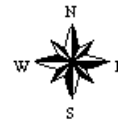

Maps provided by:



©AgriData, Inc 2008
www.AgriDataInc.com

Code	Soil Description	Acres	Percent of field	Non-Irr Class Legend	Non-Irr Class	Corn	Oats	Soybeans
647A	Lawler loam, 0 to 2 percent slopes	20.5	28.6%		Ils	141	69	47
175B	Lamont fine sandy loam, 2 to 5 percent slopes	10.8	15.0%		Ille	117	60	39
565A	Tell silt loam, 0 to 2 percent slopes	10.7	14.9%		Ils	137	69	45
369A	Waupecan silt loam, 0 to 2 percent slopes	8.5	11.8%		I	170	92	53
87B2	Dickinson sandy loam, 2 to 7 percent slopes, eroded	5.6	7.8%		Ile	122	64	40
570B	Martinsville silt loam, 2 to 5 percent slopes	3.8	5.3%		Ile	139	67	44
104A	Virgil silt loam, 0 to 2 percent slopes	3.5	4.8%		I	164	87	50
152A	Drummer silty clay loam, 0 to 2 percent slopes	2.1	2.9%		Ilw	175	90	57
87A	Dickinson sandy loam, 0 to 2 percent slopes	1.4	2.0%		Ils	128	67	42
618D2	Senachwine silt loam, 10 to 18 percent slopes, eroded	1.3	1.8%		IVe	119	57	39
618F	Senachwine silt loam, 18 to 35 percent slopes	1	1.5%		VIe			
243B	St. Charles silt loam, 2 to 5 percent slopes	1	1.3%		Ile	149	77	47
175D	Lamont fine sandy loam, 10 to 18 percent slopes	0.8	1.1%		VIe			
8179A	Minneiska loam, 0 to 2 percent slopes, occasionally flooded	0.7	0.9%		Ilw	125	52	42
820G	Hennepin-Casco complex, 30 to 60 percent slopes	0.2	0.3%		VIIe			
Weighted Average						135.9	69	44.3