

# Soils Map

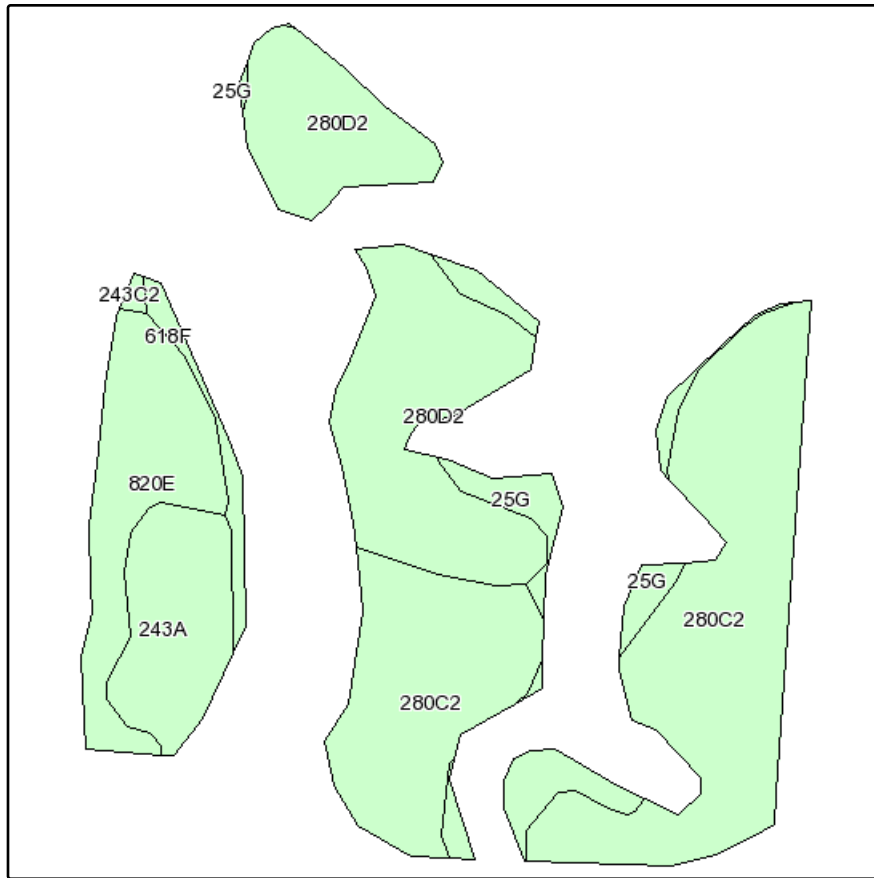

Fsa borders provided by the Farm Service Agency as of May 23, 2008.  
 Soils data provided by USDA and NRCS.  
 PLSS provided by Illinois State Geological Survey.

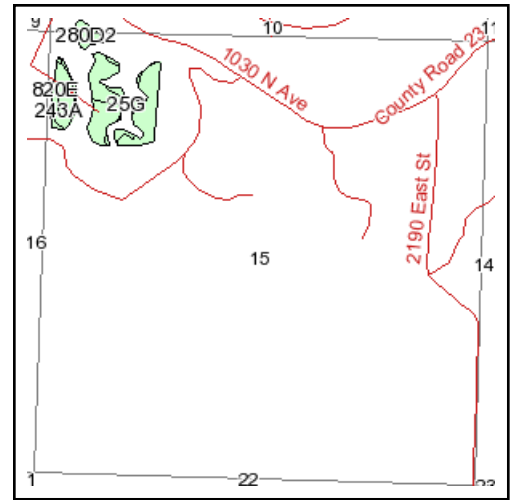

State: **Illinois**  
 County: **Bureau**  
 Location: **015-015N-009E**  
 Township: **Arispie**  
 Acres: **18.6**  
 Date: **9/4/2009**



**Capital  
 Agricultural  
 Property  
 Services, Inc.**

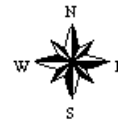

Maps provided by:



©AgriData, Inc 2008  
 www.AgriDataInc.com

Code	Soil Description	Acres	Percent of field	Non-Irr Class	Corn	Oats	Soybeans
280C2	Fayette silt loam, 5 to 10 percent slopes, eroded	8.2	43.5%	IIIe	140	72	44
280D2	Fayette silt loam, 10 to 18 percent slopes, eroded	4.8	26.1%	IIIe	131	67	41
820E	Hennepin-Casco complex, 12 to 30 percent slopes	2.1	11.5%	VIe			
243A	St. Charles silt loam, 0 to 2 percent slopes	1.7	9.2%	I	151	78	47
25G	Hennepin loam, 35 to 70 percent slopes	1.4	7.6%	VIIe			
618F	Senachwine silt loam, 18 to 35 percent slopes	0.4	1.9%	VIe			
<b>Weighted Average</b>					<b>109</b>	<b>56</b>	<b>34.2</b>