

# CALUMET LAKESHORE - PHASE I

AVAILABLE LOTS IN SEC 5, T56N-R33W,  
CALUMET TOWNSHIP, HOUGHTON COUNTY, MICHIGAN

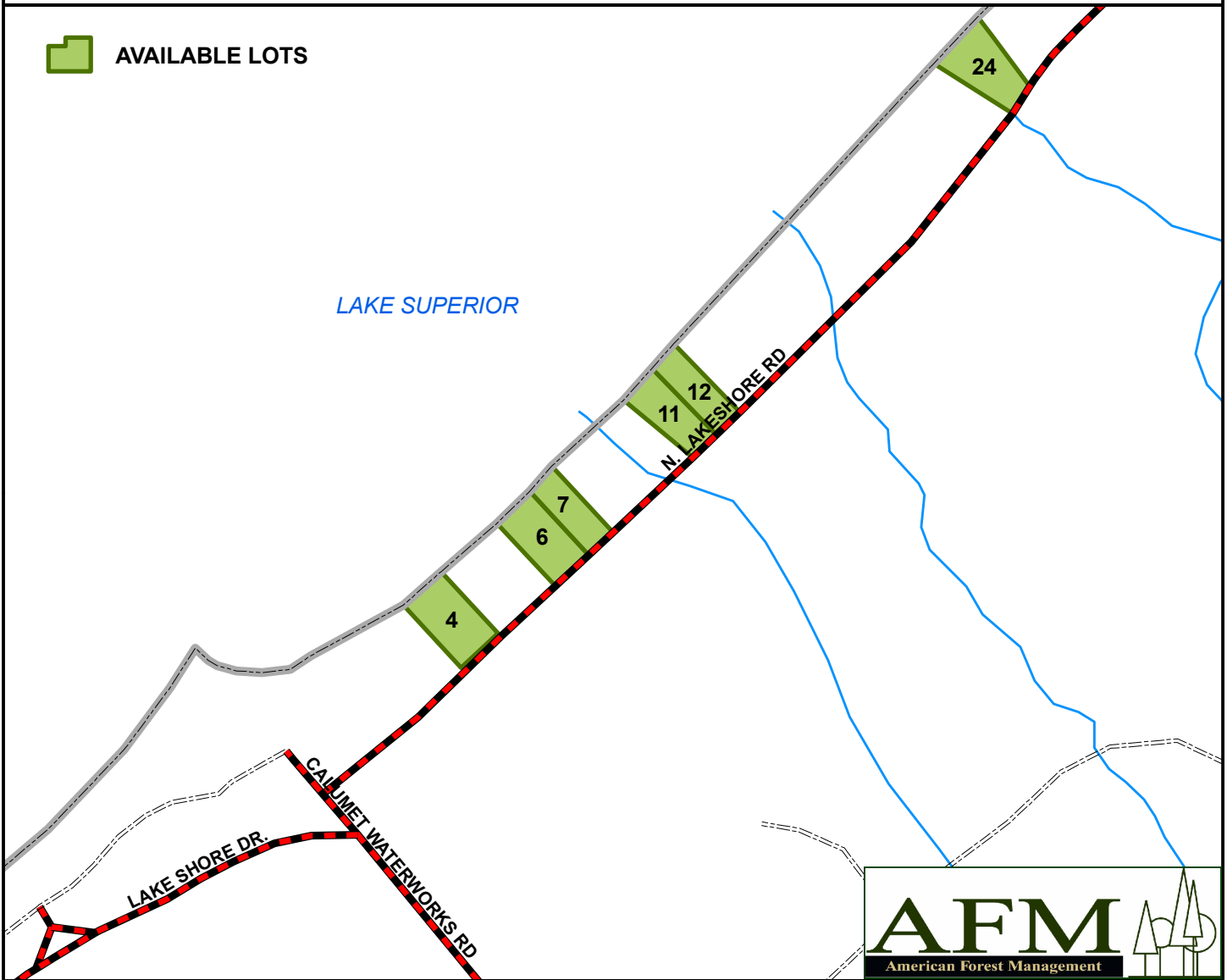

AVAILABLE LOTS



## LOT DETAILS

LOT NO	PRICE	LAKE FRONTAGE	ACREAGE
4	\$230,625	205	1.62
6	\$212,625	186	1.49
7	\$187,000	136	1.12
11	\$246,125	179	1.44
12	\$184,250	133	1.17
24	\$309,375	225	1.55

<b>IMPROVEMENT/MISC:</b> Vacant Land	<b>TIMBER GROWTH:</b> Mixture
<b>TELEPHONE:</b> Yes	<b>CITY WATER:</b> Yes
<b>CITY SEWER:</b> No	<b>WELL:</b> N/A
<b>SEPTIC:</b> No-must be installed	<b>ELEC SERV AVAILABLE:</b> Yes
<b>TYPE OF STREET:</b> Paved County Road	<b>SCHOOL SYSTEM:</b> Calumet
<b>RESTRICTIONS:</b> Residential use only	

Trina L. Anderson, Real Estate Associate Broker  
45815 Highway M-26  
Atlantic Mine, MI 49905  
906-483-0820 Ext 10, Fax: 906-483-0862

[www.afmrealestate.com](http://www.afmrealestate.com)  
[www.americanforestmanagement.com](http://www.americanforestmanagement.com)



0 0.05 0.1 0.15 0.2  
Miles

1 inch equals 660 feet

The information provided on this map is believed to be accurate and is based on the best information available at this time, however, this information is in no way guaranteed.

Projection: NAD 1983 Michigan Georef Meters  
Date: June 02, 2009