

CALUMET LAKESHORE - PHASE II

AVAILABLE LOTS IN SEC 5, T56N-R33W, SEC 32 & 33, T57N-33W
HOUGHTON & KEWEENAW COUNTY, MICHIGAN

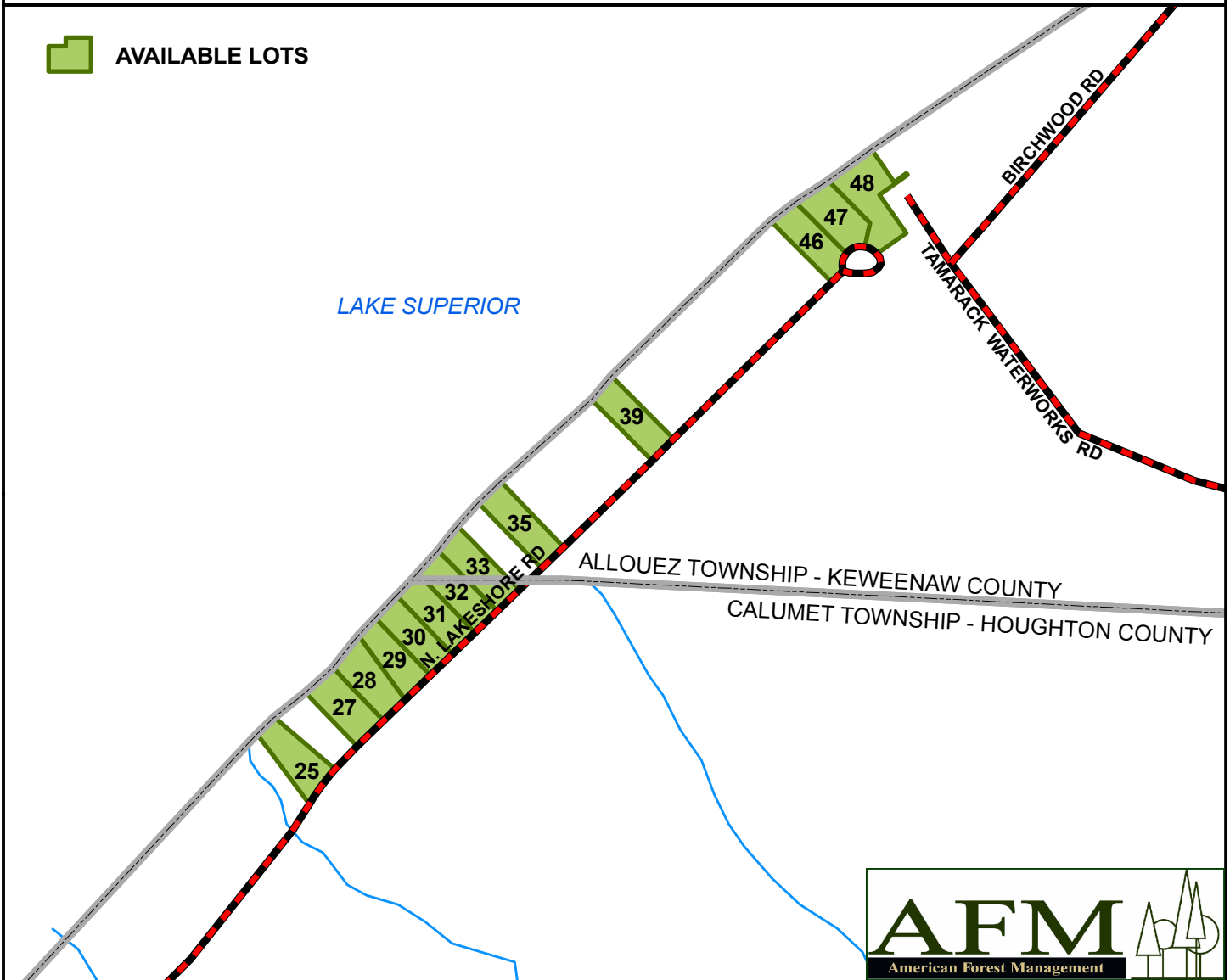

AVAILABLE LOTS



LOT DETAILS

LOT NO	PRICE	LAKE FRONTAGE	ACREAGE
25	\$165,000	120	1.04
27	\$207,625	151	1.02
28	\$209,000	152	1.01
29	\$155,375	113	1.00
30	\$173,250	126	1.00
31	\$173,250	126	1.00
32	\$173,250	126	1.01
33	\$173,250	126	1.01
35	\$173,250	126	1.00
39	\$173,250	126	1.01
46	\$173,250	126	1.00
47	\$217,250	158	1.01
48	\$281,875	205	1.35

Trina L. Anderson, Real Estate Associate Broker

45815 Highway M-26

Atlantic Mine, MI 49905

906-483-0820 Ext 10, Fax: 906-483-0862

www.afmrealestate.com

www.americanforestmanagement.com



0 0.05 0.1 0.15 0.2
Miles

1 inch equals 660 feet

The information provided on this map is believed to be accurate and is based on the best information available at this time, however, this information is in no way guaranteed.

Projection: NAD 1983 Michigan Georef Meters

Date: June 02, 2009