

P.O. Box 65
No. 4 Executive Circle
Arkadelphia, AR 71923
(870)246-5757
FAX 1-870-246-3341
E-mail: arkadelphia@kingwoodforestry.com

Other Kingwood Locations:
P.O. Box 1290
145 Greenfield Drive
Monticello, AR 71657
(870)367-8567
FAX 1-870-367-8424

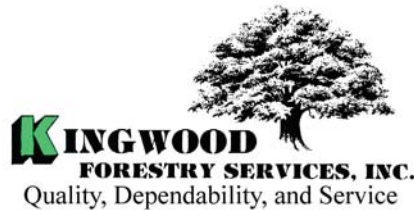

4414 Morris Lane
P.O. Box 5887
Texarkana, TX 75505
(903)831-5200

**Listing
#4050**

NOTICE OF LAND SALE

BLEVINS 40 TRACT (#4050) LAND SALE Bid Date: Friday, May 29, 2009 @ 3:00 P. M.

— 40 Acres For Hunting & Growing Timber Near Blevins, Arkansas —

Kingwood Forestry Services, Inc. has been authorized to manage the sale of a tract of land containing 40 acres, more or less, in Hempstead County, Arkansas.

Tract Location: Land to be sold is described as SE $\frac{1}{4}$ of SE $\frac{1}{4}$, Section 23, Township 10 South, Range 24 West, containing a total of 40 acres, more or less, Hempstead County, Arkansas (Blevins 40 Tract #4050).

Tract Description: Tract is located two miles east of Blevins. Access is via woods road (legal easement) from Hwy 195. Soils consist of fine sandy loams with site index for loblolly pine averaging 82 feet on fifty year base. Tract contains advanced oak and pine regeneration with scattered large oaks. This tract offers excellent deer hunting opportunities. Terrain is gently rolling. Maps and photographs can be viewed at www.kingwoodforestry.com/realestate.htm

Method of Sale: The tract will be sold on the basis of lump sum sealed bids. Mailed offers should be addressed to Kingwood Forestry Services, Inc., P.O. Box 65, Arkadelphia, AR 71923 with “**Blevins 40 (#4050) Land Sale**” clearly marked in the lower left corner of the envelope to protect security of the offer. An offer form is attached. Bids will be opened at the Kingwood Forestry office at #4 Executive Circle, Arkadelphia, Arkansas at **3:00 P.M., Friday, May 29, 2009.** On mailed offers please call our office prior to bid opening to confirm receipt of offer. Buyers submitting offers are welcome to attend the bid opening. Offers may be delivered by fax to 870-246-3341. All faxed offers will be immediately acknowledged. Please await confirmation that your faxed offer has been received. **No verbal telephone offers will be accepted.** Anyone submitting an offer for the purchase of the property will be provided with a summary of bid results.

Blevins 40 (#4050) Land Sale
Bid Date: Friday, May 29, 2009 @ 3:00 P. M.

Conditions of Sale:

1. The landowner reserves the right to accept or reject any offer or to reject all offers.
2. Offers submitted will remain valid through 3:00 P.M., Monday, June 1, 2009. Successful bidder will be notified on or before that time by telephone, fax, or e-mail. Upon acceptance of an offer a more formal Contract of Sale, with earnest money in the amount of 10% of purchase price, will be executed between the successful bidder and landowner within seven business days. A sample Contract of Sale may be provided in advance upon request. Terms are cash at closing. Closing is expected to be held within thirty days of offer acceptance.
3. Only offers for a specific dollar amount will be accepted. The parcel is being sold in its entirety for single sums and not on a per acre basis. Advertised acreage is believed to be correct, but it is not guaranteed. Offer price is for entire tract or tracts, regardless of acreage. Seller will not provide survey. The attached tract map is thought to be accurate but should not be considered as a survey plat.
4. Conveyance will be by Warranty Deed, subject to all previous mineral conveyances, reservations and exceptions, to any valid rights-of-way, easements, leaseholds, and to any protective covenants or restrictions, which may have been recorded affecting the property, with title assured through seller-provided title insurance policy. No environmental inspection or representation has been or will be made by seller. All mineral rights owned by seller are conveyed without warranty.
5. Seller will pay pro-rated property taxes (to date of closing), deed preparation, and one-half of deed stamps. Buyer will pay recording fees and one-half of deed stamps.
6. Local title company will conduct the closing with buyer and seller each paying one-half of fees associated with closing services.
7. Kingwood Forestry is the real estate firm acting as agent for the seller. All information presented in this prospectus is believed to be accurate. Prospective buyers are advised to verify information presented in this sale notice.
8. Questions regarding the land sale should be directed to licensed brokers Pete Prutzman or Terrell Baker or agent Mark Clark of Kingwood Forestry Services at 870-246-5757.

LAND SALE NOTICE

Blevins 40 (#4050)

SE 1/4 of SE 1/4 Section 23, Township 10S, Range 24W

Hempstead County, Arkansas,
containing 40 acres, more or less.

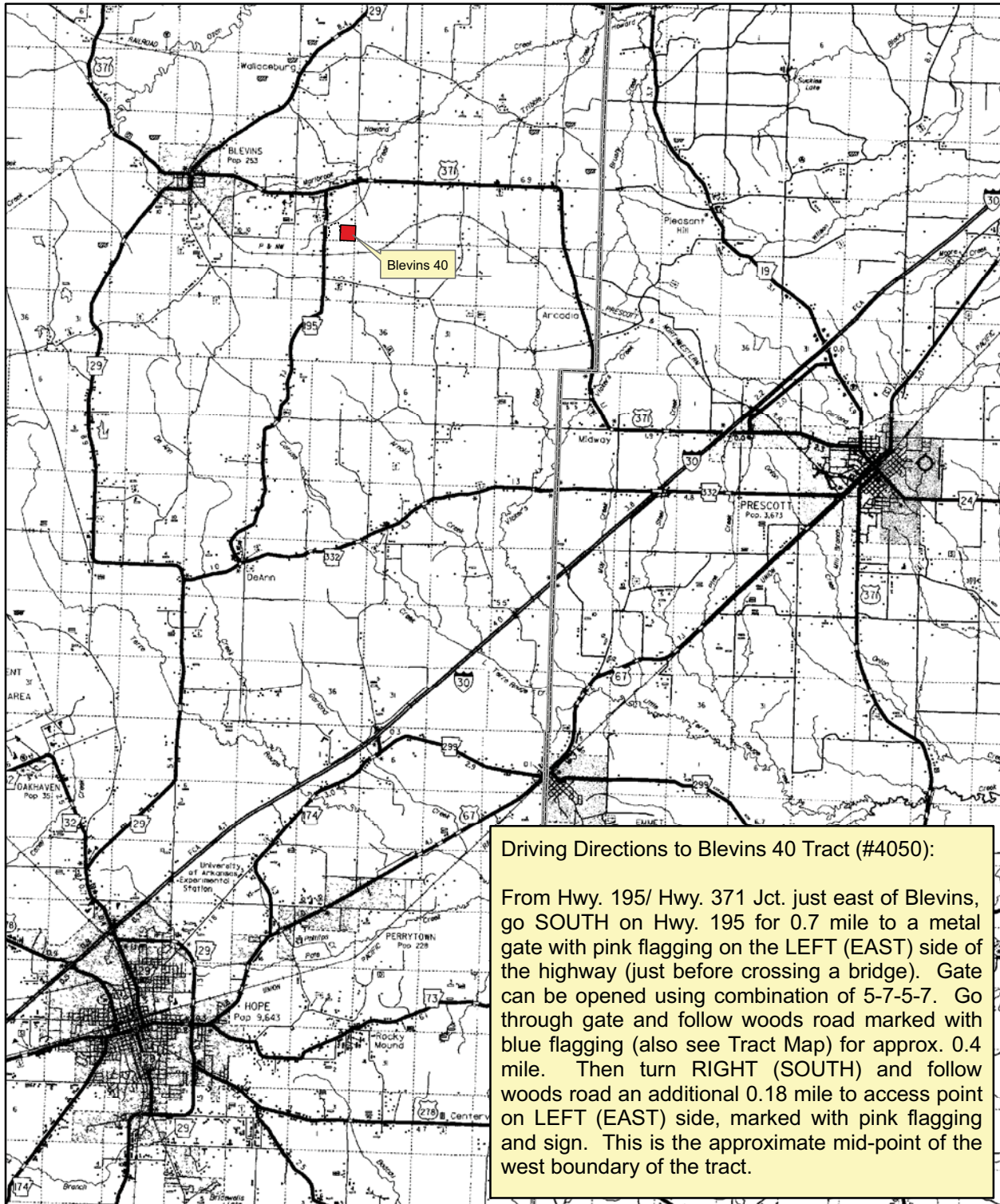

0 1 2 3
Miles

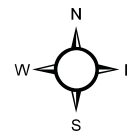

Location Map

LAND SALE NOTICE
Blevins 40 (#4050)
 SE 1/4 of SE 1/4 Section 23, Township 10S, Range 24W
 Hempstead County, Arkansas,
 containing 40 acres, more or less.

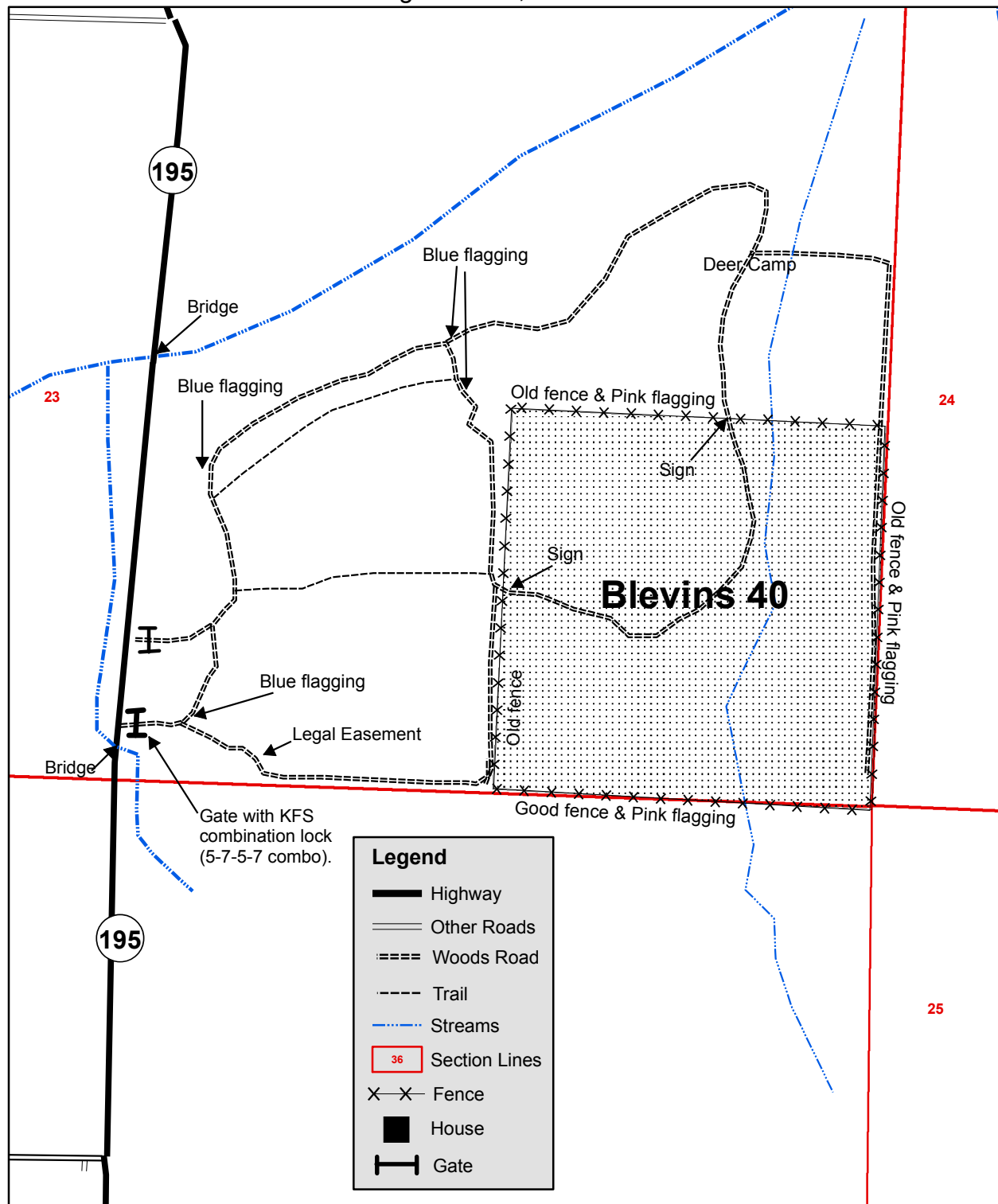

0 0.1
Miles

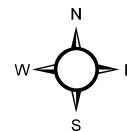

Tact Map
 MEC
 April 2009

OFFER FORM
BLEVINS 40 TRACT (#4050) LAND SALE
HEMPSTEAD COUNTY, ARKANSAS

Bid Date: Friday, May 29, 2009 @ 3:00 P. M.

— Please fax offer to 870-246-3341 or mail to P. O. Box 65, Arkadelphia, AR 71923 —

Reference is made to the Kingwood Forestry Services, Inc. notice for Jenkins 40 (#4050) land sale. I submit the following as an offer for the purchase of the following tract located in Hempstead County, Arkansas and further described as: SE¼ of SE¼, Section 23, Township 10 South, Range 24 West, containing a total of 40 acres, more or less.

My offer will remain valid through 3:00 P.M., Monday, June 1, 2009. Successful bidder(s) will be notified at or before that time by telephone, fax, or e-mail. If my offer is accepted, I am ready, willing, able, and obligated to execute a more formal Contract of Sale within seven business days with earnest money in the amount of 10% of purchase price. Closing is expected to be held within thirty days of offer acceptance.

Send offer form to: Kingwood Forestry Services, Inc. (Before 3:00 p.m. Friday, May 29, 2009)
P. O. Box 65
Arkadelphia, AR 71923
Or fax to 870-246-3341

Blevins 40 (#4050) (40 acres, more or less): \$ _____

Bidder: _____ Fax No.: _____
Printed

Bidder: _____ Phone No.: _____
Signed

Address: _____ Email: _____

City, State, Zip _____ Date: _____