

437.75 ACRES +/- DINWIDDIE COUNTY, VIRGINIA

ASKING PRICE - \$1,457,200



REPRESENTED BY:

G. EDMOND MASSIE, IV
ALC, CCIM, MBA

WILLIAM G. GRANT
ALC, VLS

JEFFREY S. HUFF
REALTOR®, FORESTER

TABLE OF CONTENTS

- I. PROPERTY DESCRIPTION
- II. PHOTOGRAPHS
- III. AERIAL PHOTO
- IV. TOPOGRAPHIC MAP
- V. LOCATION MAP
- VI. FLYER

PROPERTY DESCRIPTION

The subject property is shown on Dinwiddie County Tax Map records as parcel number 7-3 and 7-4. According to the tax records the property contains 435.76 acres. A review of the Dinwiddie County Tax Records indicates the following:

<u>Tax Map Number</u>	<u>Acreage</u>
7-3 & 4	435.76

The subject property is currently zoned RR. There are approximately 50' of road frontage on Namozine Road (fee strip to the property). There is approximately 8,900' (or 1.7 miles +/-) of frontage on Lake Chesdin.

The subject property is completely wooded with mixed sawtimber.

AERIAL PHOTOGRAPH



TOPOGRAPHIC MAP

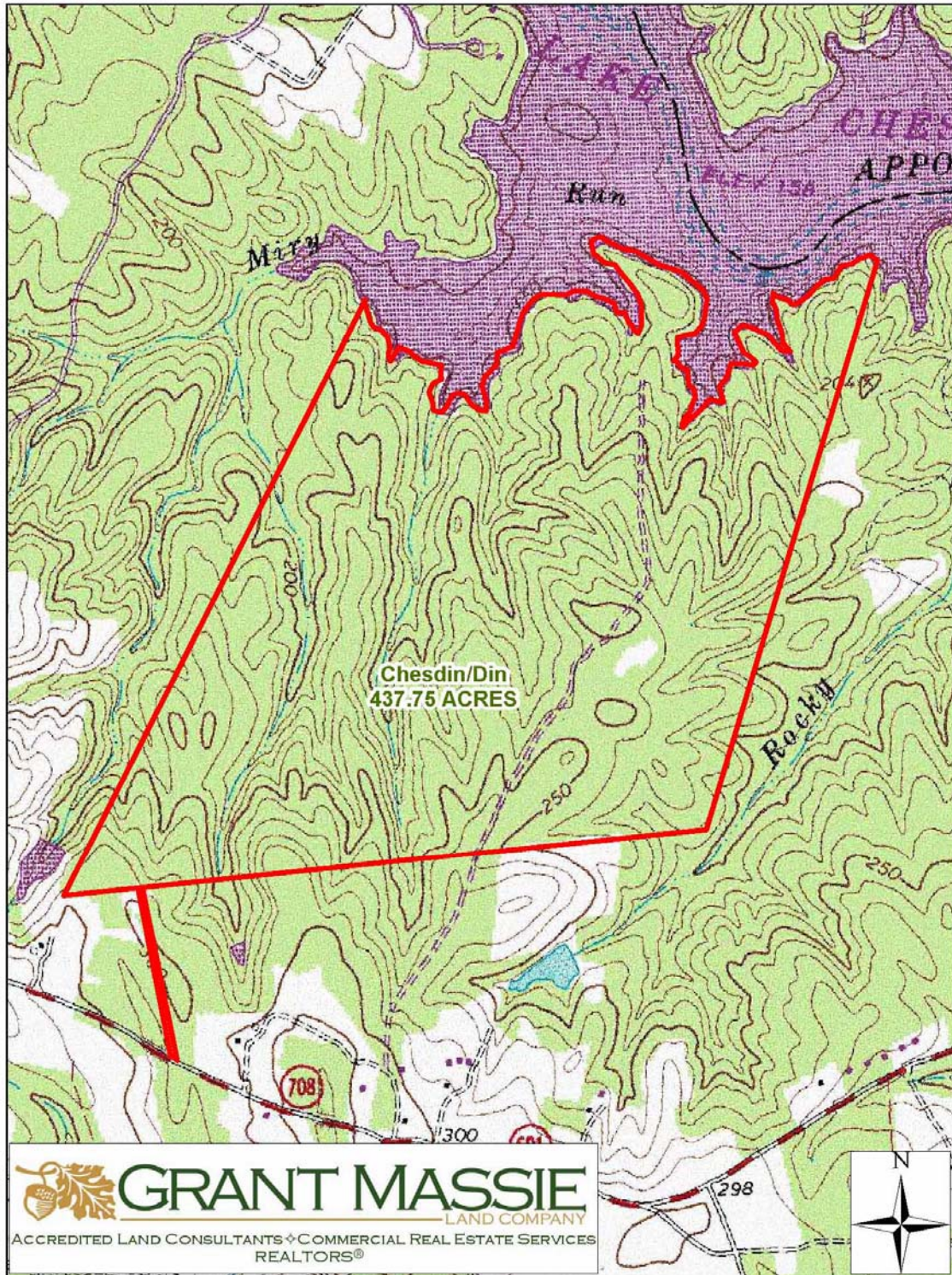

LOCATION MAP

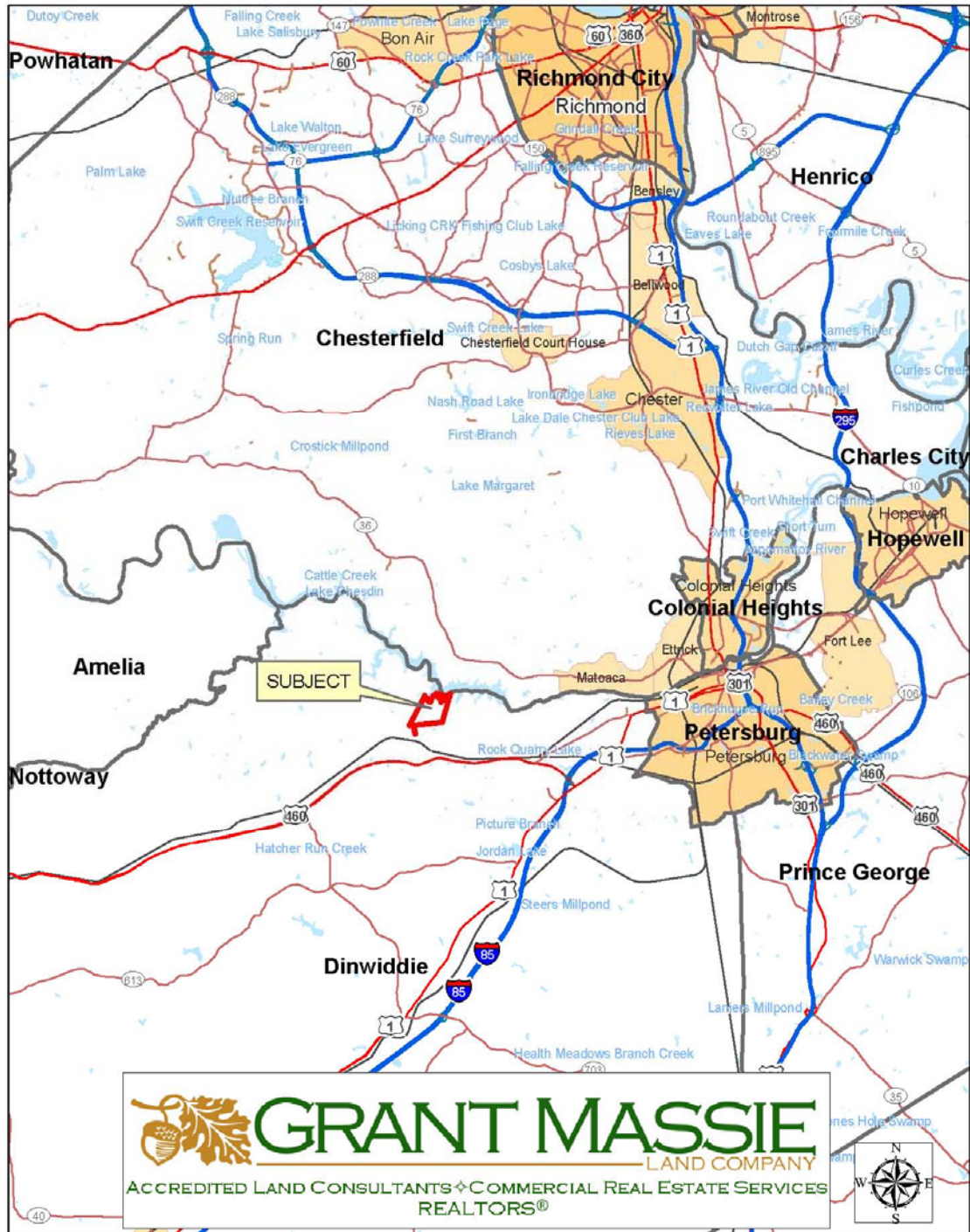

ALMOST HEAVEN ON LAKE CHESDIN!

**437.75 ACRES +/-
DINWIDDIE COUNTY, VA**



**ASKING PRICE:
\$1,457,200**



PROPERTY INFORMATION:

- *1.7 MI. +/- FRONTAGE ON LAKE CHESDIN**
- *WOODED WITH MIXED SAWTIMBER**
- *ZONED: RR**
- *50 FOOT STRIP TO NAMOZINE ROAD**
- *PRICED BELOW ASSESSMENT**

**FOR 24 HOUR RECORDED INFORMATION
CALL LANDLINE: 1-888-471-LAND #2121**

WWW.GRANTMASSIE.COM

REPRESENTED BY:

NED MASSIE
ALC, CCIM, MBA
(804) 754-3474
NMassie@GrantMassie.com

BILL GRANT
ALC, VLS
(804) 754-3476
WGrant@GrantMassie.com

JEFF HUFF
REALTOR, FORESTER
(804) 750-1207
JHuff@GrantMassie.com



EXPERTISE—CONSULTATION—RESULTS

1403 Pemberton Road, Suite 106; Richmond, VA 23238
804-750-1200—FAX: 804-754-3485 TOLL FREE: 1-800-665-LAND
All information deemed reliable, but not guaranteed.