

Soil Map—Sioux County, Nebraska
(South Pivot (266 Acres))

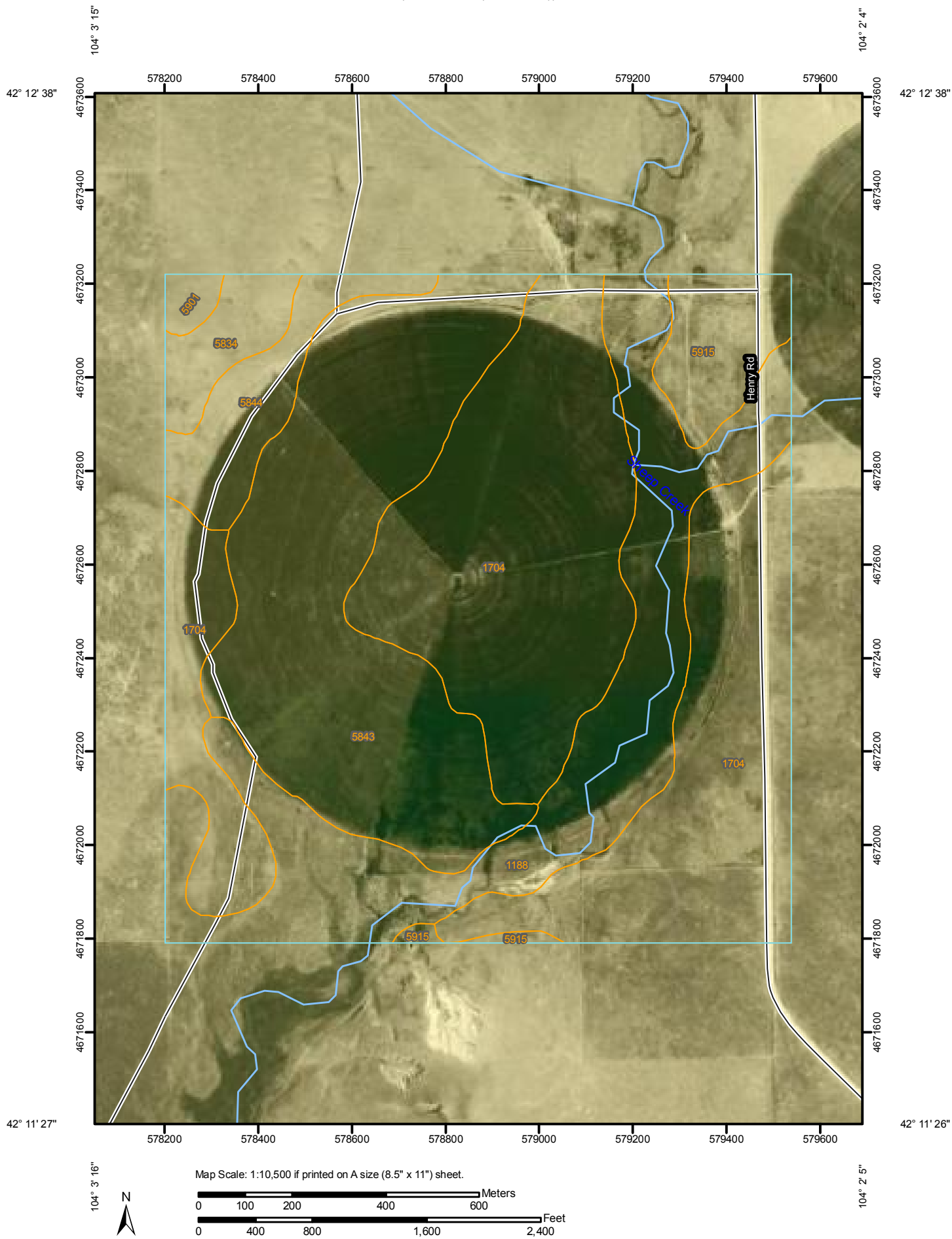

Soil Map—Sioux County, Nebraska
(South Pivot (266 Acres))

MAP LEGEND

Area of Interest (AOI)

 Area of Interest (AOI)

Soils

 Soil Map Units

Special Point Features

-  Blowout
-  Borrow Pit
-  Clay Spot
-  Closed Depression
-  Gravel Pit
-  Gravelly Spot
-  Landfill
-  Lava Flow
-  Marsh or swamp
-  Mine or Quarry
-  Miscellaneous Water
-  Perennial Water
-  Rock Outcrop
-  Saline Spot
-  Sandy Spot
-  Severely Eroded Spot
-  Sinkhole
-  Slide or Slip
-  Sodic Spot
-  Spoil Area
-  Stony Spot



Very Stony Spot



Wet Spot



Other

Special Line Features



Gully



Short Steep Slope



Other

Political Features



Cities

Water Features



Oceans



Streams and Canals

Transportation



Rails



Interstate Highways



US Routes



Major Roads



Local Roads

MAP INFORMATION

Map Scale: 1:10,500 if printed on A size (8.5" × 11") sheet.

The soil surveys that comprise your AOI were mapped at 1:20,000.

Please rely on the bar scale on each map sheet for accurate map measurements.

Source of Map: Natural Resources Conservation Service

Web Soil Survey URL: <http://websoilsurvey.nrcs.usda.gov>

Coordinate System: UTM Zone 13N NAD83

This product is generated from the USDA-NRCS certified data as of the version date(s) listed below.

Soil Survey Area: Sioux County, Nebraska

Survey Area Data: Version 11, Oct 28, 2008

Date(s) aerial images were photographed: 8/23/2006; 8/22/2006

The orthophoto or other base map on which the soil lines were compiled and digitized probably differs from the background imagery displayed on these maps. As a result, some minor shifting of map unit boundaries may be evident.



Map Unit Legend

Sioux County, Nebraska (NE165)			
Map Unit Symbol	Map Unit Name	Acres in AOI	Percent of AOI
1188	Las Animas-Lisco complex, occasionally flooded	93.7	19.8%
1704	Otero loamy very fine sand, 0 to 3 percent slopes	204.3	43.2%
5834	Mitchell silt loam, 0 to 1 percent slopes	12.2	2.6%
5843	Mitchell very fine sandy loam, 0 to 1 percent slopes	117.4	24.8%
5844	Mitchell very fine sandy loam, 1 to 3 percent slopes	21.6	4.6%
5901	Alice fine sandy loam, 0 to 3 percent slopes	3.2	0.7%
5915	Ashollow loamy very fine sand, 3 to 9 percent slopes	20.1	4.3%
Totals for Area of Interest		472.6	100.0%