

ROW Crossing Tract (#7005)  
+/- 40 Acres  
NW1/4 of NE1/4, Sec. 29, T15S, R24W  
Lafayette County, Arkansas

**Driving Instructions**

From the intersection of US Highway 82 and State Highway 29 in Lewisville, AR, travel north on State Highway 29 approximately 4.5 miles. Find pink KFS flagging at County Rd. 106 on the left. Turn left onto County Rd. 106 and travel west appr. 0.15 miles to find KFS flagging at woods rd. on the right. Follow KFS flagline to NE corner of tract which is marked with KFS flagging.

Note: There is a deep water hole in the middle of woods road after crossing the first powerline right-of-way. Use of an ATV after this point is recommended.

**Land Sale Area**

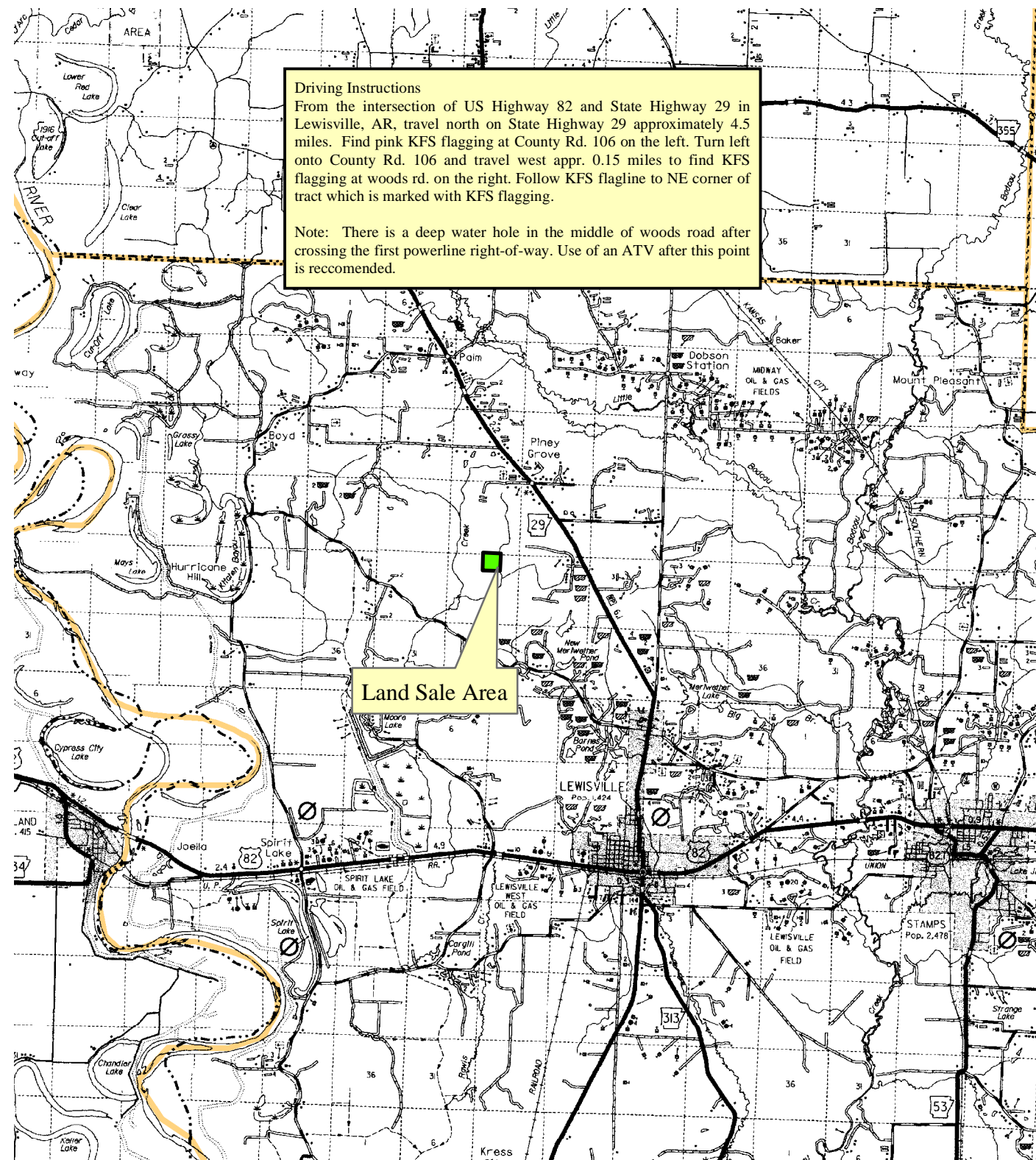

0 0.5 1 2  
Miles