

Curt Bean Lumber Company, Inc. and Curt Bean Transport, Inc.  
 Pt. Sec. 31, 32, 33, T4S, R25W;  
 Pt. Sec. 5 & 6, T5S, R25W  
 Montgomery & Pike County, Arkansas

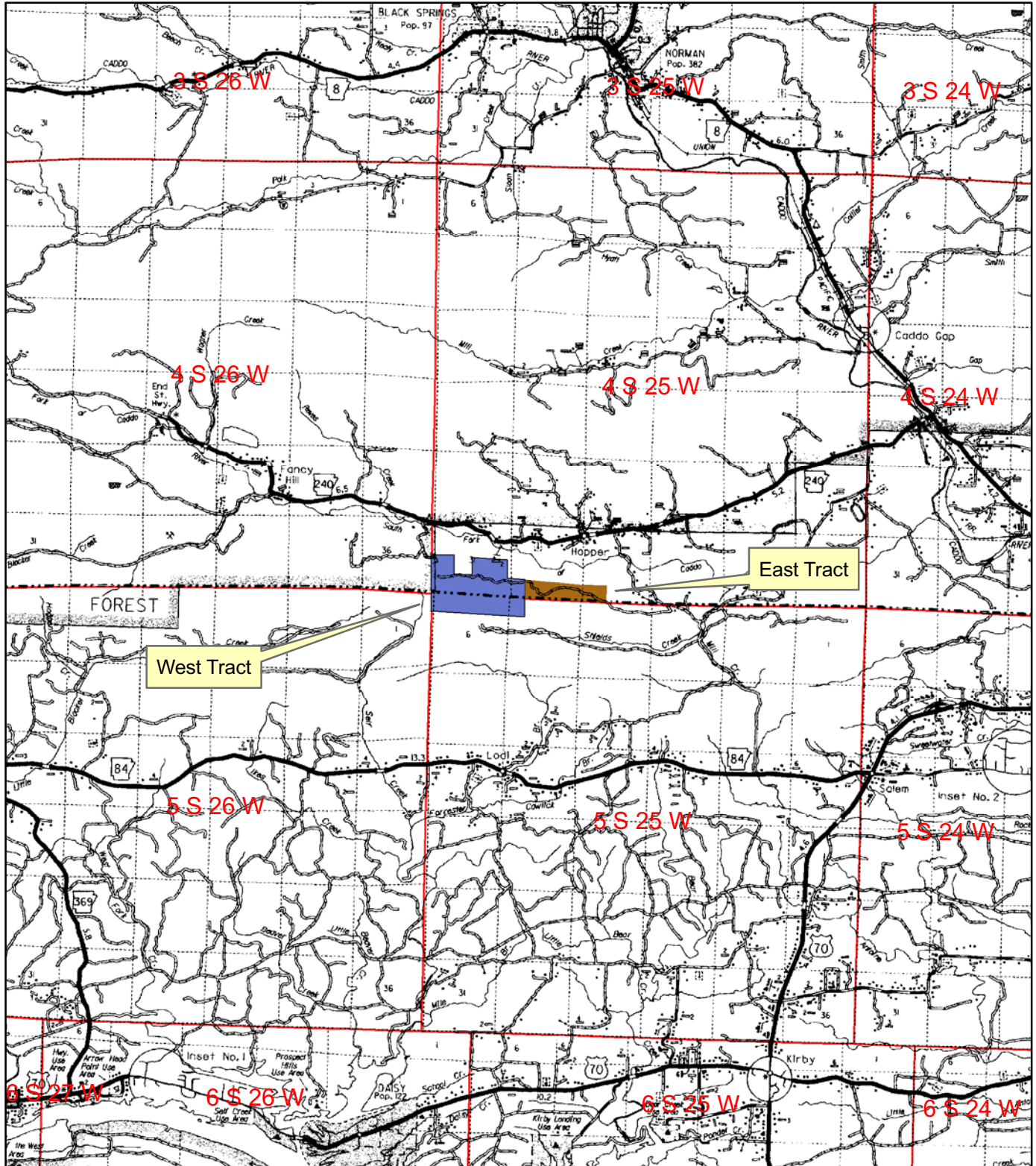

0 0.5 1 2 3  
 Miles



Created: October, 2008  
 By: JDT