



\$129,900

Multi-Family Home or Rental - 409 N Hunt St BELLVILLE, Austin County

ID: 49044



BILL JOHNSON AND ASSOC. REAL ESTATE CO.

420 E. Main St., Bellville - FM 1094 at Cedar St., New Ulm Bellville - New
Ulm, TX 77418 - 78950

Phone: Bellville (979) 865-5466 New Ulm (979) 992-2636 Fax: Bellville (979)
865-5500 New Ulm (979) 992-2637

Email: billjohnson@bjre.com



This property consists of two dwellings.

The main house is approximately 992 sq ft, 2 bedroom, 1 bath, central heat and air-conditioning.

The apartment is approximately 912 sq ft, 2 bedroom, 1 bath/whirlpool tub, ceramic tile floor in living room and one bedroom.

Large fenced yard with many varieties of mature trees.

Ideal for multiple-family occupancy or two rental units.

***BILL JOHNSON AND ASSOCIATES REAL ESTATE COMPANY WILL CO-BROKER IF BUYER IS
ACCOMPANIED BY HIS/HER AGENT AT ALL PROPERTY SHOWINGS.*** ...

Improvements

4 Bedrooms
2 Bathrooms
Approx. 1904 Sq F
Const. Type: Standard
Frame
Single Floor
Vinyl Exterior
Composition Roof
Year Built: 1958
Age Range: Over 20 Yrs
Public Water

Land Features

Approx. 0.42 Acres
Maint. Fees: \$0
Paved Road Frontage
Minerals Conveyed:
Negotiable

Other

Residential (Town-S/D)
Status: Active
School District: Bellville
Taxes: \$1,711.68
Tax ID: R04490

Financing

Cash
Conventional



BILL JOHNSON AND ASSOC. REAL ESTATE CO.

420 E. Main St., Bellville

FM 1094 at Cedar St., New Ulm

Bellville - New Ulm , TX 77418 - 78950

Phone: Bellville (979) 865-5466 New Ulm (979) 992-2636

Fax: Bellville (979) 865-5500 New Ulm (979) 992-2637

Email: billjohnson@bjre.com

409 N Hunt St



Backyard View



Kitchen - Main house



Kitchen - Apartment



Bath - Main House



Bill Johnson and Associates Real Estate Co.

420 E. Main St., Bellville TX 77418

FM 1094 @ Cedar St., New Ulm, TX 78950

979-865-5969 or 281-463-3791 - Bellville office

979-992-2636 or 281-220-2636 - New Ulm office

www.bjre.com

NO REPRESENTATIONS OR WARRANTIES EITHER EXPRESSED OR IMPLIED ARE MADE AS TO THE ACCURACY OF THE INFORMATION HEREIN OR WITH RESPECT TO THE SUITABILITY, USEABILITY, FEASIBILITY, MERCHANTABILITY OR CONDITION OF ANY PROPERTY DESCRIBED HEREIN.

HOME LISTING

Address of Home: 409 N Hunt St, Bellville, Texas 77418 Listing #: 49044
 Location of Home: 5 Blocks northwest of Bellville town square
 County or Region: Austin For Sale Sign on Property? ☒ YES ☐ NO
 Subdivision: _____ Property Size: 420 ac
 Subdivision Restricted: ☐ YES ☒ NO Mandatory Membership in Property Owners' Assn. ☐ YES ☒ NO

Listing Price: \$129,900.00

Terms of Sale

Cash: ☒ YES ☐ NO

Seller-Finance: ☐ YES ☒ NO

Sell.-Fin. Terms:

Down Payment: _____

Note Period: _____

Interest Rate: _____

Payment Mode: ☐ Mo. ☐ Qt. ☐ S.A. ☐ Ann.

Balloon Note: ☐ YES ☐ NO

Number of Years: _____

Size and Construction:

Year Home was Built: pre-1974

Lead Based Paint Addendum Required if prior to 1978: ☒ YES

Bedrooms: 2 Bath: 1

Size of Home (Approx.) 992sf/ACAD

Total

Foundation: ☐ Slab ☒ Pier/Beam ☐ Other

Roof Type: composition Year Installed: unknown

Exterior Construction: vinyl

Room Measurements: APPROXIMATE SIZE:

Living Room: 11x16

Dining Room: _____

Kitchen: 14x19

Family Room: _____

Utility Room: 7x14

Bath: 7x8 ☒ Tub ☒ Shower

Bath: ☐ Tub ☐ Shower

Mstr Bath: ☐ Tub ☐ Shower

Mstr Bdrm: _____

Bedroom: 9x12

Bedroom: 9x11

Bedroom: _____

Other: _____

Garage: ☐ Carport: ☐ No. of Cars: _____

Size: ☐ Attached ☐ Detached

Porches:

Front: Size: 4x8

Side: Size: _____

Deck: Size: 18x21 ☐ Covered

Deck: Size: _____ ☐ Covered

Fenced Yard: chain link

Outside Storage: ☐ Yes ☐ No Size: _____

Construction: _____

TV Antenna ☐ Dish ☐ Cable ☒

Home Features

☒ Ceiling Fans No. 2

☐ Dishwasher

☐ Garbage Disposal

☐ Microwave (Built-In)

☒ Kitchen Range ☒ Gas ☐ Electric

☒ Other refrigerator

Items Specifically Excluded from The Sale: LIST: _____

Heat and Air:

☒ Central Heat Gas ☒ Electric ☐

☒ Central Air Gas ☐ Electric ☒

☐ Other: _____

☐ Fireplace(s) _____

☐ Wood Stove

☒ Water Heater(s): ☒ Gas ☐ Electric

Utilities:

Electricity Provider: City of Bellville

Gas Provider: City of Bellville

Sewer Provider: City of Bellville

Water Provider: City of Bellville

Water Well: ☐ YES ☒ NO Depth: _____

Year Drilled: _____

Average Utility Bill: _____ Monthly: _____

Taxes:

2007 Year

School: _____ \$1,024.00

County: _____ \$283.84

FM/Rd/Br: _____ \$107.04

Hospital: _____ \$60.56

City: _____ \$236.24

Taxes: _____ \$1,711.68

School District: Bellville

Additional Information:

Jennair grill in kitchen

BILL JOHNSON AND ASSOCIATES REAL ESTATE COMPANY WILL CO-BROKER IF BUYER IS ACCOMPANIED BY HIS OR HER AGENT AT ALL PROPERTY SHOWINGS.

**Bill Johnson and Associates Real Estate Co.**

420 E. Main St., Bellville TX 77418

FM 1094 @ Cedar St., New Ulm, TX 78950

979-865-5969 or 281-463-3791 - Bellville office

979-992-2636 or 281-220-2636 - New Ulm office

www.bjre.com

NO REPRESENTATIONS OR WARRANTIES EITHER EXPRESSED OR IMPLIED ARE MADE AS TO THE ACCURACY OF THE INFORMATION HEREIN OR WITH RESPECT TO THE SUITABILITY, USEABILITY, FEASIBILITY, MERCHANTABILITY OR CONDITION OF ANY PROPERTY DESCRIBED HEREIN.

ApartmentAddress of Home: 409 N Hunt St, Bellville, Texas 77418 Listing #: 49044Location of Home: 5 blocks northwest of Bellville town squareCounty or Region: Austin For Sale Sign on Property? ☒ YES ☐ NOSubdivision: Property Size: .42 acreSubdivision Restricted: ☐ YES ☒ NO Mandatory Membership in Property Owners' Assn. ☐ YES ☒ NO**Listing Price:** \$129,900.00**Terms of Sale:**Cash: ☒ YES ☐ NOSeller-Finance: ☐ YES ☒ NO**Sell.-Fin. Terms:**

Down Payment: _____

Note Period: _____

Interest Rate: _____

Payment Mode: ☐ Mo. ☐ Qt. ☐ S.A. ☐ Ann.Balloon Note: ☐ YES ☐ NO

Number of Years: _____

Size and Construction:Year Home was Built: 1958Lead Based Paint Addendum Required if prior to 1978: ☒ YESBedrooms: 2 Baths: 1Size of Home (Approx.) 912sf/ACAD Living Area**Total**Foundation: ☒ Slab ☐ Pier/Beam ☐ OtherRoof Type: composition Year Installed: unknownExterior Construction: wood**Room Measurements: APPROXIMATE SIZE:**Living Room 18x19

Dining Room _____

Kitchen: 10x10

Family Room: _____

Utility Room: _____

Bath: 7x10 whirlpool ☒ Tub ☒ ShowerBath: ☐ Tub ☐ ShowerBath: Master ☐ Tub ☐ ShowerBedroom: 10x17Bedroom: 10x18

Bedroom: _____

Bedroom: _____

Other: _____

Garage: ☐ Carport: ☒ No. of Cars: 1Size: 11x18 ☒ Attached ☐ Detached**Porches:**

Front: Size: _____

Back: Size: _____

Deck: Size: 11x15 ☒ CoveredDeck: Size: _____ ☐ CoveredFenced Yard: chain linkOutside Storage: ☒ Yes ☐ No Size: 10x12

Construction: _____

TV Antenna ☐ Dish ☐ Cable ☒**Home Features:**☐ Ceiling Fans No. _____☐ Dishwasher☐ Garbage Disposal☐ Microwave (Built-In)☒ Kitchen Range ☐ Gas ☒ Electric☐ Other _____

Items Specifically Excluded from The Sale: LIST: _____

Heat and Air:☐ Central Heat Gas ☐ Electric ☐☐ Central Air Gas ☐ Electric ☐☐ Other: _____☐ Fireplace(s) _____☐ Wood Stove _____☒ Water Heater(s): ☐ Gas ☒ Electric**Utilities:**Electricity Provider: City of BellvilleGas Provider: City of BellvilleSewer Provider: City of BellvilleWater Provider: City of BellvilleWater Well: ☐ YES ☒ NO Depth: _____

Year Drilled: _____

Average Utility Bill: Monthly: _____

Taxes:2007 Year

School: _____ \$1,024.00

County: _____ \$283.84

FM/Rd/Br: _____ \$107.04

Hospital: _____ \$60.56

City: _____ \$236.24

Taxes: _____ \$1,711.68School District: Bellville**Additional Information:**

BILL JOHNSON AND ASSOCIATES REAL ESTATE COMPANY WILL CO-BROKER IF BUYER IS ACCOMPANIED BY HIS OR HER AGENT AT ALL PROPERTY SHOWINGS.

BELLEVILLE

A B C D E

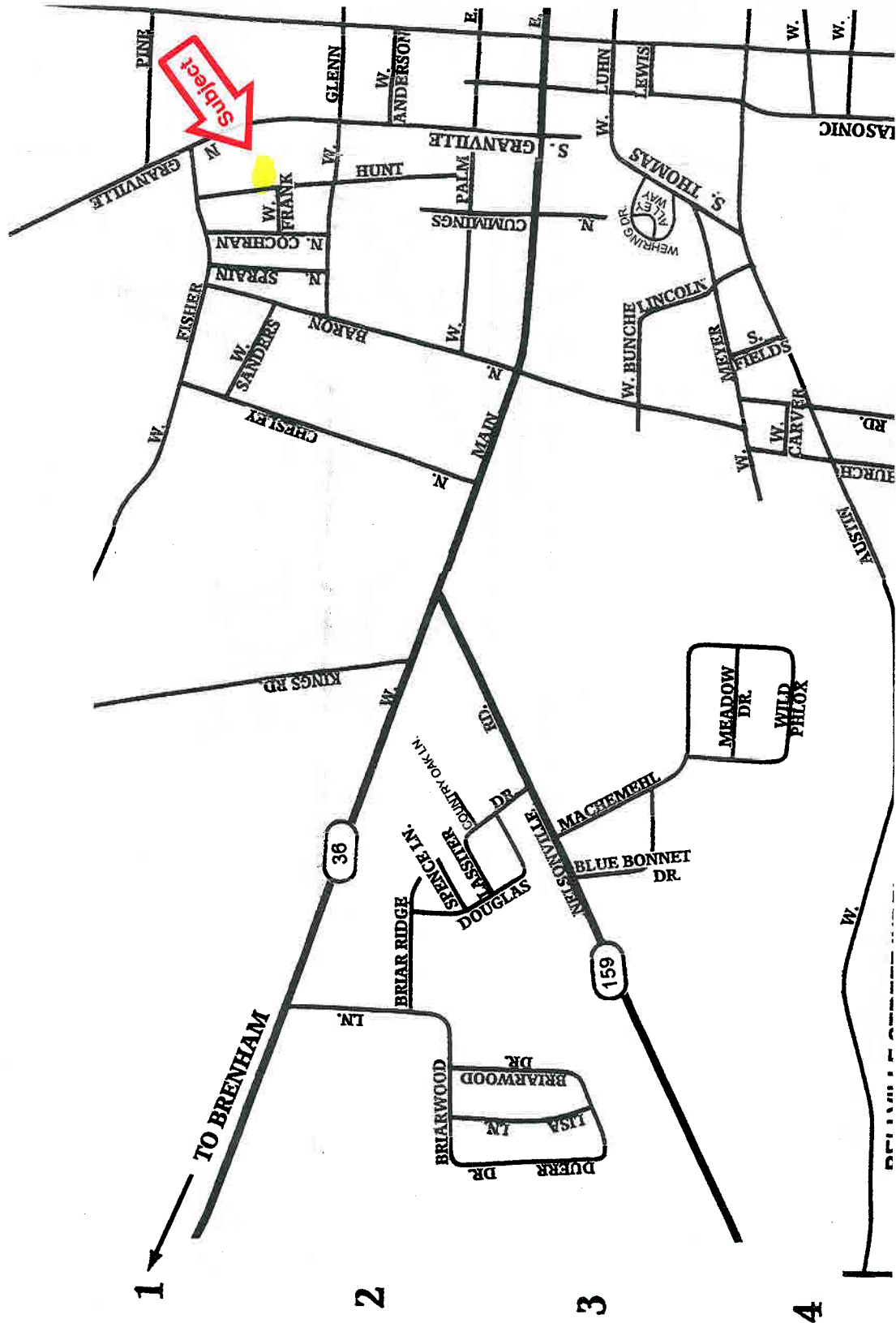



Main house

TEXAS ASSOCIATION OF REALTORS® SELLER'S DISCLOSURE NOTICE

©Texas Association of REALTORS®, Inc. 2007

Section 5.008, Property Code requires a seller of residential property of not more than one dwelling unit to deliver a Seller's Disclosure Notice to a buyer on or before the effective date of a contract. **This form complies with and contains additional disclosures which exceed the minimum disclosures required by the Code.**

CONCERNING THE PROPERTY AT

409 N Hunt St
Bellville, Tx 77418

THIS NOTICE IS A DISCLOSURE OF SELLER'S KNOWLEDGE OF THE CONDITION OF THE PROPERTY AS OF THE DATE SIGNED BY SELLER AND IS NOT A SUBSTITUTE FOR ANY INSPECTIONS OR WARRANTIES THE BUYER MAY WISH TO OBTAIN. IT IS NOT A WARRANTY OF ANY KIND BY SELLER, SELLER'S AGENTS, OR ANY OTHER AGENT.

Seller ☐ is ☐ is not occupying the Property. If unoccupied (by Seller), how long since Seller has occupied the Property?
☐ _____ or ☐ never occupied the Property

Section 1. The Property has the items marked below: (Mark Yes (Y), No (N), or Unknown (U).)

This notice does not establish the items to be conveyed. The contract will determine which items will & will not convey.

Item	Y	N	U
Cable TV Wiring			<input checked="" type="checkbox"/>
Carbon Monoxide Det.			<input checked="" type="checkbox"/>
Ceiling Fans	<input checked="" type="checkbox"/>		
Cooktop	<input checked="" type="checkbox"/>		
Dishwasher			<input checked="" type="checkbox"/>
Disposal			<input checked="" type="checkbox"/>
Emergency Escape Ladder(s)			<input checked="" type="checkbox"/>
Exhaust Fans			<input checked="" type="checkbox"/>
Fences	<input checked="" type="checkbox"/>		
Fire Detection Equip.	<input checked="" type="checkbox"/>		
French Drain			<input checked="" type="checkbox"/>
Gas Fixtures	<input checked="" type="checkbox"/>		

Item	Y	N	U
Gas Lines (Nat/LP)	<input checked="" type="checkbox"/>		
Hot Tub			<input checked="" type="checkbox"/>
Intercom System			<input checked="" type="checkbox"/>
Microwave			<input checked="" type="checkbox"/>
Outdoor Grill			<input checked="" type="checkbox"/>
Patio/Decking			<input checked="" type="checkbox"/>
Plumbing System	<input checked="" type="checkbox"/>		
Pool			<input checked="" type="checkbox"/>
Pool Equipment			<input checked="" type="checkbox"/>
Pool Maint. Accessories			<input checked="" type="checkbox"/>
Pool Heater			<input checked="" type="checkbox"/>
Public Sewer System	<input checked="" type="checkbox"/>		

Item	Y	N	U
Pump: <input type="checkbox"/> sump <input type="checkbox"/> grinder			<input checked="" type="checkbox"/>
Rain Gutters			<input checked="" type="checkbox"/>
Range/Stove	<input checked="" type="checkbox"/>		
Roof/Attic Vents	<input checked="" type="checkbox"/>		
Sauna			<input checked="" type="checkbox"/>
Smoke Detector	<input checked="" type="checkbox"/>		
Smoke Detector - Hearing Impaired			<input checked="" type="checkbox"/>
Spa			<input checked="" type="checkbox"/>
Trash Compactor			<input checked="" type="checkbox"/>
TV Antenna			<input checked="" type="checkbox"/>
Washer/Dryer Hookup	<input checked="" type="checkbox"/>		
Window Screens	<input checked="" type="checkbox"/>		

Item	Y	N	U	Additional Information
Central A/C	<input checked="" type="checkbox"/>			<input type="checkbox"/> electric <input checked="" type="checkbox"/> gas number of units: <u>1 stove</u>
Evaporative Coolers			<input checked="" type="checkbox"/>	number of units: _____
Wall/Window AC Units			<input checked="" type="checkbox"/>	number of units: _____
Attic Fan(s)			<input checked="" type="checkbox"/>	if yes, describe: _____
Central Heat	<input checked="" type="checkbox"/>			<input type="checkbox"/> electric <input type="checkbox"/> gas number of units: _____
Other Heat			<input checked="" type="checkbox"/>	if yes, describe: _____
Oven	<input checked="" type="checkbox"/>			number of ovens: <u>1</u> <input type="checkbox"/> electric <input checked="" type="checkbox"/> gas <input type="checkbox"/> other: _____
Fireplace & Chimney			<input checked="" type="checkbox"/>	<input type="checkbox"/> wood <input type="checkbox"/> gas logs <input type="checkbox"/> mock <input type="checkbox"/> other: _____
Carport			<input checked="" type="checkbox"/>	<input type="checkbox"/> attached <input type="checkbox"/> not attached
Garage			<input checked="" type="checkbox"/>	<input type="checkbox"/> attached <input type="checkbox"/> not attached
Garage Door Openers			<input checked="" type="checkbox"/>	number of units: _____ number of remotes: _____
Satellite Dish & Controls			<input checked="" type="checkbox"/>	<input type="checkbox"/> owned <input type="checkbox"/> leased from _____
Security System			<input checked="" type="checkbox"/>	<input type="checkbox"/> owned <input type="checkbox"/> leased from _____
Water Heater	<input checked="" type="checkbox"/>			<input type="checkbox"/> electric <input type="checkbox"/> gas <input type="checkbox"/> other: _____ number of units: _____
Water Softener			<input checked="" type="checkbox"/>	<input type="checkbox"/> owned <input type="checkbox"/> leased from _____
Underground Lawn Sprinkler			<input checked="" type="checkbox"/>	<input type="checkbox"/> automatic <input type="checkbox"/> manual areas covered: _____
Septic / On-Site Sewer Facility			<input checked="" type="checkbox"/>	if yes, attach Information About On-Site Sewer Facility (TAR-1407)

(TAR-1406) 7-2-07

Initialed by: Seller: [Signature] and Buyer: _____

Page 1 of 5

Concerning the Property at _____

409 N Hunt St
Bellville, Tx 77418

Water supply provided by: ☐ city ☐ well ☐ MUD ☐ co-op ☐ unknown ☐ other: _____

Was the Property built before 1978? ☐ yes ☐ no ☐ unknown

(If yes, complete, sign, and attach TAR-1906 concerning lead-based paint hazards).

Roof Type: _____ Age: _____ (approximate)

Is there an overlay roof covering on the Property (shingles or roof covering placed over existing shingles or roof covering)?

☐ yes ☐ no ☐ unknown

Are you (Seller) aware of any of the items listed in this Section 1 that are not in working condition, that have defects, or are need of repair? ☐ yes ☐ no If yes, describe (attach additional sheets if necessary): _____

Section 2. Are you (Seller) aware of any defects or malfunctions in any of the following?: (Mark Yes (Y) if you are aware and No (N) if you are not aware.)

Item	Y	N
Basement	<input checked="" type="checkbox"/>	<input checked="" type="checkbox"/>
Ceilings	<input checked="" type="checkbox"/>	<input checked="" type="checkbox"/>
Doors	<input checked="" type="checkbox"/>	<input checked="" type="checkbox"/>
Driveways	<input checked="" type="checkbox"/>	<input checked="" type="checkbox"/>
Electrical Systems	<input checked="" type="checkbox"/>	<input checked="" type="checkbox"/>
Exterior Walls	<input checked="" type="checkbox"/>	<input checked="" type="checkbox"/>

Item	Y	N
Floors	<input checked="" type="checkbox"/>	<input checked="" type="checkbox"/>
Foundation / Slab(s)	<input checked="" type="checkbox"/>	<input checked="" type="checkbox"/>
Interior Walls	<input checked="" type="checkbox"/>	<input checked="" type="checkbox"/>
Lighting Fixtures	<input checked="" type="checkbox"/>	<input checked="" type="checkbox"/>
Plumbing Systems	<input checked="" type="checkbox"/>	<input checked="" type="checkbox"/>
Roof	<input checked="" type="checkbox"/>	<input checked="" type="checkbox"/>

Item	Y	N
Sidewalks	<input checked="" type="checkbox"/>	<input checked="" type="checkbox"/>
Walls / Fences	<input checked="" type="checkbox"/>	<input checked="" type="checkbox"/>
Windows	<input checked="" type="checkbox"/>	<input checked="" type="checkbox"/>
Other Structural Components	<input checked="" type="checkbox"/>	<input checked="" type="checkbox"/>

If the answer to any of the items in Section 2 is yes, explain (attach additional sheets if necessary): _____

Section 3. Are you (Seller) aware of any of the following conditions: (Mark Yes (Y) if you are aware and No (N) if you are not aware.)

Condition	Y	N
Aluminum Wiring	<input checked="" type="checkbox"/>	<input checked="" type="checkbox"/>
Asbestos Components	<input checked="" type="checkbox"/>	<input checked="" type="checkbox"/>
Diseased Trees: <input type="checkbox"/> oak wilt <input type="checkbox"/> _____	<input checked="" type="checkbox"/>	<input checked="" type="checkbox"/>
Endangered Species/Habitat on Property	<input checked="" type="checkbox"/>	<input checked="" type="checkbox"/>
Fault Lines	<input checked="" type="checkbox"/>	<input checked="" type="checkbox"/>
Hazardous or Toxic Waste	<input checked="" type="checkbox"/>	<input checked="" type="checkbox"/>
Improper Drainage	<input checked="" type="checkbox"/>	<input checked="" type="checkbox"/>
Intermittent or Weather Springs	<input checked="" type="checkbox"/>	<input checked="" type="checkbox"/>
Landfill	<input checked="" type="checkbox"/>	<input checked="" type="checkbox"/>
Lead-Based Paint or Lead-Based Pt. Hazards	<input checked="" type="checkbox"/>	<input checked="" type="checkbox"/>
Encroachments onto the Property	<input checked="" type="checkbox"/>	<input checked="" type="checkbox"/>
Improvements encroaching on others' property	<input checked="" type="checkbox"/>	<input checked="" type="checkbox"/>
Located in 100-year Floodplain	<input checked="" type="checkbox"/>	<input checked="" type="checkbox"/>
Present Flood Insurance Coverage (If yes, attach TAR-1414)	<input checked="" type="checkbox"/>	<input checked="" type="checkbox"/>
Previous Flooding into the Structures	<input checked="" type="checkbox"/>	<input checked="" type="checkbox"/>
Previous Flooding onto the Property	<input checked="" type="checkbox"/>	<input checked="" type="checkbox"/>
Previous Fires	<input checked="" type="checkbox"/>	<input checked="" type="checkbox"/>
Previous Foundation Repairs	<input checked="" type="checkbox"/>	<input checked="" type="checkbox"/>

Condition	Y	N
Previous Roof Repairs	<input checked="" type="checkbox"/>	<input checked="" type="checkbox"/>
Other Structural Repairs	<input checked="" type="checkbox"/>	<input checked="" type="checkbox"/>
Radon Gas	<input checked="" type="checkbox"/>	<input checked="" type="checkbox"/>
Settling	<input checked="" type="checkbox"/>	<input checked="" type="checkbox"/>
Soil Movement	<input checked="" type="checkbox"/>	<input checked="" type="checkbox"/>
Subsurface Structure or Pits	<input checked="" type="checkbox"/>	<input checked="" type="checkbox"/>
Underground Storage Tanks	<input checked="" type="checkbox"/>	<input checked="" type="checkbox"/>
Unplatted Easements	<input checked="" type="checkbox"/>	<input checked="" type="checkbox"/>
Unrecorded Easements	<input checked="" type="checkbox"/>	<input checked="" type="checkbox"/>
Urea-formaldehyde Insulation	<input checked="" type="checkbox"/>	<input checked="" type="checkbox"/>
Water Penetration	<input checked="" type="checkbox"/>	<input checked="" type="checkbox"/>
Wetlands on Property	<input checked="" type="checkbox"/>	<input checked="" type="checkbox"/>
Wood Rot	<input checked="" type="checkbox"/>	<input checked="" type="checkbox"/>
Active infestation of termites or other wood-destroying insects (WDI)	<input checked="" type="checkbox"/>	<input checked="" type="checkbox"/>
Previous treatment for termites or WDI	<input checked="" type="checkbox"/>	<input checked="" type="checkbox"/>
Previous termite or WDI damage repaired	<input checked="" type="checkbox"/>	<input checked="" type="checkbox"/>
Termite or WDI damage needing repair	<input checked="" type="checkbox"/>	<input checked="" type="checkbox"/>
Previous Use of Premises for Manufacture of Methamphetamine	<input checked="" type="checkbox"/>	<input checked="" type="checkbox"/>

(TAR-1406) 7-2-07

Initialed by: Seller: _____ and Buyer: _____

Concerning the Property at _____

409 N Hunt St
Bellville, Tx 77418

If the answer to any of the items in Section 3 is yes, explain (attach additional sheets if necessary): _____

Section 4. Are you (Seller) aware of any item, equipment, or system in or on the Property that is in need of repair, which has not been previously disclosed in this notice? ☐ yes ☐ no If yes, explain (attach additional sheets if necessary): _____

Section 5. Are you (Seller) aware of any of the following (Mark Yes (Y) if you are aware. Mark No (N) if you are not aware.)

- | Y | N | |
|--------------------------|-------------------------------------|--|
| <input type="checkbox"/> | <input checked="" type="checkbox"/> | Room additions, structural modifications, or other alterations or repairs made without necessary permits or not in compliance with building codes in effect at the time. |
| <input type="checkbox"/> | <input checked="" type="checkbox"/> | Homeowners' associations or maintenance fees or assessments. If yes, complete the following:
Name of association: _____
Manager's name: _____ Phone: _____
Fees or assessments are: \$ _____ per _____ and are: <input type="checkbox"/> mandatory <input type="checkbox"/> voluntary
Any unpaid fees or assessment for the Property? <input type="checkbox"/> yes (\$ _____) <input type="checkbox"/> no
If the Property is in more than one association, provide information about the other associations below or attach information to this notice. |
| <input type="checkbox"/> | <input checked="" type="checkbox"/> | Any common area (facilities such as pools, tennis courts, walkways, or other) co-owned in undivided interest with others. If yes, complete the following:
Any optional user fees for common facilities charged? <input type="checkbox"/> yes <input type="checkbox"/> no If yes, describe: _____
_____ |
| <input type="checkbox"/> | <input checked="" type="checkbox"/> | Any notices of violations of deed restrictions or governmental ordinances affecting the condition or use of the Property. |
| <input type="checkbox"/> | <input checked="" type="checkbox"/> | Any lawsuits or other legal proceedings directly or indirectly affecting the Property. |
| <input type="checkbox"/> | <input checked="" type="checkbox"/> | Any death on the Property except for those deaths caused by: natural causes, suicide, or accident unrelated to the condition of the Property. |
| <input type="checkbox"/> | <input checked="" type="checkbox"/> | Any condition on the Property which materially affects the health or safety of an individual. |
| <input type="checkbox"/> | <input checked="" type="checkbox"/> | Any repairs or treatments, other than routine maintenance, made to the Property to remediate environmental hazards such as asbestos, radon, lead-based paint, urea-formaldehyde, or mold.
If yes, attach any certificates or other documentation identifying the extent of the remediation (for example, certificate of mold remediation or other remediation). |

If the answer to any of the items in Section 5 is yes, explain (attach additional sheets if necessary): _____

Concerning the Property at _____

409 N Hunt St
Bellville, Tx 77418

Section 6. Seller ☐ has ☒ has not attached a survey of the Property.

Section 7. Within the last 4 years, have you (Seller) received any written inspection reports from persons who regularly provide inspections and who are either licensed as inspectors or otherwise permitted by law to perform inspections? ☐ yes ☐ no If yes, attach copies and complete the following:

Inspection Date	Type	Name of Inspector	No. of Pages

Note: A buyer should not rely on the above-cited reports as a reflection of the current condition of the Property. A buyer should obtain inspections from inspectors chosen by the buyer.

Section 8. Check any tax exemption(s) which you (Seller) currently claim for the Property:

- | | | |
|--|---|---|
| <input type="checkbox"/> Homestead | <input type="checkbox"/> Senior Citizen | <input type="checkbox"/> Disabled |
| <input type="checkbox"/> Wildlife Management | <input type="checkbox"/> Agricultural | <input type="checkbox"/> Disabled Veteran |
| <input type="checkbox"/> Other: _____ | | <input type="checkbox"/> Unknown |

Section 9. Have you (Seller) ever received proceeds for a claim for damage to the Property (for example, an insurance claim or a settlement or award in a legal proceeding) and not used the proceeds to make the repairs for which the claim was made? ☐ yes ☒ no If yes, explain: _____

Section 10. Does the property have working smoke detectors installed in accordance with the smoke detector requirements of Chapter 766 of the Health and Safety Code?* ☒ unknown ☐ no ☐ yes. If no or unknown, explain. (Attach additional sheets if necessary): _____

**Chapter 766 of the Health and Safety Code requires one-family or two-family dwellings to have working smoke detectors installed in accordance with the requirements of the building code in effect in the area in which the dwelling is located, including performance, location, and power source requirements. If you do not know the building code requirements in effect in your area, you may check unknown above or contact your local building official for more information.*

Seller acknowledges that the statements in this notice are true to the best of Seller's belief and that no person, including the broker(s), has instructed or influenced Seller to provide inaccurate information or to omit any material information.

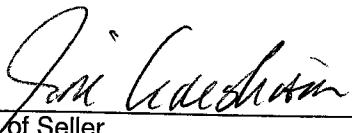
Signature of Seller
Printed Name: Jimmie D Grisham

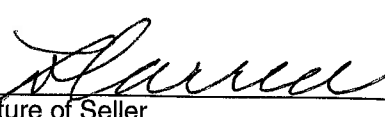
Date 8/14/08 Signature of Seller
Printed Name: Betty L Carrell

8-14-08
Date

Concerning the Property at _____

409 N Hunt St
Bellville, Tx 77418

ADDITIONAL NOTICES TO BUYER:

- (1) The Texas Department of Public Safety maintains a database that the public may search, at no cost, to determine if registered sex offenders are located in certain zip code areas. To search the database, visit www.txdps.state.tx.us. For information concerning past criminal activity in certain areas or neighborhoods, contact the local police department.
- (2) If the property is located in a coastal area that seaward of the Gulf Intracoastal Waterway or within 1,000 feet of the mean high tide bordering the Gulf of Mexico, the property may be subject to the Open Beaches Act or the Dune Protection Act (Chapter 61 or 63, Natural Resources Code, respectively) and a beachfront construction certificate or dune protection permit may be required for repairs or improvements. Contact the local government with ordinance authority over construction adjacent to public beaches for more information.
- (3) If you are basing your offers on square footage, measurements, or boundaries, you should have those items independently measured to verify any reported information.
- (4) The following providers currently provide service to the property:
- Electric: City of Bellville Sewer: SAME
- Water: SAME Cable: _____
- Trash: SAME Natural Gas: SAME
- Local Phone: _____ Propane: _____
- (5) This Seller's Disclosure Notice was completed by Seller as of the date signed. The brokers have relied on this notice as true and correct and have no reason to believe it to be false or inaccurate. YOU ARE ENCOURAGED TO HAVE AN INSPECTOR OF YOUR CHOICE INSPECT THE PROPERTY.

The undersigned Buyer acknowledges receipt of the foregoing notice and acknowledges the property complies with the smoke detector requirements of Chapter 766, Health and Safety Code, or, if the property does not comply with the smoke detector requirements of Chapter 766, the buyer waives the buyer's rights to have smoke detectors installed in compliance with Chapter 766.

Signature of Buyer _____	Date _____	Signature of Buyer _____	Date _____
Printed Name: _____		Printed Name: _____	



TEXAS ASSOCIATION OF REALTORS® SELLER'S DISCLOSURE NOTICE

©Texas Association of REALTORS®, Inc. 2007

Section 5.008, Property Code requires a seller of residential property of not more than one dwelling unit to deliver a Seller's Disclosure Notice to a buyer on or before the effective date of a contract. **This form complies with and contains additional disclosures which exceed the minimum disclosures required by the Code.**

apartment

CONCERNING THE PROPERTY AT 409 N Hunt St
Bellville, Tx 77418

THIS NOTICE IS A DISCLOSURE OF SELLER'S KNOWLEDGE OF THE CONDITION OF THE PROPERTY AS OF THE DATE SIGNED BY SELLER AND IS NOT A SUBSTITUTE FOR ANY INSPECTIONS OR WARRANTIES THE BUYER MAY WISH TO OBTAIN. IT IS NOT A WARRANTY OF ANY KIND BY SELLER, SELLER'S AGENTS, OR ANY OTHER AGENT.

Seller ☐ is ☐ is not occupying the Property. If unoccupied (by Seller), how long since Seller has occupied the Property?
☐ _____ or ☐ never occupied the Property

Section 1. The Property has the items marked below: (Mark Yes (Y), No (N), or Unknown (U).)

This notice does not establish the items to be conveyed. The contract will determine which items will & will not convey.

Item	Y	N	U
Cable TV Wiring			<input checked="" type="checkbox"/>
Carbon Monoxide Det.			<input checked="" type="checkbox"/>
Ceiling Fans	<input checked="" type="checkbox"/>		
Cooktop	<input checked="" type="checkbox"/>		
Dishwasher			<input checked="" type="checkbox"/>
Disposal			<input checked="" type="checkbox"/>
Emergency Escape Ladder(s)			<input checked="" type="checkbox"/>
Exhaust Fans	<input checked="" type="checkbox"/>		
Fences	<input checked="" type="checkbox"/>		
Fire Detection Equip.			<input checked="" type="checkbox"/>
French Drain			<input checked="" type="checkbox"/>
Gas Fixtures			<input checked="" type="checkbox"/>

Item	Y	N	U
Gas Lines (Nat/LP)			<input checked="" type="checkbox"/>
Hot Tub	<input checked="" type="checkbox"/>		
Intercom System			<input checked="" type="checkbox"/>
Microwave			<input checked="" type="checkbox"/>
Outdoor Grill	<input checked="" type="checkbox"/>		
Patio/Decking	<input checked="" type="checkbox"/>		
Plumbing System	<input checked="" type="checkbox"/>		
Pool			<input checked="" type="checkbox"/>
Pool Equipment			<input checked="" type="checkbox"/>
Pool Maint. Accessories			<input checked="" type="checkbox"/>
Pool Heater			<input checked="" type="checkbox"/>
Public Sewer System	<input checked="" type="checkbox"/>		

Item	Y	N	U
Pump: <input type="checkbox"/> sump <input type="checkbox"/> grinder			
Rain Gutters			<input checked="" type="checkbox"/>
Range/Stove	<input checked="" type="checkbox"/>		
Roof/Attic Vents			<input checked="" type="checkbox"/>
Sauna			<input checked="" type="checkbox"/>
Smoke Detector			<input checked="" type="checkbox"/>
Smoke Detector - Hearing Impaired			<input checked="" type="checkbox"/>
Spa			<input checked="" type="checkbox"/>
Trash Compactor			<input checked="" type="checkbox"/>
TV Antenna			<input checked="" type="checkbox"/>
Washer/Dryer Hookup	<input checked="" type="checkbox"/>		
Window Screens	<input checked="" type="checkbox"/>		

Item	Y	N	U	Additional Information
Central A/C			<input checked="" type="checkbox"/>	<input checked="" type="checkbox"/> electric <input type="checkbox"/> gas number of units: <u>1 electric</u>
Evaporative Coolers			<input checked="" type="checkbox"/>	number of units: <u>1</u>
Wall/Window AC Units	<input checked="" type="checkbox"/>			number of units: <u>5 stove</u>
Attic Fan(s)			<input checked="" type="checkbox"/>	if yes, describe: _____
Central Heat			<input checked="" type="checkbox"/>	<input type="checkbox"/> electric <input type="checkbox"/> gas number of units: _____
Other Heat			<input checked="" type="checkbox"/>	if yes, describe: _____
Oven	<input checked="" type="checkbox"/>			number of ovens: <u>1</u> <input checked="" type="checkbox"/> electric <input type="checkbox"/> gas <input type="checkbox"/> other: _____
Fireplace & Chimney			<input checked="" type="checkbox"/>	<input type="checkbox"/> wood <input type="checkbox"/> gas logs <input type="checkbox"/> mock <input type="checkbox"/> other: _____
Carport	<input checked="" type="checkbox"/>			<input type="checkbox"/> attached <input type="checkbox"/> not attached
Garage			<input checked="" type="checkbox"/>	<input type="checkbox"/> attached <input type="checkbox"/> not attached
Garage Door Openers			<input checked="" type="checkbox"/>	number of units: _____ number of remotes: _____
Satellite Dish & Controls			<input checked="" type="checkbox"/>	<input checked="" type="checkbox"/> owned <input type="checkbox"/> leased from _____
Security System			<input checked="" type="checkbox"/>	<input checked="" type="checkbox"/> owned <input type="checkbox"/> leased from _____
Water Heater	<input checked="" type="checkbox"/>			<input type="checkbox"/> electric <input type="checkbox"/> gas <input type="checkbox"/> other: _____ number of units: _____
Water Softener			<input checked="" type="checkbox"/>	<input type="checkbox"/> owned <input type="checkbox"/> leased from _____
Underground Lawn Sprinkler			<input checked="" type="checkbox"/>	<input type="checkbox"/> automatic <input type="checkbox"/> manual areas covered: _____
Septic / On-Site Sewer Facility	<input checked="" type="checkbox"/>			if yes, attach Information About On-Site Sewer Facility (TAR-1407)

(TAR-1406) 7-2-07

Initialed by: Seller: [Signature] and Buyer: [Signature]

Page 1 of 5

Concerning the Property at 409 N Hunt St
Bellville, Tx 77418

Water supply provided by: ☒ city ☐ well ☐ MUD ☐ co-op ☐ unknown ☐ other: _____

Was the Property built before 1978? ☒ yes ☐ no ☐ unknown

(If yes, complete, sign, and attach TAR-1906 concerning lead-based paint hazards).

Roof Type: composition Age: 10 (approximate)

Is there an overlay roof covering on the Property (shingles or roof covering placed over existing shingles or roof covering)?
☐ yes ☒ no ☐ unknown

Are you (Seller) aware of any of the items listed in this Section 1 that are not in working condition, that have defects, or are need of repair? ☐ yes ☒ no If yes, describe (attach additional sheets if necessary): _____

Section 2. Are you (Seller) aware of any defects or malfunctions in any of the following?: (Mark Yes (Y) if you are aware and No (N) if you are not aware.)

Item	Y	N
Basement		<input checked="" type="checkbox"/>
Ceilings		<input checked="" type="checkbox"/>
Doors		<input checked="" type="checkbox"/>
Driveways		<input checked="" type="checkbox"/>
Electrical Systems		<input checked="" type="checkbox"/>
Exterior Walls		<input checked="" type="checkbox"/>

Item	Y	N
Floors		<input checked="" type="checkbox"/>
Foundation / Slab(s)		<input checked="" type="checkbox"/>
Interior Walls		<input checked="" type="checkbox"/>
Lighting Fixtures		<input checked="" type="checkbox"/>
Plumbing Systems		<input checked="" type="checkbox"/>
Roof		<input checked="" type="checkbox"/>

Item	Y	N
Sidewalks		<input checked="" type="checkbox"/>
Walls / Fences		<input checked="" type="checkbox"/>
Windows		<input checked="" type="checkbox"/>
Other Structural Components		<input checked="" type="checkbox"/>

If the answer to any of the items in Section 2 is yes, explain (attach additional sheets if necessary): _____

Section 3. Are you (Seller) aware of any of the following conditions: (Mark Yes (Y) if you are aware and No (N) if you are not aware.)

Condition	Y	N
Aluminum Wiring		<input checked="" type="checkbox"/>
Asbestos Components		<input checked="" type="checkbox"/>
Diseased Trees: <input type="checkbox"/> oak wilt <input type="checkbox"/> _____		<input checked="" type="checkbox"/>
Endangered Species/Habitat on Property		<input checked="" type="checkbox"/>
Fault Lines		<input checked="" type="checkbox"/>
Hazardous or Toxic Waste		<input checked="" type="checkbox"/>
Improper Drainage		<input checked="" type="checkbox"/>
Intermittent or Weather Springs		<input checked="" type="checkbox"/>
Landfill		<input checked="" type="checkbox"/>
Lead-Based Paint or Lead-Based Pt. Hazards		<input checked="" type="checkbox"/>
Encroachments onto the Property		<input checked="" type="checkbox"/>
Improvements encroaching on others' property		<input checked="" type="checkbox"/>
Located in 100-year Floodplain		<input checked="" type="checkbox"/>
Present Flood Insurance Coverage (If yes, attach TAR-1414)	<input checked="" type="checkbox"/>	
Previous Flooding into the Structures		<input checked="" type="checkbox"/>
Previous Flooding onto the Property		<input checked="" type="checkbox"/>
Previous Fires		<input checked="" type="checkbox"/>
Previous Foundation Repairs		<input checked="" type="checkbox"/>

Condition	Y	N
Previous Roof Repairs		<input checked="" type="checkbox"/>
Other Structural Repairs		<input checked="" type="checkbox"/>
Radon Gas		<input checked="" type="checkbox"/>
Settling		<input checked="" type="checkbox"/>
Soil Movement		<input checked="" type="checkbox"/>
Subsurface Structure or Pits		<input checked="" type="checkbox"/>
Underground Storage Tanks		<input checked="" type="checkbox"/>
Unplatted Easements		<input checked="" type="checkbox"/>
Unrecorded Easements		<input checked="" type="checkbox"/>
Urea-formaldehyde Insulation		<input checked="" type="checkbox"/>
Water Penetration		<input checked="" type="checkbox"/>
Wetlands on Property		<input checked="" type="checkbox"/>
Wood Rot		<input checked="" type="checkbox"/>
Active infestation of termites or other wood-destroying insects (WDI)		<input checked="" type="checkbox"/>
Previous treatment for termites or WDI	<input checked="" type="checkbox"/>	
Previous termite or WDI damage repaired	<input checked="" type="checkbox"/>	
Termite or WDI damage needing repair		<input checked="" type="checkbox"/>
Previous Use of Premises for Manufacture of Methamphetamine		<input checked="" type="checkbox"/>

Concerning the Property at 409 N Hunt St
Bellville, Tx 77418

If the answer to any of the items in Section 3 is yes, explain (attach additional sheets if necessary): _____

Section 4. Are you (Seller) aware of any item, equipment, or system in or on the Property that is in need of repair, which has not been previously disclosed in this notice? ☐ yes ☒ no If yes, explain (attach additional sheets if necessary): _____

Section 5. Are you (Seller) aware of any of the following (Mark Yes (Y) if you are aware. Mark No (N) if you are not aware.)

- | <u>Y</u> | <u>N</u> | |
|--------------------------|-------------------------------------|--|
| <input type="checkbox"/> | <input checked="" type="checkbox"/> | Room additions, structural modifications, or other alterations or repairs made without necessary permits or not in compliance with building codes in effect at the time. |
| <input type="checkbox"/> | <input checked="" type="checkbox"/> | Homeowners' associations or maintenance fees or assessments. If yes, complete the following:
Name of association: _____
Manager's name: _____ Phone: _____
Fees or assessments are: \$ _____ per _____ and are: <input type="checkbox"/> mandatory <input type="checkbox"/> voluntary
Any unpaid fees or assessment for the Property? <input type="checkbox"/> yes (\$ _____) <input type="checkbox"/> no
If the Property is in more than one association, provide information about the other associations below or attach information to this notice. |
| <input type="checkbox"/> | <input checked="" type="checkbox"/> | Any common area (facilities such as pools, tennis courts, walkways, or other) co-owned in undivided interest with others. If yes, complete the following:
Any optional user fees for common facilities charged? <input type="checkbox"/> yes <input type="checkbox"/> no If yes, describe: _____ |
| <input type="checkbox"/> | <input checked="" type="checkbox"/> | Any notices of violations of deed restrictions or governmental ordinances affecting the condition or use of the Property. |
| <input type="checkbox"/> | <input checked="" type="checkbox"/> | Any lawsuits or other legal proceedings directly or indirectly affecting the Property. |
| <input type="checkbox"/> | <input checked="" type="checkbox"/> | Any death on the Property except for those deaths caused by: natural causes, suicide, or accident unrelated to the condition of the Property. |
| <input type="checkbox"/> | <input checked="" type="checkbox"/> | Any condition on the Property which materially affects the health or safety of an individual. |
| <input type="checkbox"/> | <input checked="" type="checkbox"/> | Any repairs or treatments, other than routine maintenance, made to the Property to remediate environmental hazards such as asbestos, radon, lead-based paint, urea-formaldehyde, or mold.
If yes, attach any certificates or other documentation identifying the extent of the remediation (for example, certificate of mold remediation or other remediation). |

If the answer to any of the items in Section 5 is yes, explain (attach additional sheets if necessary): _____

Concerning the Property at _____

409 N Hunt St
Bellville, Tx 77418

Section 6. Seller ☐ has ☐ has not attached a survey of the Property.

Section 7. Within the last 4 years, have you (Seller) received any written inspection reports from persons who regularly provide inspections and who are either licensed as inspectors or otherwise permitted by law to perform inspections? ☐ yes ☒ no If yes, attach copies and complete the following:

Inspection Date	Type	Name of Inspector	No. of Pages

Note: A buyer should not rely on the above-cited reports as a reflection of the current condition of the Property. A buyer should obtain inspections from inspectors chosen by the buyer.

Section 8. Check any tax exemption(s) which you (Seller) currently claim for the Property:

- | | | |
|--|---|---|
| <input type="checkbox"/> Homestead | <input type="checkbox"/> Senior Citizen | <input type="checkbox"/> Disabled |
| <input type="checkbox"/> Wildlife Management | <input type="checkbox"/> Agricultural | <input type="checkbox"/> Disabled Veteran |
| <input type="checkbox"/> Other: _____ | | <input type="checkbox"/> Unknown |

Section 9. Have you (Seller) ever received proceeds for a claim for damage to the Property (for example, an insurance claim or a settlement or award in a legal proceeding) and not used the proceeds to make the repairs for which the claim was made? ☐ yes ☒ no If yes, explain: _____

Section 10. Does the property have working smoke detectors installed in accordance with the smoke detector requirements of Chapter 766 of the Health and Safety Code?* ☐ unknown ☒ no ☐ yes. If no or unknown, explain. (Attach additional sheets if necessary): _____

**Chapter 766 of the Health and Safety Code requires one-family or two-family dwellings to have working smoke detectors installed in accordance with the requirements of the building code in effect in the area in which the dwelling is located, including performance, location, and power source requirements. If you do not know the building code requirements in effect in your area, you may check unknown above or contact your local building official for more information.*

Seller acknowledges that the statements in this notice are true to the best of Seller's belief and that no person, including the broker(s), has instructed or influenced Seller to provide inaccurate information or to omit any material information.

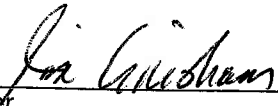
Signature of Seller  Date 8/14/08
Printed Name: Jimmie D Grisham

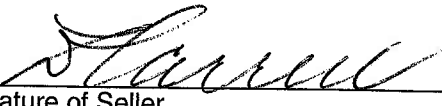
Signature of Seller  Date 8/14/08
Printed Name: Betty L Carrell



Concerning the Property at _____

409 N Hunt St
Bellville, Tx 77418

ADDITIONAL NOTICES TO BUYER:

- (1) The Texas Department of Public Safety maintains a database that the public may search, at no cost, to determine if registered sex offenders are located in certain zip code areas. To search the database, visit www.txdps.state.tx.us. For information concerning past criminal activity in certain areas or neighborhoods, contact the local police department.
- (2) If the property is located in a coastal area that seaward of the Gulf Intracoastal Waterway or within 1,000 feet of the mean high tide bordering the Gulf of Mexico, the property may be subject to the Open Beaches Act or the Dune Protection Act (Chapter 61 or 63, Natural Resources Code, respectively) and a beachfront construction certificate or dune protection permit may be required for repairs or improvements. Contact the local government with ordinance authority over construction adjacent to public beaches for more information.
- (3) If you are basing your offers on square footage, measurements, or boundaries, you should have those items independently measured to verify any reported information.
- (4) The following providers currently provide service to the property:
- Electric: City of Bellville Sewer: City of Bellville
Water: _____ Cable: _____
Trash: _____ Natural Gas: _____
Local Phone: _____ Propane: _____
- (5) This Seller's Disclosure Notice was completed by Seller as of the date signed. The brokers have relied on this notice as true and correct and have no reason to believe it to be false or inaccurate. YOU ARE ENCOURAGED TO HAVE AN INSPECTOR OF YOUR CHOICE INSPECT THE PROPERTY.

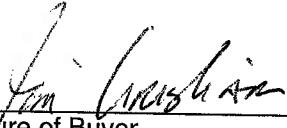
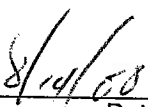
The undersigned Buyer acknowledges receipt of the foregoing notice and acknowledges the property complies with the smoke detector requirements of Chapter 766, Health and Safety Code, or, if the property does not comply with the smoke detector requirements of Chapter 766, the buyer waives the buyer's rights to have smoke detectors installed in compliance with Chapter 766.

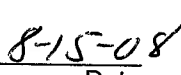
			
Signature of Buyer	Date	Signature of Buyer	Date
Printed Name: _____		Printed Name: _____	

Texas law requires all real estate licensees to give the following information about brokerage services to prospective buyers, tenants, sellers and landlords.

Information About Brokerage Services

Before working with a real estate broker, you should know that the duties of a broker depend on whom the broker represents. If you are a prospective seller or landlord (owner) or a prospective buyer or tenant (buyer), you should know that the broker who lists the property for sale or lease is the owner's agent. A broker who acts as a subagent represents the owner in cooperation with the listing broker. A broker who acts as a buyer's agent represents the buyer. A broker may act as an intermediary between the parties if the parties consent in writing. A broker can assist you in locating a property, preparing a contract or lease, or obtaining financing without representing you. A broker is obligated by law to treat you honestly.

IF THE BROKER REPRESENTS THE OWNER:

The broker becomes the owner's agent by entering into an agreement with the owner, usually through a written - listing agreement, or by agreeing to act as a subagent by accepting an offer of subagency from the listing broker. A subagent may work in a different real estate office. A listing broker or subagent can assist the buyer but does not represent the buyer and must place the interests of the owner first. The buyer should not tell the owner's agent anything the buyer would not want the owner to know because an owner's agent must disclose to the owner any material information known to the agent.

IF THE BROKER REPRESENTS THE BUYER:

The broker becomes the buyer's agent by entering into an agreement to represent the buyer, usually through a written buyer representation agreement. A buyer's agent can assist the owner but does not represent the owner and must place the interests of the buyer first. The owner should not tell a buyer's agent anything the owner would not want the buyer to know because a buyer's agent must disclose to the buyer any material information known to the agent.

IF THE BROKER ACTS AS AN INTERMEDIARY:

A broker may act as an intermediary between the parties if the broker complies with The Texas Real Estate License

Act. The broker must obtain the written consent of each party to the transaction to act as an intermediary. The written consent must state who will pay the broker and, in conspicuous bold or underlined print, set forth the broker's obligations as an intermediary. The broker is required to treat each party honestly and fairly and to comply with The Texas Real Estate License Act. A broker who acts as an intermediary in a transaction:

(1) shall treat all parties honestly;

(2) may not disclose that the owner will accept a price less than the asking price unless authorized in writing to do so by the owner;

(3) may not disclose that the buyer will pay a price greater than the price submitted in a written offer unless authorized in writing to do so by the buyer; and

(4) may not disclose any confidential information or any information that a party specifically instructs the broker in writing not to disclose unless authorized in writing to disclose the information or required to do so by The Texas Real Estate License Act or a court order or if the information materially relates to the condition of the property.

With the parties' consent, a broker acting as an intermediary between the parties may appoint a person who is licensed under The Texas Real Estate License Act and associated with the broker to communicate with and carry out instructions of one party and another person who is licensed under that Act and associated with the broker to communicate with and carry out instructions of the other party.

If you choose to have a broker represent you, you should enter into a written agreement with the broker that clearly establishes the broker's obligations and your obligations. The agreement should state how and by whom the broker will be paid. You have the right to choose the type of representation, if any, you wish to receive. Your payment of a fee to a broker does not necessarily establish that the broker represents you. If you have any questions regarding the duties and responsibilities of the broker, you should resolve those questions before proceeding.

* **Bill Johnson and Associates Real Estate Company will represent the Seller-Owner in all real estate sales transactions, unless prior provisions with the Buyer have been agreed to and acknowledged in writing by all parties.**

** **If you wish to be represented by a Buyer's Agent, please notify the Bill Johnson and Associates Real Estate Company sales agent with whom you are working, prior to looking at any properties.**

Real estate licensee asks that you acknowledge receipt of this information about brokerage services for the licensee's records.

Buyer, Seller, Landlord or Tenant

Date

Texas Real Estate Brokers and Salespersons are licensed and regulated by the Texas Real Estate Commission (TREC). If you have a question or complaint regarding a real estate licensee, you should contact TREC at P.O. Box 12188, Austin, Texas 78711-2188 or 512-465-3960.



01A

TREC No. OP-K

Bill Johnson & Associates Real Estate 420 E. Main St., Bellville TX 77418
Phone: 979-865-5466

Fax: 979-865-5500

Bill Johnson and Associates Re

Produced with ZipForm™ by RE FormsNet, LLC 18025 Fifteen Mile Road, Clinton Township, Michigan 48035, (800) 383-9805

T5445687.ZFX