

# LAND FOR SALE

## North Platte Valley Ranchette



**Location:**

2 miles east of North Platte, Nebraska on Hwy 30, then north on North Airport Road across rail-road tracks, east one mile on East Long School Road, north 1 mile on North Long School Road.

**Legal Description:**

N1/2N1/2NE1/4 Section 31-T14N-R29W of the 6th P.M., Lincoln County, Nebraska.

**Acres:**

39.75 Tax Assessed Acres

**Taxes:**

2016 taxes payable in 2017 - \$6,002.52

**Land Use:**

There are 35 acres of hay meadow and pasture with a pond and excellent tree row along the north edge of the property for winter protection.

**Improvements:**

3,169 sq. ft. brick home with 3 1/2 car attached garage (1,288 sq. ft.). Home has 3 bedrooms, 2 1/2 bathrooms with heated tile floors, walk-in closets, 23X24' family room with wood-burning stove, 21X28' formal living room with fireplace, dining room, open kitchen with island and utility room.

Outside is an 800 sq. ft. enclosed patio, greenhouse, storage shed, 36X12X10' heated barn with 3 horse stalls and a 24X12X10' open front shed.

**Price:**

**\$500,000**

**Comments:**

This is a beautiful home with an excellent view of the Platte River Valley and it abounds with turkey, deer, ducks and geese. Current owners have been running 4 horses with plenty of grass left over from year-round grazing.

**Showing by appointment only**

**Contact:**

**Mike Polk; Listing Agent 308-539-4446 or [mike@agriaffiliates.com](mailto:mike@agriaffiliates.com)**

John Childears, Bruce Dodson, Don Walker, Chase Dodson,  
Brian Reynolds, Tony Eggleston, Brad Atkins



**Mike Polk,**  
*Listing Agent*

**Agri Affiliates—Providing Farm, Ranch Real Estate Services**

*Offered Exclusively By:*

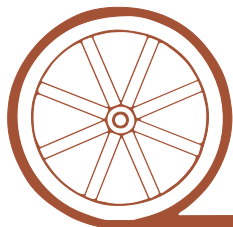

# AGRI AFFILIATES, INC.

***...Providing Farm - Ranch Real Estate Services...***

**NORTH PLATTE OFFICE**

P.O. Box 1166

I-80 & US Hwy 83

North Platte, NE 69103

[www.agriaffiliates.com](http://www.agriaffiliates.com)

**(308) 534-9240**

Fax (308) 534-9244

Information contained herein was obtained from sources deemed reliable. We have no reason to doubt the accuracy, but the information is not guaranteed. Prospective Buyers should verify all information. All maps provided by Agri Affiliates, Inc. are approximations only, to be used as a general guideline, and not intended as survey accurate. As with any agricultural land, this property may include noxious weeds. Agri Affiliates, Inc. and all agents are acting as Agent of the Seller.

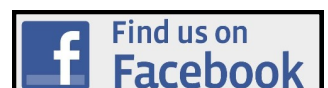





**Family Room**



**Living Room**



**Kitchen**



**Dining Room**



**Master Bedroom**

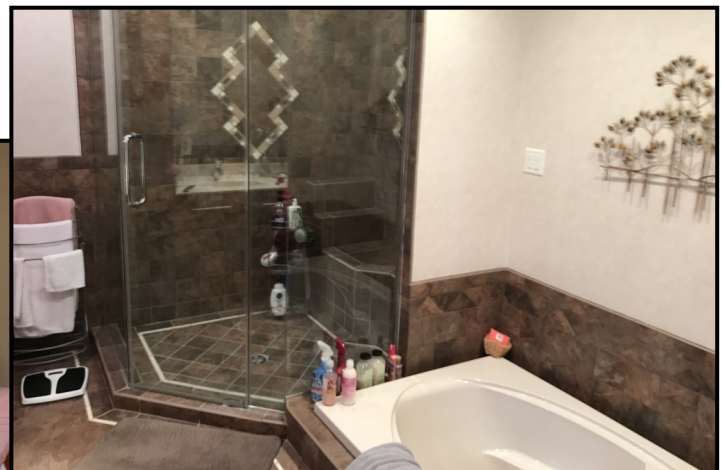

**Master Bath**



**Patio**



**3 1/2 Car Attached Garage**



**Barn with 3 horse stalls**



**Garden Shed & Greenhouse**



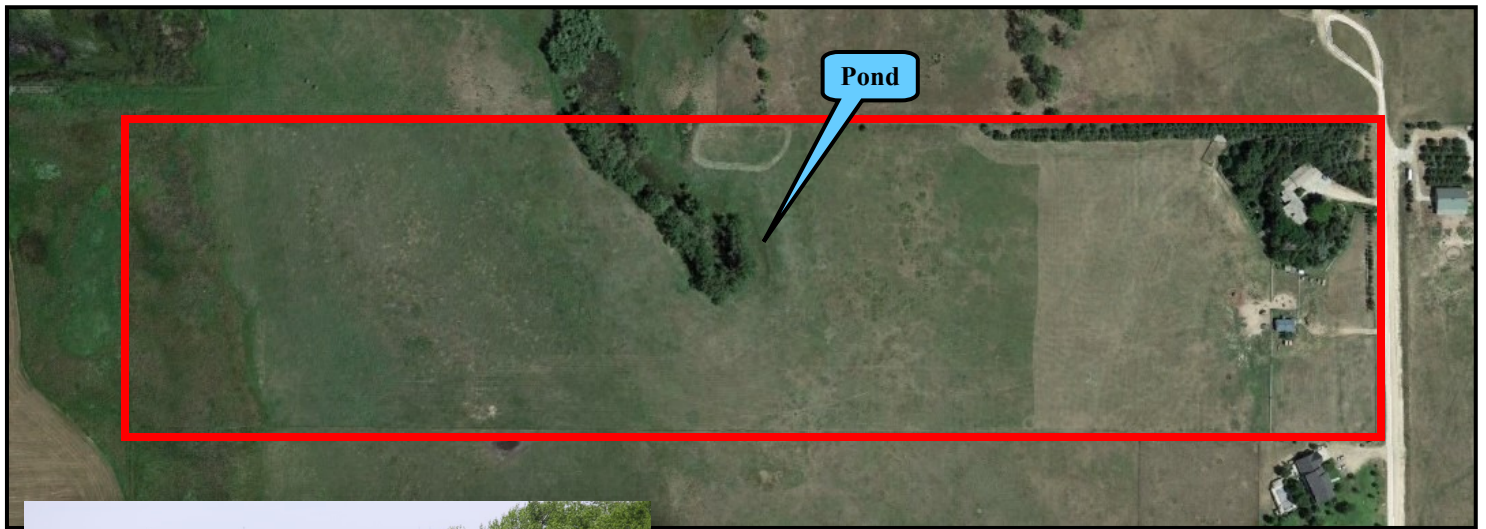
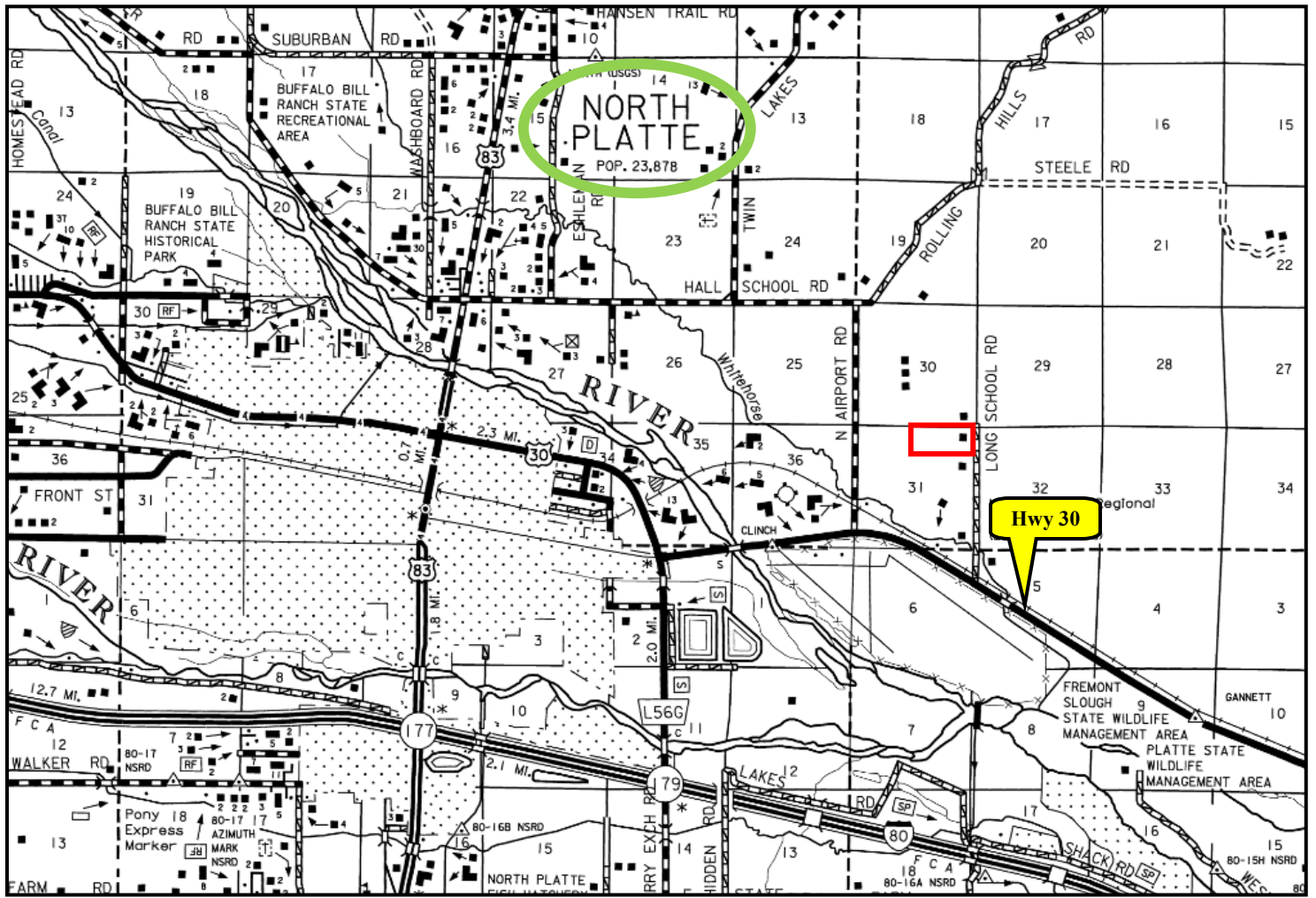

 **AGRI AFFILIATES, INC.**  
...Providing Farm - Ranch Real Estate Services...