

*TARRANT REGIONAL WATER DISTRICT*

*140 FM 416, Streetman, Texas 75859  
903-389-3928*

*AUTHORIZATION TO CONSTRUCT  
AN  
ON-SITE SEWAGE FACILITY*

Application Number      RC 050333  
Property Owner           Neil B. Barstow  
Mailing Address           P.O. Box 1516  
                                 Corsicana, Texas 75109  
Property Location        Lot 34 Starcrest Estates  
                                 Navarro County, Texas

This serves to notify all persons that an on-site sewerage facility application, related technical data, and the appropriate fee have been received by the Tarrant Regional Water District (District) from the property owner. The application has been reviewed for technical and administrative consideration against the standards set forth by the District. Approval is hereby granted for the construction as shown on the submitted plans.

Any modifications to submitted plans require approval by the Tarrant Regional Water District prior to installation.

You or your installer must contact the District office at 903-389-3928 between 7:30 A.M. to 8:30 A.M. to arrange for the required facility inspection. Calls after 8:30 A.M. may result in inspection being delayed until the next working day. The authorization to construct is valid for one year from the date of issue of an application. If a final inspection has not been performed within one year of issue, a new application and fee will be required.

Comments: The following design is based upon the minimum standards set forth by the Texas Natural Resource Conservation Commission and is based on a maximum daily flow of 420 gallons, the use of water saving devices is required.

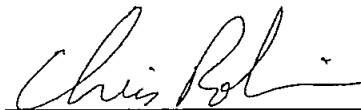
  
\_\_\_\_\_  
Authorized District Representative

OS-8058

\_\_\_\_\_  
Date

05-19-03

## TARRANT REGIONAL WATER DISTRICT

140 FM 416, Streetman, Texas 75859

903-389-3928

Fax # 903-389-7587

## TRWD USE ONLY

RC050333

APPLICATION NO.

4223

RECEIPT NO.

5-2-03

DATE

200. 1

AMOUNT

APPLICATION FOR ON-SITE  
SEWAGE FACILITY

Richland - Chambers

TRWD RESERVOIR

Navarro

COUNTY OF INSTALLATION

1. PROPERTY OWNER'S NAME: Barstow Neil B.  
(LAST) (FIRST) (MIDDLE)
2. PERMANENT MAILING ADDRESS: PO Box 1516 Corsicana TX 75151  
(STREET/PO BOX) (CITY/STATE) (ZIP)
3. TELEPHONE NO. DURING DAY: 903 874 3995 ..
4. SITE ADDRESS: Moonlight Dr. Corsicana TX 75109  
(STREET) (CITY/STATE) (ZIP)
5. PROPERTY DESCRIPTION: LOT NO. 34 BLOCK — SEC — SIZE — SQ. FT.  
SUBDIVISION: Starcrest Estates Acreage — Survey —
6. SOURCE OF WATER: Private Well ☒ Public Water Supply M.E.N.  
(NAME OF SUPPLIER)
7. SINGLE FAMILY RESIDENCE: No. of Bedrooms 1 Living Area (sq. ft.) 4700  
DESIGNED MAXIMUM DAILY WATER CONSUMPTION (gpd): 420
8. COMMERCIAL/INSTITUTIONAL (including multi-family residences) TYPE: N/A  
NO. OF EMPLOYEES/OCCUPANTS/UNITS: 2/2 DAYS OCCUPIED PER WEEK: 2/2  
DESIGNED MAXIMUM DAILY WATER CONSUMPTION (gpd): 2/2
9. IS AN ORGANIZED SEWAGE COLLECTION WITHIN 300 FEET? Yes ☒ No
10. DESIGNER: William W. Hill LICENSE NO.: 1361  
PHONE NO.: 903 874 3945
11. INSTALLER: Rod Pickle REGISTRATION NO.: 057305  
PHONE NO.: 903 729 9911

I certify that the above statements are true and correct to the best of my knowledge. Authorization is hereby given to the Tarrant Regional Water District to enter upon the above described private property for the purpose of lot evaluation and inspection of on-site sewerage facilities. I understand that the approval of this application constitutes authorization for construction of the on-site sewerage facility and that a permit to operate the facility will be granted following successful inspection of the installed system which indicates that the system was installed in compliance with TNRCC's On-Site Sewage Facility Rules (OSSF) and the District's Waste Control Order.

(SIGNATURE OF OWNER)

Charlotte Smith

(SIGNATURE OF AUTHORIZED DISTRICT REPRESENTATIVE)

(DATE)

8 Apr. '03

5-2-03

(DATE)



# BUILDING PERMIT

COUNTY OF NAVARRO, TEXAS

No 0709

JOB ADDRESS		406 Moonlight Dr. 75109		APPLICANT ADDRESS
LOT NO. 34	BLK.	SUBDIVISION Starcrest Estates 903-		
OWNER Neil & Belinda Barstow	ADDRESS P.O. Box 1516 Corvum	PHONE 751-5134	824-3495	
CONTRACTOR Helton Construction	ADDRESS 369 Stonewall Dr.	PHONE 903-389-4244	758-59	
ELECTRICAL sub	ADDRESS	PHONE		
PLUMBING sub	ADDRESS	PHONE		
MECHANICAL sub	ADDRESS	PHONE		
USE OF BUILDING Residential				
CLASS OF WORK: <input checked="" type="checkbox"/> NEW <input type="checkbox"/> ADDITION <input type="checkbox"/> ALTERATION <input type="checkbox"/> REPAIR <input type="checkbox"/> DEMOLISH				
DESCRIBE WORK: build new home				
TYPE OF CONST. brick	SQ. FT. 4750'	NO. OF STORIES 2		
NO. OF ROOMS 4 BR	NO. OF BATHS 3	FOUNDATION Blahonpier		
ROOF Comp.	SPRINKLERS REQUIRED	PARKING SPACES		
NO. OF DWELLING UNITS 1	ZONING SF	OCCUPANCY GROUP SF		
NOTICE		I HEREBY CERTIFY THAT I HAVE READ AND EXAMINED THIS APPLICATION AND KNOW THE SAME TO BE TRUE AND CORRECT. ALL PROVISIONS OF LAWS AND ORDINANCES GOVERNING THIS TYPE OF WORK WILL BE COMPLIED WITH WHETHER SPECIFIED HEREIN OR NOT. THE GRANTING OF A PERMIT DOES NOT PRESUME TO GIVE AUTHORITY TO VIOLATE OR CANCEL THE PROVISIONS OF ANY OTHER STATE OR LOCAL LAW REGULATING CONSTRUCTION OR THE PERFORMANCE OF CONSTRUCTION.		
THIS PERMIT BECOMES NULL AND VOID IF WORK OR CONSTRUCTION AUTHORIZED IS NOT COMMENCED WITHIN 6 MONTHS, OR IF CONSTRUCTION OR WORK IS SUSPENDED OR ABANDONED FOR A PERIOD OF 1 YEAR AT ANY TIME AFTER WORK IS COMMENCED.		SIGNATURE: Neil B. Barstow		
THE ISSUANCE OF THIS PERMIT SHOULD NOT BE CONSTRUED BY ANY PERSON AS AN APPROVAL OF BUILDING OR CONSTRUCTION TECHNIQUES, METHODS, OR MATERIALS.		VALUATION: \$362,350.00 PERMIT FEE \$639.60		
		APPROVED FOR ISSUANCE BY: Dick Lennon DATE 10-18-02		
SPECIAL CONDITIONS:				
THIS BECOMES YOUR PERMIT WHEN APPROVED FOR ISSUANCE				

# **ON-SITE SEWAGE FACILITY SOIL SURVEY REPORT INFORMATION**

Property Owner's Name Neil Barstow

Mailing Address PO Box 1516

City, State, Zip Corsicana, TX. 75151

Site Location Starcrest Estates; Lot #34

County Navarro

(FOR HOLE #1)

DEPTH	TEXTURE	CLASS	STRUCTURE	WATER TABLE	SLOPE 0-30%	* SOIL SERIES	* SOIL ABSORPTION
in.	i.e. Loamy Sand, Sandy Loam, Loam, Silty Clay Loam, Sandy Clay, or Clay.	per USDA Chart i.e. Ia, Ib, II, III, or IV	Only if soil is a Class III i.e. Blocky, Platy, or Massive	PRESENT Yes / No	Maximum of overall drainfield	per County Soil Survey i.e. "Bowie"	LIMITATION RATING i.e. Fair, Moderate, Severe
00 - 12	Sandy Clay	III		No	10.20%		Moderate
12 - 36	Gr. Clay	IV					Severe

\* This can be found in the County Soil Survey entitled "Sanitary Facilities" (optional)

THE MOST RESTRICTIVE SOIL CLASS FOUND ONE FOOT BELOW THE DEPTH OF THE PROPOSED INSTALLATION IS: CLASS IV [Note Class Ia & IV are unsuitable for standard disposal systems]

(FOR HOLE #2)

DEPTH	TEXTURE	CLASS	STRUCTURE	WATER TABLE	SLOPE 0-30%	* SOIL SERIES	* SOIL ABSORPTION
in.	i.e. Loamy Sand, Sandy Loam, Loam, Silty Clay Loam, Sandy Clay, or Clay.	per USDA Chart i.e. Ia, Ib, II, III, or IV	Only if soil is a Class III i.e. Blocky, Platy, or Massive	PRESENT Yes / No	Maximum of overall drainfield	per County Soil Survey i.e. "Bowie"	LIMITATION RATING i.e. Fair, Moderate, Severe
00 - 36	Gr. Clay	IV		No	10.20%		Severe

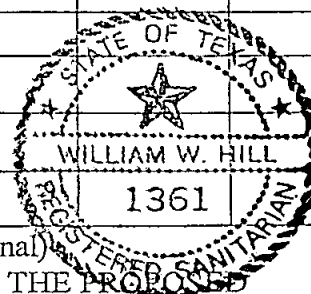

\* This can be found in the County Soil Survey entitled "Sanitary Facilities" (optional)

THE MOST RESTRICTIVE SOIL CLASS FOUND WITHIN THE DEPTH OF THE PROPOSED INSTALLATION IS: CLASS IV [Note: Class Ia & IV are unsuitable for standard disposal systems]

EVALUATION PERFORMED BY: William Hill Registered Sanitarian.  
DATE OF SOIL SURVEY: 08 April 2003 CERTIFICATION NO: OS7622

Neil Barstow  
 Starcrest Estates  
 Lot #34

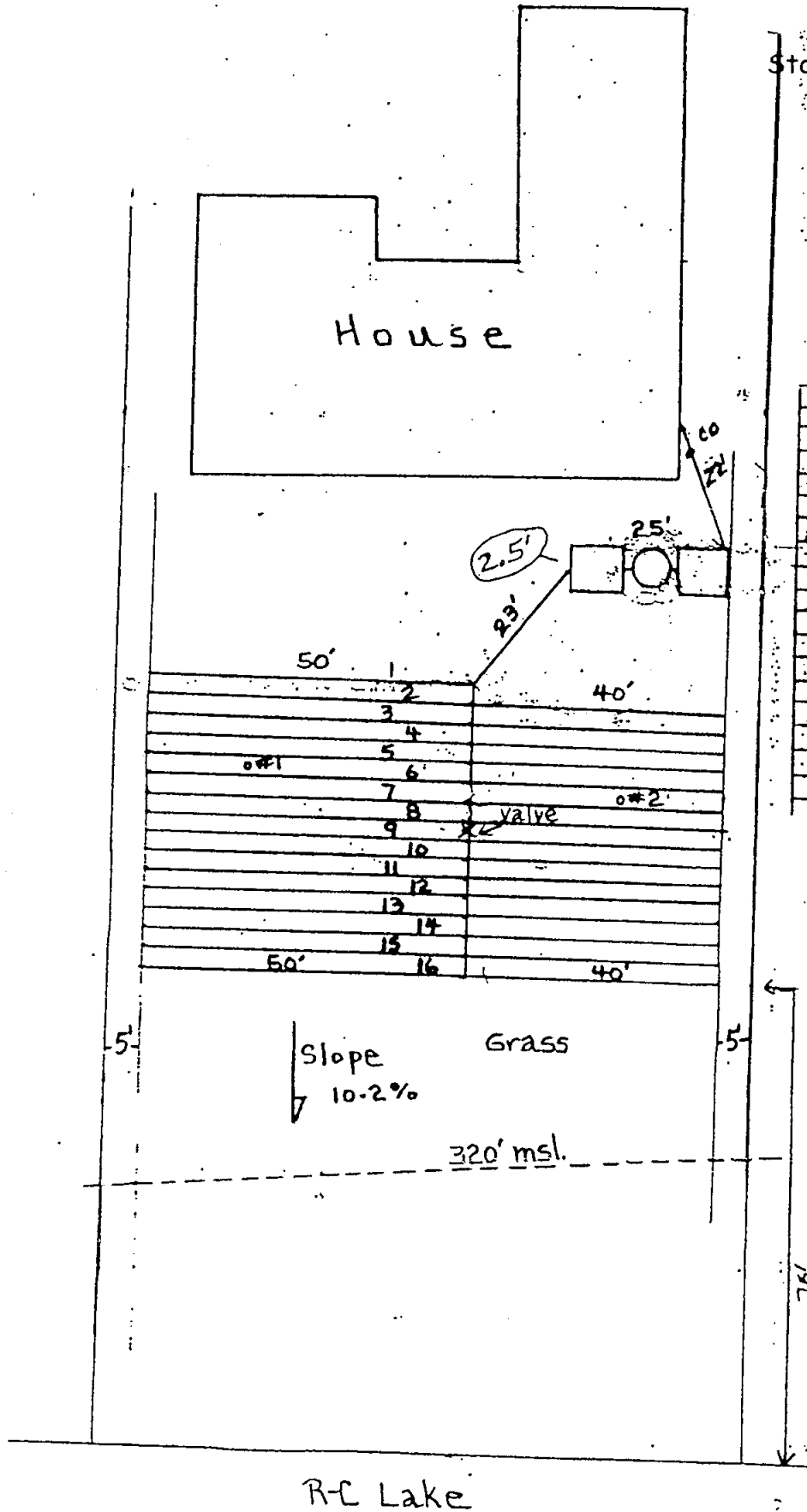

No.	Elevations		
	E	S	A
1	4.5	4.0	
2	4.7	4.4	4.0
3	5.0	4.7	4.3
4	5.2	5.0	4.7
5	5.5	5.5	5.1
6	5.8	5.8	5.2
7	6.1	6.1	5.6
8	6.4	6.5	5.9
9	6.8	6.8	6.3
10	7.1	7.2	6.6
11	7.3	7.3	6.8
12	7.6	7.6	7.1
13	7.7	7.8	7.5
14	7.9	8.1	7.7
15	8.1	8.2	7.8
16	8.4	8.6	8.0

*William Hill*  
 17 Apr. '03

STATE OF TEXAS  
 WILLIAM W. HILL  
 1361  
 REGISTERED SANITARIAN

# Neil Barstow \* Starcrest Estates \* Lot 34

Daily Waste Flow	420 gal./day
Septic Tank Size	1250 gal.
Pumping Tank Size	500 gal.
Effluent Loading Rate	0.1 gal./ sq. ft./day
Absorption Area	4200, sq. ft.
Total Length of laterals	1400 ft.
Lateral Diameter	1 in. sch. 40
Lateral Configuration	see attached diagram
Supply Line Length	68 ft.
Supply Line Diameter	2 in. sch. 40
Manifold Placement	40 - 50
Hole Size	1/8 in.
Hole Spacing	see attached chart
Number of Holes	203
Flow per Hole	see attached chart
Total Flow + 2 GPM ASH	57.0 GPM
Elevation Head	5.0 ft.
Friction Head	5.5 ft.
Pressure Head	1.5 ft.
Total Head	12.0 ft. - 6.1' = 5.9'
Pump Requirements	57 gpm. @ 5.9 ft. head
Suggested Pumps	Little Giant 9S 4/10 HP
Storage Volume in Laterals	57.4 gal.
Storage Volume in Supply	11.0 gal.
Total Storage	68.4 gal.
Dosing Volume	139.2 170.8 gal.
Dosing Depth	11 13.5 in.
Check Valve Needed?	NO
Anti-Siphon Hole Needed?	YES
Approximate Quantity of Rock	35 yds.
Effluent Filter Recommended Zabel A1800	YES

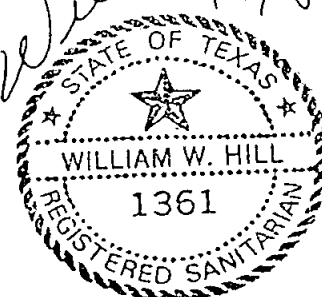

**Neil Barstow \* Starcrest Estates \* Lot 34**

Level or Zone	Line Number	*Depth (In.)	Pressure Head (ft.)	Length (ft.)	Number Holes	Hole Size	FLOW GPM/hole	RATE GPM/line	GPM/ft.-line	Hole Spacing (ft.)
1A	1	18	1.5	50	9	0 1/8	0.22	1.98	0.04	5.5
1A	2	18	1.5	90	16	0 1/8	0.22	3.52	0.039	5.6
1B	3	18	2	90	14	0 1/8	0.26	3.64	0.04	6.4
1B	4	18	2	90	14	0 1/8	0.26	3.64	0.04	6.4
1C	5	18	2.5	90	12	0 1/8	0.29	3.48	0.039	7.5
1D	6	18	3	90	11	0 1/8	0.32	3.52	0.039	8.2
1D	7	18	3	90	11	0 1/8	0.32	3.52	0.039	8.2
1E	8	18	3.5	90	10	0 1/8	0.345	3.45	0.038	9
2A	9	18	1.5	90	16	0 1/8	0.22	3.52	0.039	5.6
2A	10	18	1.5	90	16	0 1/8	0.22	3.52	0.039	5.6
2B	11	18	2	90	14	0 1/8	0.26	3.64	0.04	6.4
2B	12	18	2	90	14	0 1/8	0.26	3.64	0.04	6.4
2C	13	18	2.5	90	12	0 1/8	0.29	3.48	0.039	7.5
2C	13/14	18	2.5	90	12	0 1/8	0.29	3.48	0.039	7.5
2D	13/15	18	3	90	11	0 1/8	0.32	3.52	0.039	8.2
2D	13/16	18	3	90	11	0 1/8	0.32	3.52	0.039	8.2
				1400	203			55.07		

*Will*  
17 Apr. '03

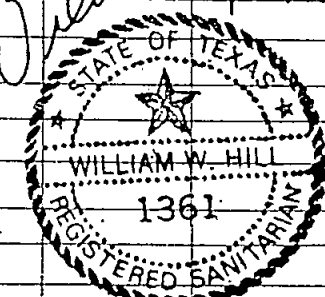

500 Gal. Concrete Pump Tank  
Ellison Concrete Products  
420 Gal./Day

Neil Barstow  
Star Crest  
Lot 34

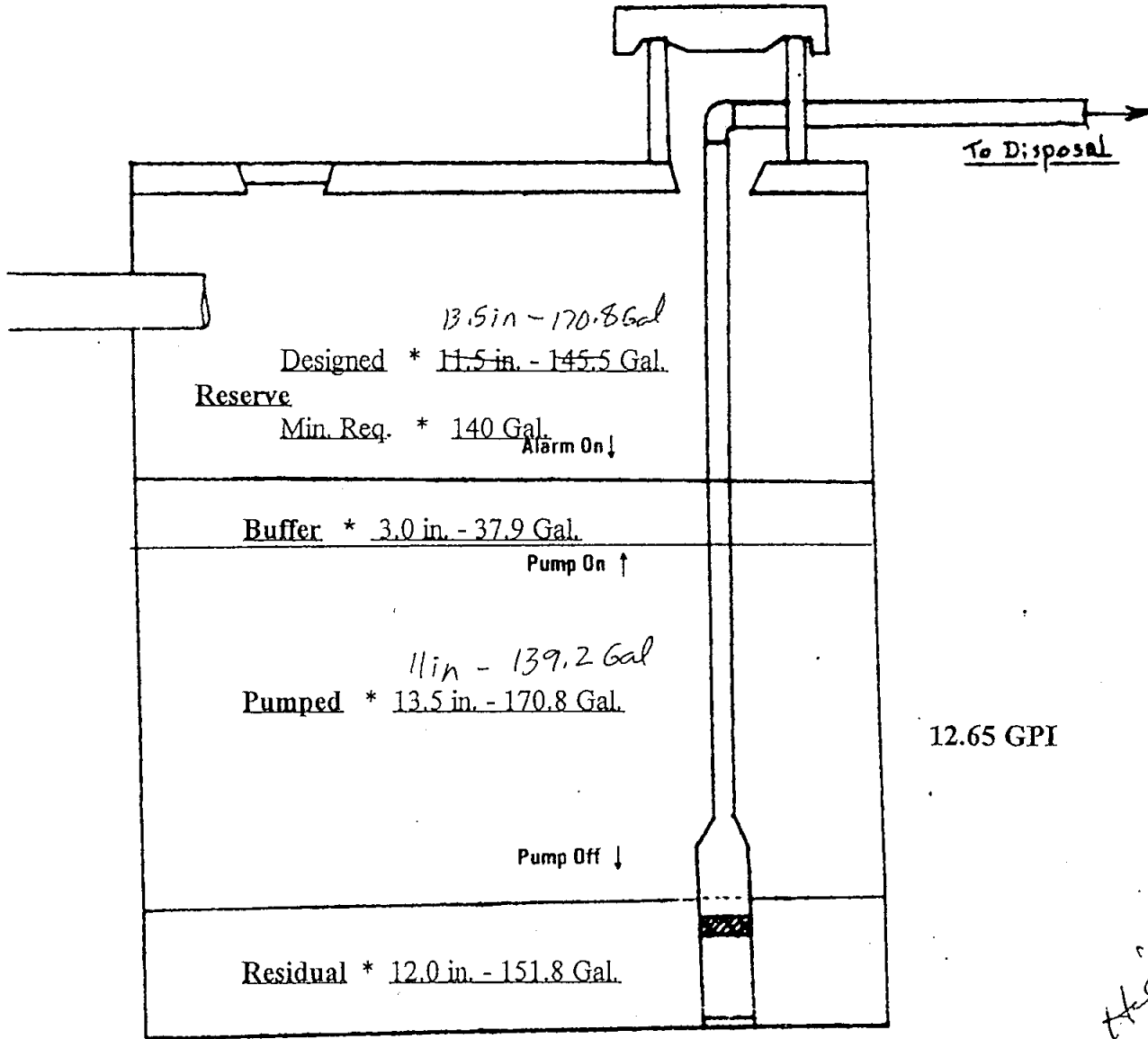

*William Hill*  
17 Apr 03

