

# Shelby Co., AL

SEE PHOTOS  
ON WEB

[www.cypruspartners.com](http://www.cypruspartners.com)

Reference # 401

More info at  
205-500-0437

## Land For Sale

### 8.7 acres +/-

### \$41,100

Exclusive Agent For Owner

**CYPRUS**  
PARTNERS

P O Box 43633  
Birmingham, AL 35243

- +/- 8.7 wooded acres located 4.5 miles northeast of Montevallo in Shelby County, Alabama
- Road frontage on Co Rd 10 (paved-public) and Homeland Way (gravel-public)
- Power and Water service available at the public road
- Lot is heavily treed and gently sloped
- No covenants and restrictions
- Outside city limits
- Great spot for a home place with acreage minutes away from Montevallo

All distances and acres are estimates and should be independently verified

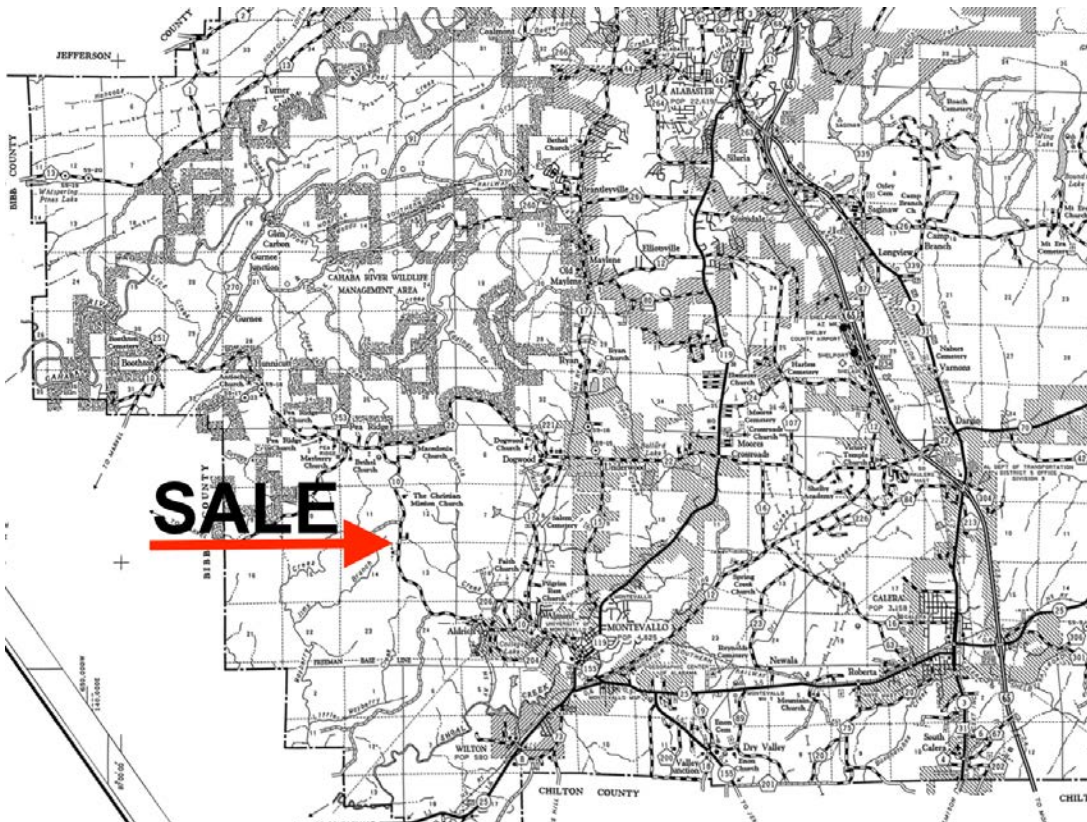

NOTICE: Investment in land carries risk. Prospective buyers should understand and independently verify the risk factors before buying this property. All information furnished by Cyprus Partners about this property has been obtained from sources believed to be reliable. However, neither Cyprus Partners nor the property owner makes any representation or warranty as to completeness or accuracy. This property is subject to prior sale, price change and withdrawal from the market without notice. No representation or warranty is made, express or implied, as to the condition of the property, boundaries, fitness for any particular use, Fair Market Value, access, acres, zoning, or condition of title.



Directions from Montevallo 1. Head northeast on Co Rd 10 (4.1 mi) 2. Turn left onto Homeland Way  
3. The destination is on the right.

