

Aerial Map



Land Pros, LLC

map center: 40° 10' 21.58, -91° 49' 10.14

0ft 282ft 564ft

Maps Provided By



© AgriData, Inc. 2017

www.AgriDataInc.com

17-62N-8W
Lewis County
Missouri



8/3/2017

Field borders provided by Farm Service Agency as of 5/21/2008.

Soils Map

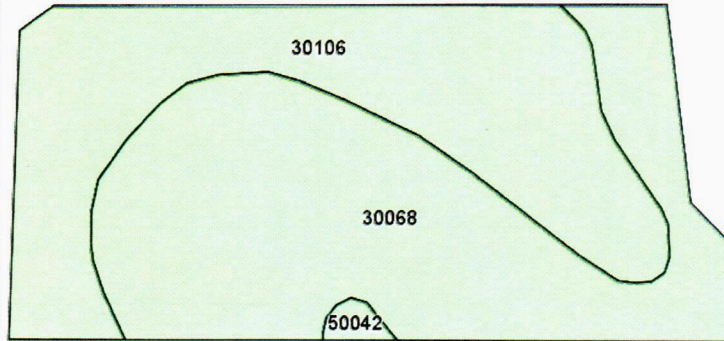

©2017 AgriData, Inc.

Soils data provided by USDA and NRCS.

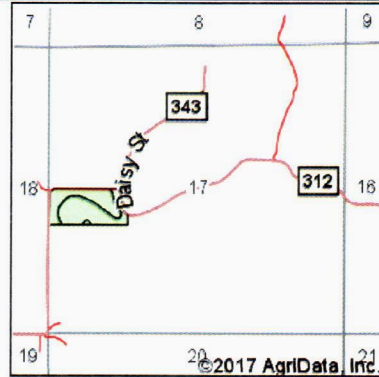

State: **Missouri**
 County: **Lewis**
 Location: **17-62N-8W**
 Township: **Reddish**
 Acres: **20.92**
 Date: **8/3/2017**



Land Pros, LLC

Maps Provided By:



Area Symbol: MO111, Soil Area Version: 17

Code	Soil Description	Acres	Percent of field	Non-Irr Class *c
30068	Gorin silt loam, 5 to 9 percent slopes, eroded	11.48	54.9%	IIIe
30106	Kilwinning silt loam, 1 to 5 percent slopes	9.24	44.2%	IIIe
50042	Lindley loam, 20 to 35 percent slopes, eroded	0.20	1.0%	Vle

*c: Using Capabilities Class Dominant Condition Aggregation Method

Soils data provided by USDA and NRCS.