

Soils Map

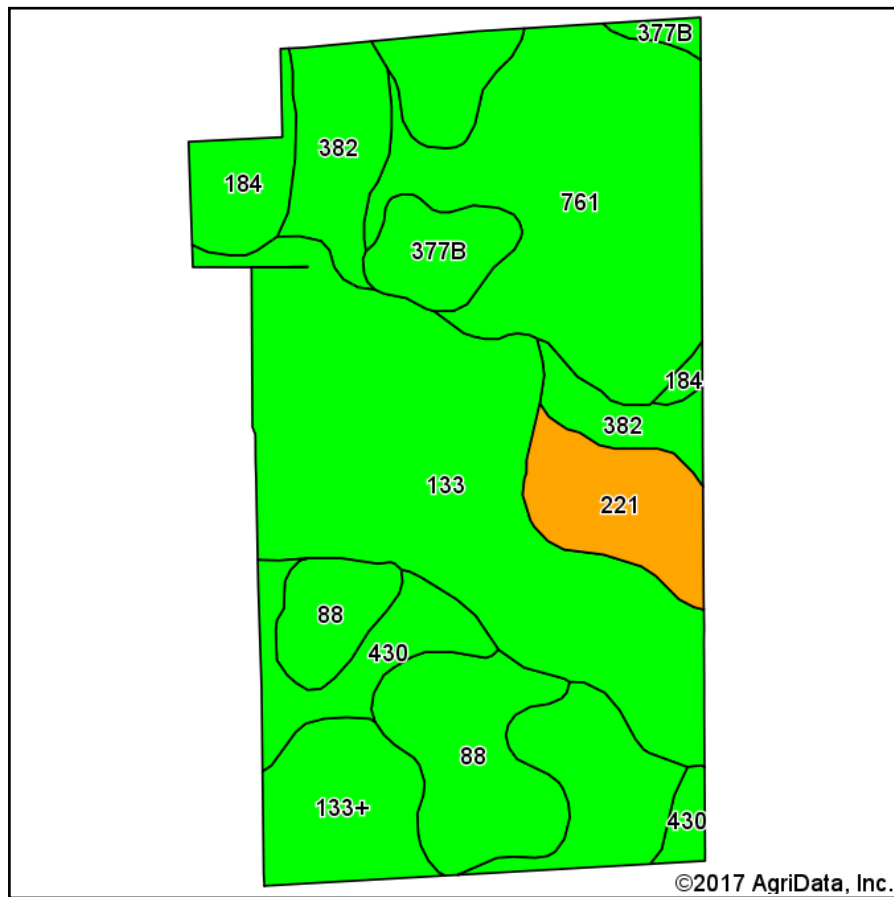

Soils data provided by USDA and NRCS.

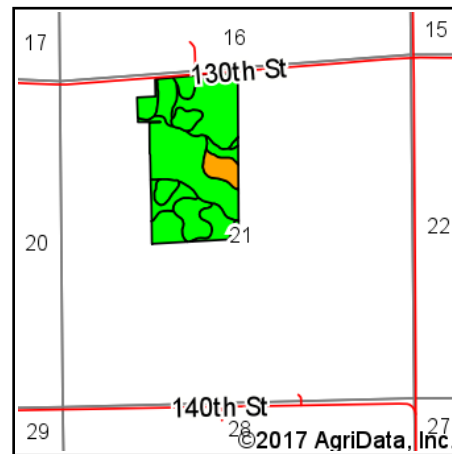

State: **Iowa**
 County: **Cedar**
 Location: **21-82N-1W**
 Township: **Massillon**
 Acres: **80.09**
 Date: **8/17/2017**



Area Symbol: IA031, Soil Area Version: 21

Code	Soil Description	Acres	Percent of field	CSR2 Legend	Non-Irr Class *c	*i Corn	*i Alfalfa	*i Soybeans	*i Bluegrass	*i Tall Grasses	CSR2**	CSR	Oats	Soybeans	Corn	NCCPI Overall
133	Colo silty clay loam, 0 to 2 percent slopes, occasionally flooded	22.97	28.7%		llw	204.8	4.3	59.4	3.7	6.1	78	80				95
761	Franklin silt loam, 1 to 3 percent slopes	16.65	20.8%		le	224	5.8	65	4	6.7	85	83	5	3	10	95
133+	Colo silt loam, 0 to 2 percent slopes, occasionally flooded, overwash	9.25	11.5%		llw	204.8	4.3	59.4	3.7	6.1	78	85				94
88	Nevin silty clay loam, 0 to 2 percent slopes, rarely flooded	8.60	10.7%		lw	227.2	5.9	65.9	4.1	6.8	94	92				99
382	Maxfield silty clay loam, 0 to 2 percent slopes	5.88	7.3%		llw	230.4	4.8	66.8	4.1	6.9	94	90				82
184	Klinger silty clay loam, 1 to 4 percent slopes	5.06	6.3%		lw	240	6.2	69.6	4.3	7.2	95	93				88
221	Klossner muck, 1 to 3 percent slopes	4.48	5.6%		lllw	163.2	3.4	47.3	2.9	4.9	42	45				88

430	Ackmore silt loam, 0 to 2 percent slopes, occasionally flooded	4.13	5.2%		Ilw	203.2	5.3	58.9	3.7	6.1	77	83			86	
377B	Dinsdale silty clay loam, 2 to 5 percent slopes	3.07	3.8%		Ile	232	6.5	67.3	4.2	7	94	90			89	
Weighted Average						213.9	5	62.1	3.8	6.4	82	82.6	1	0.6	2.1	92.8

**IA has updated the CSR values for each county to CSR2.

*i Yield data provided by the ISPAID Database version 8.1 developed by IA State University.

*c: Using Capabilities Class Dominant Condition Aggregation Method

Soils data provided by USDA and NRCS.