

# Soils Map

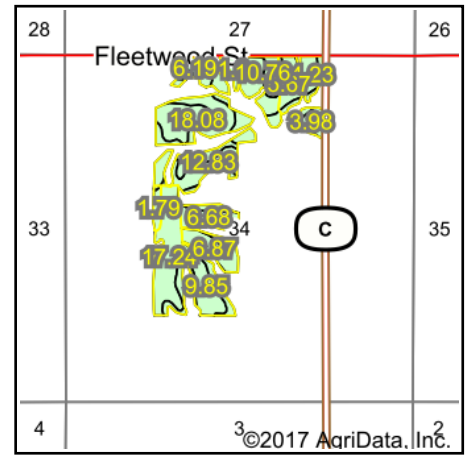

Soils data provided by USDA and NRCS.



State: **Missouri**  
 County: **Mercer**  
 Location: **34-65N-23W**  
 Township: **Ravanna**  
 Acres: **105.77**  
 Date: **9/7/2017**

**Latham®**  
 HI-TECH SEEDS

Maps Provided By:



© AgriData, Inc. 2017

www.AgriDataInc.com



## Area Symbol: MO129, Soil Area Version: 16

Code	Soil Description	Acres	Percent of field	Non-Irr Class *c
30007	Adair loam, 5 to 9 percent slopes, eroded	54.36	51.4%	IIIe
30063	Gara loam, 9 to 14 percent slopes, moderately eroded	24.79	23.4%	IVe
30058	Gara loam, 14 to 18 percent slopes, moderately eroded	16.47	15.6%	Vle
36089	Nodaway-Humeston-Vigar complex, 1 to 6 percent slopes	9.16	8.7%	IIIw
30133	Lamoni clay loam, 5 to 9 percent slopes, moderately eroded	0.99	0.9%	IIIe

\*c: Using Capabilities Class Dominant Condition Aggregation Method

Soils data provided by USDA and NRCS.