

Soils Map

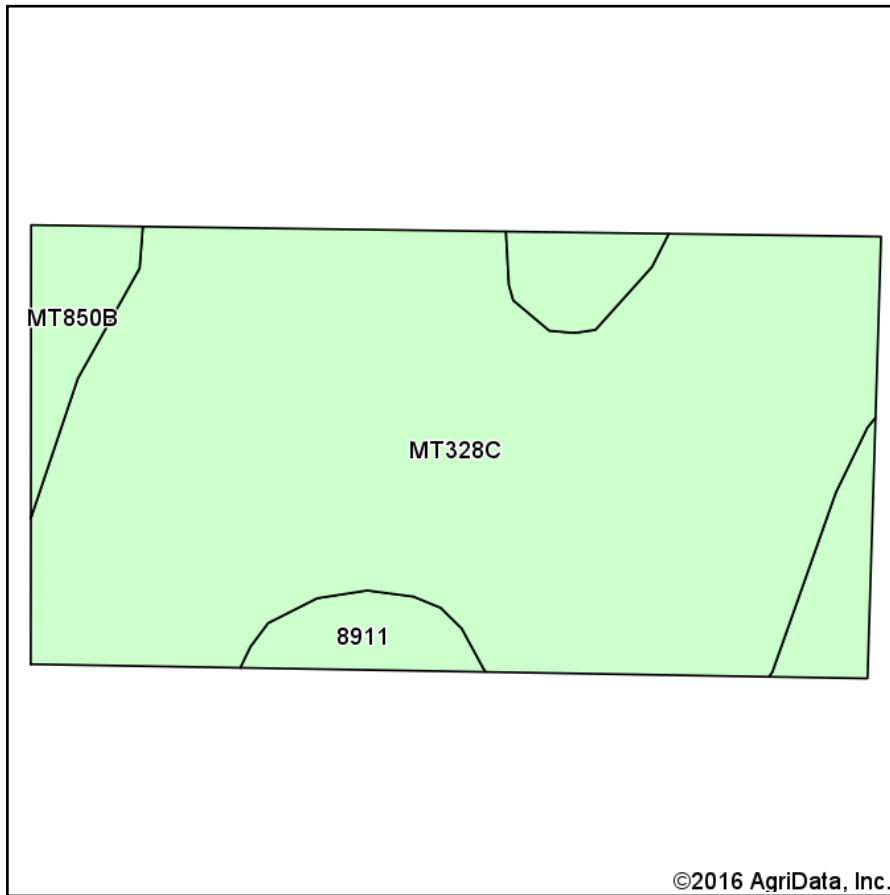

Soils data provided by USDA and NRCS.

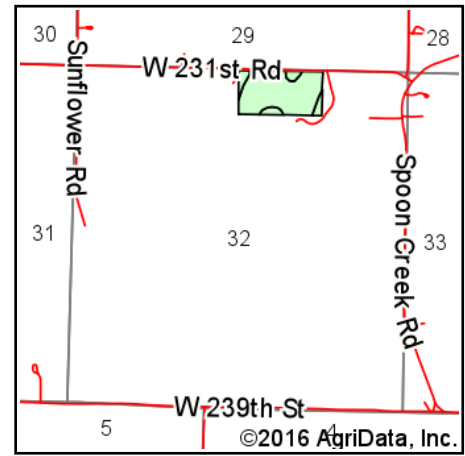

State: **Kansas**
 County: **Miami**
 Location: **32-15S-22E**
 Township: **Richland**
 Acres: **20.5**
 Date: **5/31/2016**



Maps Provided By:



© AgriData, Inc. 2016

www.AgriDataInc.com



Area Symbol: KS121, Soil Area Version: 16

Code	Soil Description	Acres	Percent of field	Non-Irr Class *c	Range Production (lbs/acre/yr)	Warm season grasses	Winter wheat	Orchardgrass red clover	Tall fescue	Alfalfa hay	Caucasian bluestem	Common bermudagrass
MT328C	Bucyrus silty clay loam, 3 to 8 percent slopes	17.37	84.7%	IIIe	0	8	46					
MT850B	Wagstaff silty clay loam, 1 to 3 percent slopes	1.57	7.7%	IIIe	5120	8	27	1	1	1	1	1
8911	Summit silty clay loam, 1 to 3 percent slopes	1.56	7.6%	Ile	4828							
Weighted Average					759.5	7.4	41	0.1	0.1	0.1	0.1	0.1

Area Symbol: KS121, Soil Area Version: 16

*c: Using Capabilities Class Dominant Condition Aggregation Method

Soils data provided by USDA and NRCS.