

123.55-ACRE FARM ESSEX COUNTY, VIRGINIA

ASKING PRICE - \$350,000



REPRESENTED BY:

BILL GRANT
ALC, VLS
804-754-3476

JEFFREY HUFF
ALC, FORESTER
804-750-1207

ALL INFORMATION DEEMED RELIABLE, BUT NOT GUARANTEED.

TABLE OF CONTENTS

- I. PROPERTY DESCRIPTION
- II. PHOTOGRAPHS
- III. TAX MAP
- IV. PLAT
- V. AERIAL PHOTO
- VI. TOPOGRAPHIC MAP
- VII. LOCATION MAP
- VIII. FLYER

PROPERTY DESCRIPTION

The subject property is shown on Essex County Tax Map records as parcel number 61-9A. According to the tax records the property contains 123.55 acres. The deed is recorded in Instrument # 110000010. The plat is recorded in Plat Book 24 on Page 59. A review of the Essex County Tax Records indicates the following:

<u>Tax Map Number</u>	<u>Acreage</u>
61-9A	123.55

The subject property is currently zoned Agricultural. There are approximately 2,010.6 feet +/- of road frontage on State Route 600 (Butylo Road). There is also a 70-foot deeded access easement across a 2.45-acre outparcel (Parcel B) shown on the above plat along with a 30-foot drainage easement (185 feet in length) from that outparcel crossing a portion of the subject property to a nearby ravine.

A portion of an 11-acre stocked pond with a heavily engineered re-built dam (cost around \$150,000+/- in early 2000s) is found along the property's northern boundary. There is also a 0.4-acre minnow pond just off the pond's dam and within the subject property's boundary.

The subject property contains approximately 30.5 acres +/- under cultivation, 5.5 acres +/- in openland (uncultivated) with balance in cut-over woodland (completed in September 2017) and some natural mixed hardwoods and pines along the SMZs leading down to the ponds.

PHOTOGRAPHS







ALL INFORMATION DEEMED RELIABLE, BUT NOT GUARANTEED.



AERIAL PHOTOGRAPH



ALL INFORMATION DEEMED RELIABLE, BUT NOT GUARANTEED.

TOPOGRAPHIC MAP

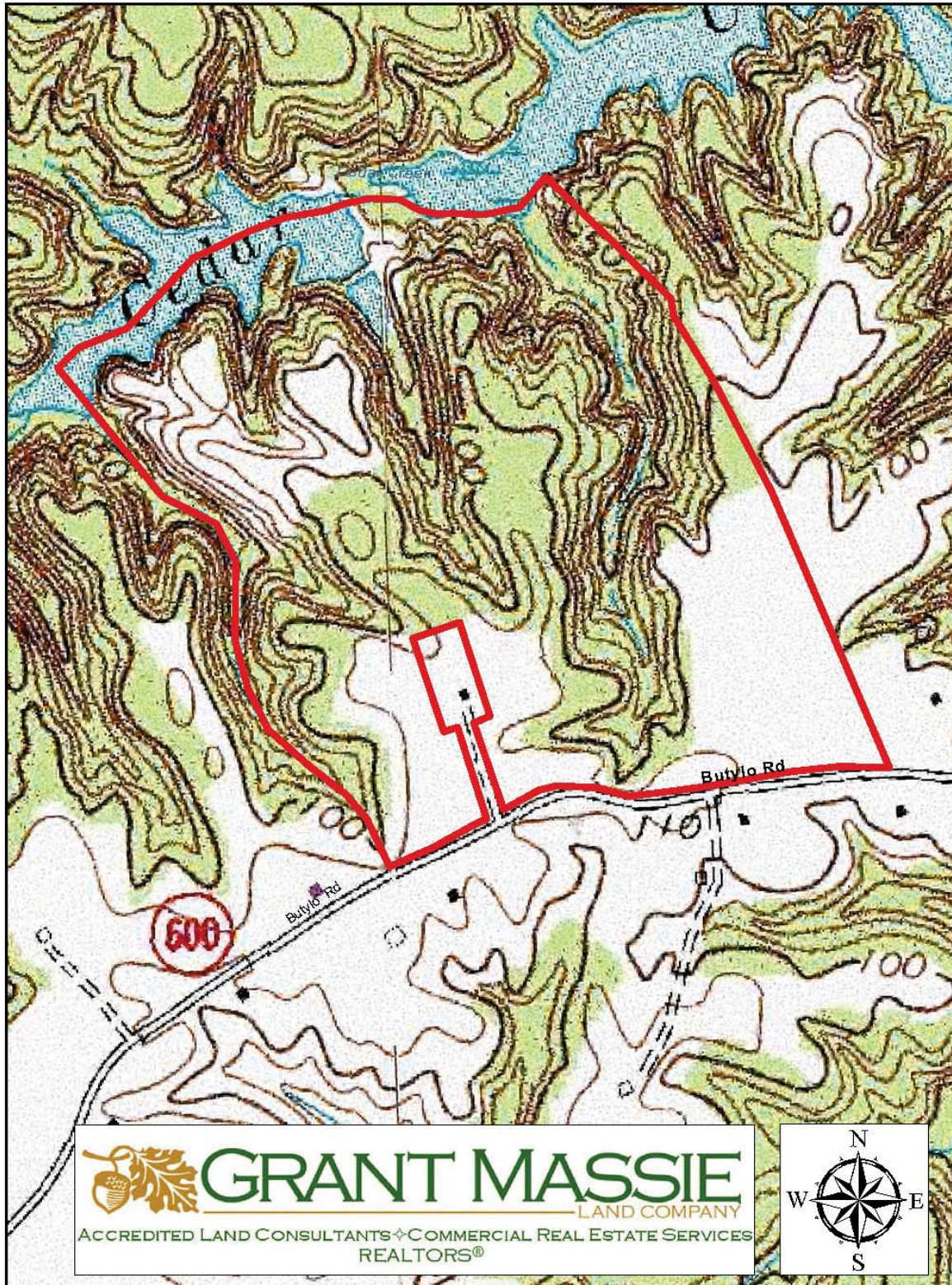

ALL INFORMATION DEEMED RELIABLE, BUT NOT GUARANTEED.

LOCATION MAP

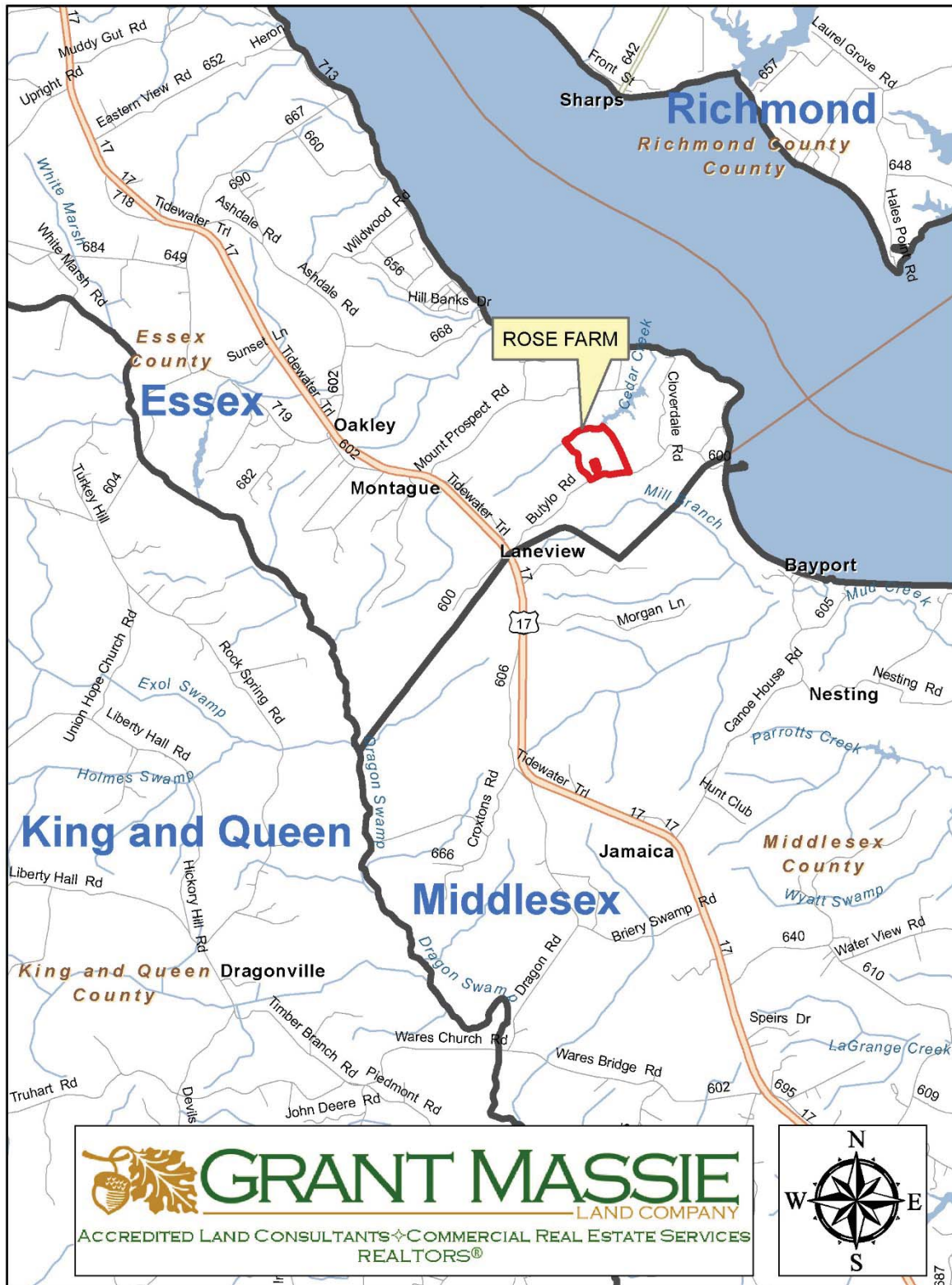

ALL INFORMATION DEEMED RELIABLE, BUT NOT GUARANTEED.

FARM FOR SALE

123.55 ACRES IN ESSEX COUNTY, VA



\$350,000

For 24-hour recorded information,
call LANDLINE
1-888-471-LAND #2274
or visit our website at
www.GrantMassie.com

PROPERTY INFORMATION:

- ✧ Awesome Farm, Recreational Investment and/or Rural Family Retreat/Homesite(s).
- ✧ Stocked 11-acre Pond Shared with Adjacent Owners.
- ✧ About 30.5 Acres +/- in Cultivation and Another 5.5 Acres +/- in Uncultivated Openland.
- ✧ Balance in Cut-over Woods and Wooded SMZs.
- ✧ Long frontage on State Route 600 (Butylo Rd).
- ✧ Convenient to Route 17, Tappahannock, West Point, Urbanna, Etc. Scenic Drive to Farm from Metro Richmond, Yorktown, and Fredericksburg.



 **GRANT MASSIE**
LAND COMPANY
ACCREDITED LAND CONSULTANTS ♦ COMMERCIAL REAL ESTATE SERVICES
REALTORS®

8100 THREE CHOPT RD., SUITE 113 RICHMOND, VA 23229
(804) 750-1200 • FAX: (804) 754-3485 • TOLL FREE: 1-800-665-LAND

All information is deemed reliable, but not guaranteed.

REPRESENTED BY:

BILL GRANT
ALC, VLS
(804) 754-3476

JEFFREY HUFF
ALC
(804) 750-1207