

LAND FOR SALE

Milford Farm



LOCATION: Just southeast of Milford, Nebraska at the intersection of Old Cheney Road and 210th Road.

LEGAL DESCRIPTION: The Southeast Quarter (SE 1/4) of Section Seven (7), Township Nine (9) North, Range Four (4) East of the 6th P.M., Seward County, Nebraska, except Cooper Heartland Addition [154.93 tax-assessed acres].

COMMENTS: This productive, non-irrigated farm provides a stand of alfalfa (organic seed) established in 2014 and pasture currently being hayed.

LIST PRICE: **\$749,000.00**

CONTACT: Adam D. Pavelka,
Listing Agent

(402) 984-7744
adam@agriaffiliates.com

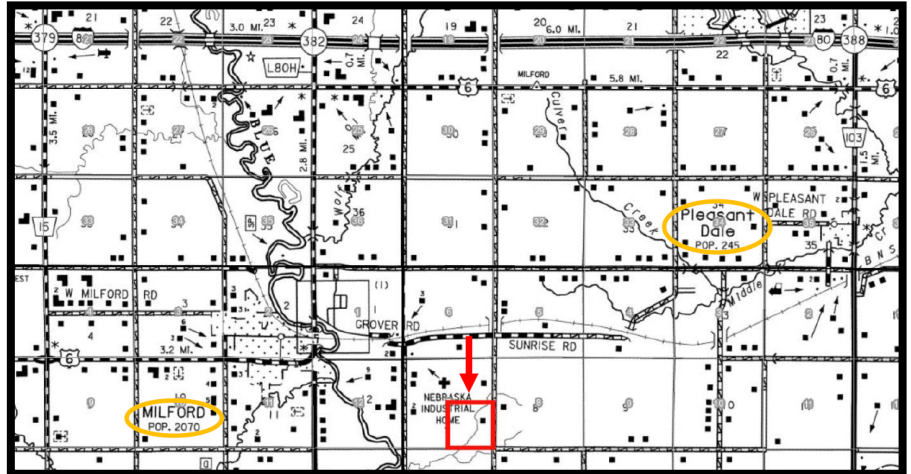

Offered Exclusively By:



AGRI AFFILIATES, INC.
Providing Farm - Ranch Real Estate Services

Information contained herein was obtained from sources deemed reliable. We have no reason to doubt the accuracy, but the information is not guaranteed. Prospective Buyers should verify all information. All maps provided by Agri Affiliates, Inc. are approximations only, to be used as a general guideline, and not intended as survey accurate. As with any agricultural land, this property may include noxious weeds. Agri Affiliates, Inc. and all agents are acting as Agent of the Seller.

HASTINGS OFFICE
P.O. Box 519
747 N. Burlington Ave Suite 310
Hastings, NE 68901-0519
www.agriaffiliates.com
(402) 519-2777



PROPERTY
DESCRIPTION:

This farm has been well cared for with established, drain-tilled terraces. It has been chemical free for three years, and is eligible for organic certification. Its proximity to Milford and Lincoln makes it a great place for a country home or subdivision with serene surroundings.

SOILS:

Primarily Hastings silty clay loams.

REAL ESTATE
TAXES:

2017 Real Estate Tax Estimate \$7,745.46

FARM SERVICE AGENCY
INFORMATION:

Total Farmland: 153.62 acres
Government Base Acres: Corn—52.8
 Soybeans—40.3
* Base acres are enrolled in ARC-County.

Total Cropland: 104.59 acres
PLC Yield: Corn—111
 Soybeans—43

