

Soils Map

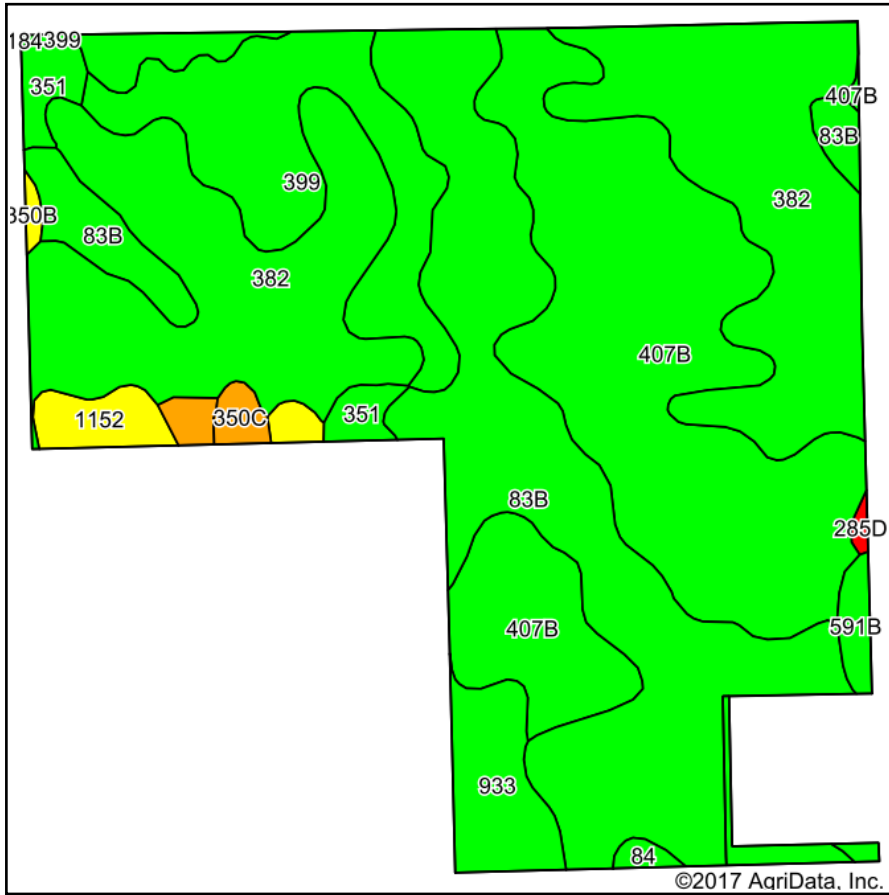

Soils data provided by USDA and NRCS.

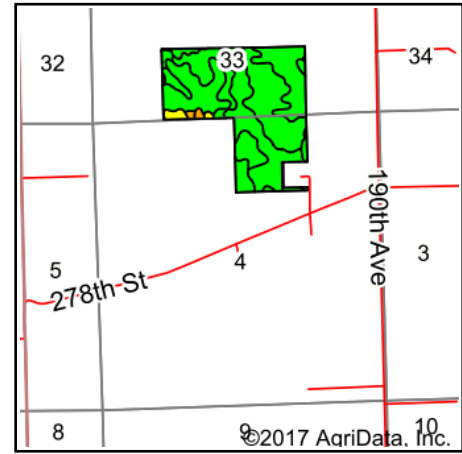

State: **Iowa**
 County: **Clinton**
 Location: **4-80N-2E**
 Township: **Olive**
 Acres: **117.3**
 Date: **12/5/2017**



© AgriData, Inc. 2017 www.AgriDataInc.com



Area Symbol: IA045, Soil Area Version: 23

Code	Soil Description	Acres	Percent of field	CSR2 Legend	Non-Irr Class *c	Irr Class *c	*j Corn	*j Alfalfa	*j Soybeans	*j Bluegrass	*j Tall Grasses	CSR2**	CSR	Corn	Oats	Soybeans	*n NCCPI Overall	*n NCCPI Corn and Soybeans
382	Maxfield silty clay loam, 0 to 2 percent slopes	33.27	28.4%		llw		230.4	4.8	66.8	4.1	6.9	94	90				83	83
407B	Schley loam, 1 to 4 percent slopes	31.87	27.2%		llw		196.8	5.1	57.1	3.5	5.9	81	73				88	88
83B	Kenyon loam, 2 to 5 percent slopes	30.31	25.8%		lle		225.6	6.3	65.4	4.1	6.8	90	87	210	91	61	84	84
399	Readlyn loam, 1 to 3 percent slopes	11.10	9.5%		lw		220.8	5.7	64	4	6.6	91	92				86	85
933	Sawmill silty clay loam, shallow loess, 0 to 2 percent slopes, occasionally flooded	3.79	3.2%		llw		204.8	4.3	59.4	3.7	6.1	78	80				93	93
1152	Marshan clay loam, 0 to 2 percent slopes, rarely flooded	2.10	1.8%		llw		80	1.7	23.2	1.4	2.4	54	70				85	85
351	Atterberry silt loam, sandy substratum, 0 to 2 percent slopes	1.91	1.6%		lw		224	5.8	65	4	6.7	78	73				98	92



591B	Clyde-Floyd complex, 1 to 4 percent slopes	1.03	0.9%		Ilw		216	4.5	62.6	3.9	6.5	87	73				86	86
350C	Waukegan silt loam, 5 to 9 percent slopes	0.65	0.6%		Ille		80	2.2	23.2	1.4	2.4	49	49				80	80
1727	Udolpho loam, 0 to 2 percent slopes	0.52	0.4%		Ilw		80	1.7	23.2	1.4	2.4	48	69				81	81
84	Clyde silty clay loam, 0 to 3 percent slopes	0.34	0.3%		Ilw		224	4.7	65	4	6.7	88	77	193.5	76.5	56	86	86
350B	Waukegan silt loam, 2 to 5 percent slopes	0.24	0.2%		Ile		80	2.2	23.2	1.4	2.4	55	69				81	81
285D	Burkhardt sandy loam, 5 to 14 percent slopes	0.17	0.1%		Ive	Ille	80	2.2	23.2	1.4	2.4	5	5				55	55
Weighted Average							213.3	5.3	61.9	3.8	6.4	86.9	83.2	54.8	23.7	15.9	*n 85.5	*n 85.3

**IA has updated the CSR values for each county to CSR2.

*i Yield data provided by the ISPAID Database version 8.1.1 developed by IA State University.

*n: The aggregation method is "Weighted Average using major components"

*c: Using Capabilities Class Dominant Condition Aggregation Method

Soils data provided by USDA and NRCS.