

# LAND FOR SALE

## Campbell Pivot Quarter



**LOCATION:** From the intersection of Highway 4 and the main street (Broad Street) in Campbell, Nebraska, travel north 1 mile (northeastern Franklin County, Nebraska).

**LEGAL DESCRIPTION:** The Southeast Quarter (SE ¼) of Section Thirteen (13), Township Four (4) North, Range Thirteen (13) West of the 6th P.M., Franklin County, Nebraska [160.01 tax-assessed acres].

**COMMENTS:** This center-pivot irrigated farm with blacktop access is within one mile of a CPI elevator location.

**REAL ESTATE TAXES:** 2017 Real Estate Tax - \$4,759.86

**NATURAL RESOURCE DISTRICT:** This farm is located in the Lower Republican NRD and contains 129.8 certified irrigated acres.

**LIST PRICE:** \$785,000.00

**CONTACT:** Adam D. Pavelka, Listing Agent  
(402) 984-7744  
adam@agriaffiliates.com

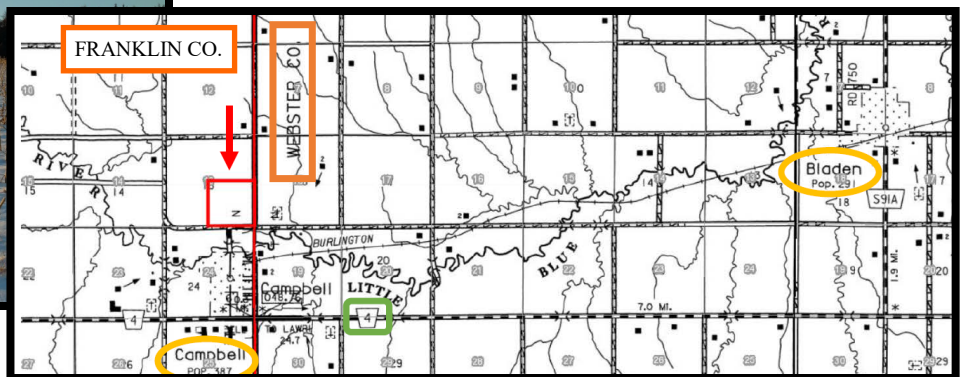

*Offered Exclusively By:*



**AGRI AFFILIATES, INC.**  
*Providing Farm - Ranch Real Estate Services*

Information contained herein was obtained from sources deemed reliable. We have no reason to doubt the accuracy, but the information is not guaranteed. Prospective Buyers should verify all information. All maps provided by Agri Affiliates, Inc. are approximations only, to be used as a general guideline, and not intended as survey accurate. As with any agricultural land, this property may include noxious weeds. Agri Affiliates, Inc. and all agents are acting as Agent of the Seller.

**HASTINGS OFFICE**  
P.O. Box 519  
747 N. Burlington Ave Suite 310  
Hastings, NE 68901-0519  
www.agriaffiliates.com  
**(402) 519-2777**





IRRIGATION  
INFORMATION:

Well Registration:	G-074316	Completion Date:	4/24/1975
Well Depth:	200 feet	Static Water Level:	105 feet
Pumping Level:	140 feet	Gallons/Minute:	900 gpm
Pivot:	10-tower T-L	Gearhead:	US Motors
Power Unit:	General Motors—Natural Gas V-8 (454 cu. in.)		

PROPERTY  
DESCRIPTION:

This farm has good production capability and has terrain ranging from nearly level to rolling. It comes with a newer natural gas power unit and older pivot. The farm also has a water hydrant for livestock water, connected to the Village of Campbell on the southern edge of the property.

SOILS:

Primarily Holdrege and Uly soils.

LEASE:

This farm is available for possession for the 2018 farming season following the tenant’s rights to graze stalks this winter.

FARM SERVICE AGENCY  
INFORMATION:

Government Base Acres: (projected)	Wheat—18.45	PLC Yields:	Wheat—37
	Corn—66.55		Corn—123
	Grain Sorghum—3.87		Grain Sorghum—65
	Soybeans—37.3		Soybeans—44

