

Soils Map

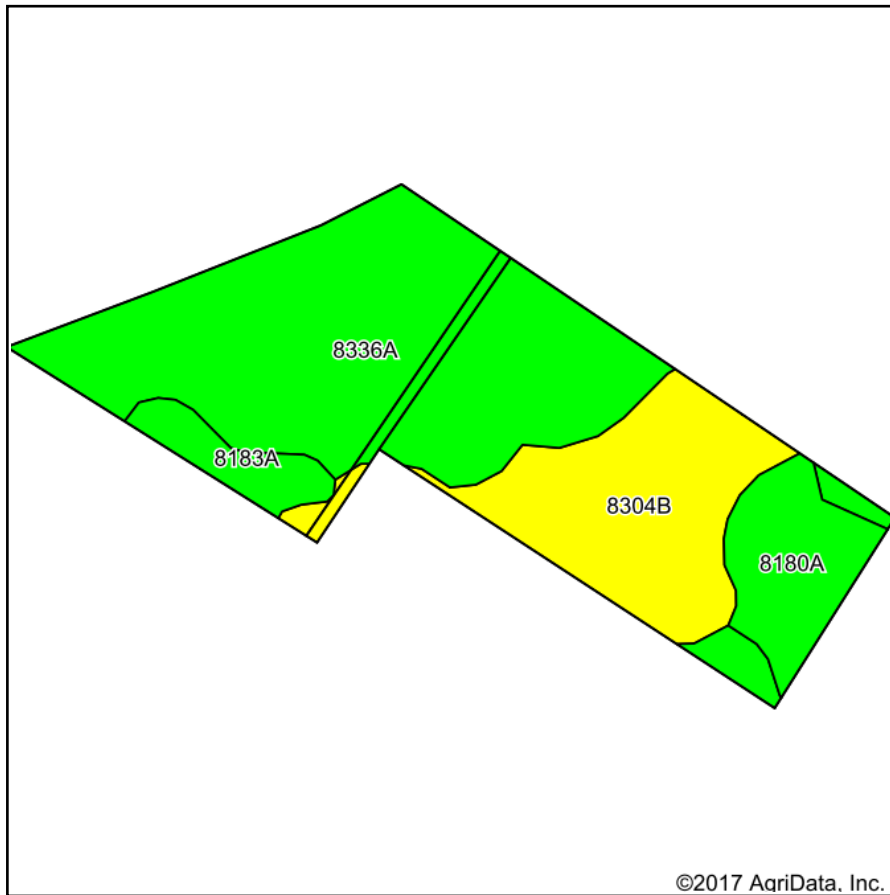

Soils data provided by USDA and NRCS.

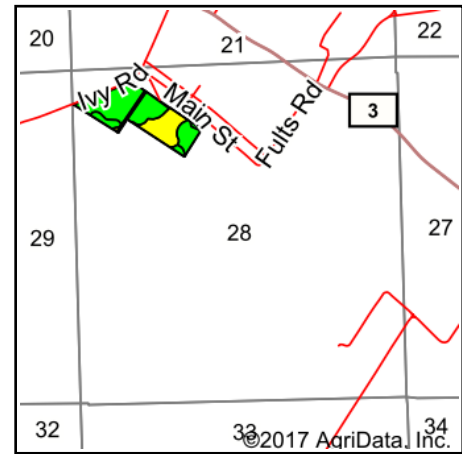

State: **Illinois**
 County: **Monroe**
 Location: **28-4S-10W**
 Township: **Precinct 13**
 Acres: **23.52**
 Date: **12/13/2017**



Maps Provided By:



© AgriData, Inc. 2017

www.AgriDataInc.com



Area Symbol: IL133, Soil Area Version: 10

Code	Soil Description	Acres	Percent of field	Il. State Productivity Index Legend	Subsoil rooting ^a	Crop productivity index for optimum management
8336A	Wilbur silt loam, 0 to 2 percent slopes, occasionally flooded	13.36	56.8%		FAV	128
8304B	Landes very fine sandy loam, 2 to 5 percent slopes, occasionally flooded	5.93	25.2%		FAV	100
8180A	Dupo silt loam, 0 to 2 percent slopes, occasionally flooded	2.63	11.2%		FAV	131
8183A	Shaffton clay loam, 0 to 2 percent slopes, occasionally flooded	1.60	6.8%		FAV	116
Weighted Average						120.5

Table: Optimum Crop Productivity Ratings for Illinois Soil by K.R. Olson and J.M. Lang, Office of Research, ACES, University of Illinois at Champaign-Urbana. Version: 1/2/2012 Amended Table S2 B811

Crop yields and productivity indices for optimum management (B811) are maintained at the following NRES web site:

<https://www.ideals.illinois.edu/handle/2142/1027/>

** Indexes adjusted for slope and erosion according to Bulletin 811 Table S3

^a UNF = unfavorable; FAV = favorable

Soils data provided by USDA and NRCS. Soils data provided by University of Illinois at Champaign-Urbana.

*c: Using Capabilities Class Dominant Condition Aggregation Method