



**Ingham County  
Health Department**

**Linda S. Vail, MPA, Health Officer**

May 15, 2017

Brock Fletcher  
3490 Belle Chase Way  
Lansing, MI 48911

**RE: Vacant Land Evaluation in Vevay Township, Section 27, 1514 Rolfe Road Mason, MI  
48854 Parcel 33-10-10-27-200-022, Application 4-28-17-104**

Dear Mr. Fletcher:

On May 12, 2017, a site evaluation was conducted at the above mentioned parcel to determine the soils conditions for an on-site sewage treatment system. This parcel was evaluated in anticipation of the parcel being split and construction of a single family home on one of the two split parcels. The results of the evaluation are enclosed in this letter.

An evaluation of the soil was done to determine what type of sewage treatment system would need to be installed. Three soil borings were made on the 13.81 acre lot and two soil borings were made on the 13.49 acre lot to determine if the area is suitable for a conventional onsite wastewater treatment system. All five soil borings did not pass the minimum requirements for a conventional on-site system. Soils in this area consisted of loamy sand to sandy clay loam with a seasonal high water level at 10 inches below grade as indicated by soil mottling. Any replacement wastewater treatment system on the above mentioned property would have to be engineered. A company from the county's approved Alternative Wastewater Design consultant list must prepare a plan for this type of system for review by this office. Before a permit can be issued for the wastewater system, the application for a septic permit, the submitted plan, with the application fee and plan review fee, must be approved by our office. Your site is also approved for a potable water well. The well must be drilled according to Part 127 Michigan Water Well Construction and must be drilled by a licensed well driller. A well log must be submitted to this office.

In closing, you are reminded to keep equipment off the area that was determined to be suitable for sewage disposal system. Protecting the natural condition of the soils is very important to the future operation of your system. If you have any questions or concerns, contact our office at (517) 887-4312.

Sincerely,

Meredith Hipp  
Sanitarian  
Ingham County Environmental Health

MH/jr

Cc: Vevay Township  
Enclosure

**Environmental Health**

**Ingham County Health Department  
Alternative Wastewater Design Consultants  
And Maintenance List**

<b>Enger Surveying and Engineering</b> P.O. Box 87, 805 N. Cedar Rd Mason, MI 48854 Phone: 517-676-6565 Fax: 517-676-6675	<b>Foster Trenching Inc.</b> 6440 Wells Road Ashley, MI 48806 Phone: 989-838-2554
<b>KEBS, Inc.</b> 2116 Haslett Road Haslett, MI 48840 Phone: 517-339-1014 Fax: 517-339-8047	<b>Maynard Beery- Soil Scientist</b> 849 N. Aurelius Road Mason, MI 48854 Phone: 517-676-4686 Fax: 517-676-4070
<b>Stephens Consulting Services</b> P.O. Box 708, 1549 Haslett Road Haslett, MI 48840 Phone: 517-339-8692 Fax: 517-339-6330	<b>Wolverine Engineers &amp; Surveyors</b> 312 North Street Mason, MI 48854 Phone: 517-676-9200 Fax: 517-676-9396

\* Provision of this list does not constitute an endorsement of any Designer or Contractor by ICHD or guarantee approval of any design.

# SOIL EVALUATION DATA SHEET

Ingham County Health Department

5303 S. Cedar

P.O. Box 30161

Lansing, MI 48909

517-887-4312

**THIS RECORD SHALL NOT CONSTITUTE A PERMIT**

Application # 4-28-17-104 Township: VeVay  
Section: 27 Road Location: W of Ives., N of Rolfe. 1514 Rolfe (parent)  
Subdivision: M + B. Lot # — Side of Road: —  
Parcel # 33- 10-10-27-200-022 Parcel Size: 13.81 Potential Splits: 2  
(1514 Rolfe - Parent parcel) + 13.49 Acres

## Plot Plan

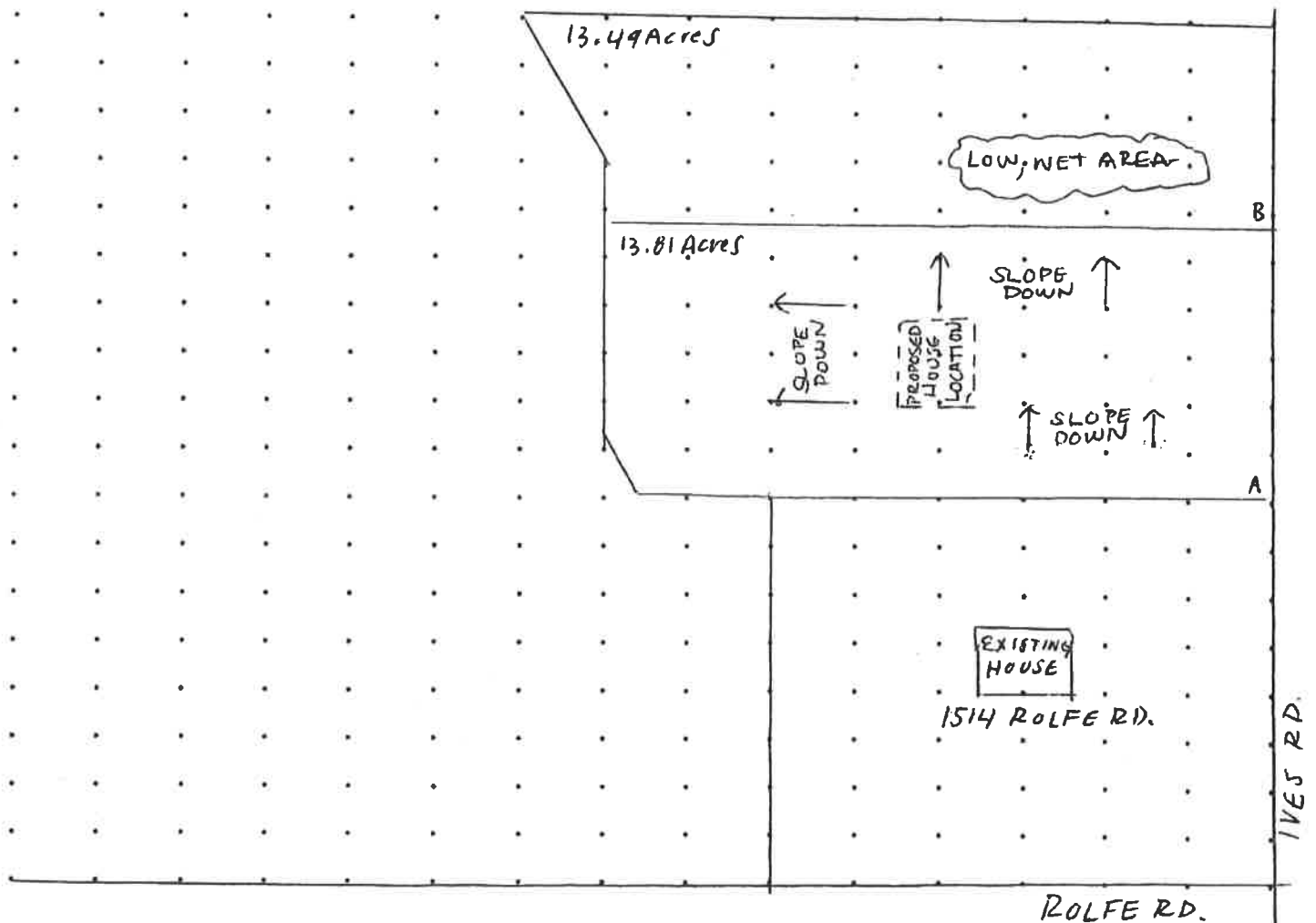

For A (13.81 Acres) ↘

Test #	1	2	3
Type of Test	BH	BH	BH
Depth	60"	60"	60"
Top Soil Texture	0-12"-LS TS	0-10"-LS TS	0-12"-LS TS
Layer 1	12-16"-LS (NMT)	10-20"-LS (NMT)	12-20"-SCL (NMT)
Layer 2	16-60"-LS (MT) Saturated	20-60"-LS (MT)	dull, wet 20-60"-SCL (MT)
Layer 3	* VERY MT @ 4', WL @ 4.5'	* VERY MT @ 5', WL @ 5'	+ VERY saturated, gray, WL @ 4.5'
Layer 4			
Layer 5			
Water level	For B (13.49 Acres) ↘		
Test #	4	5	
Type of Test	BH	BH	
Depth	54"	54"	
Top Soil Texture	0-10"-LS TS (dark)	0-10"-LS TS (dark)	
Layer 1	10-54"-LS, gray, saturated (MT) w/ gravel	10-15"-SCL (bright)	
Layer 2		15-54"-SCL (MT) saturated. w/ gravel	
Layer 3			
Layer 4	* WL @ 4.5'	* WL @ 4.5', MT heavily.	
Layer 5			
Water level			

#### Soil Texture Key

S	Sand	SCL	Sandy Clay Loam	B	Hand Auger Boring
LS	Loamy Sand	SiCL	Silty Clay Loam	BH	Backhoe Cut
SL	Sandy Loam	CL	Clay Loam	TS	Top Soil
L	Loam	C	Clay	MT	Mottling (Seasonal High Water)
SiL	Silty Loam	M	Muck	NMT	No Observed High Water Level
				WL	Water Level Observed

Conventional: \_\_\_\_\_ Engineered: ☒ Denied: \_\_\_\_\_

Comments: An engineered field is required for both splits.

Sanitarian: Morgan Jir

Date: 5/15/17



Vevay Twp., Sec. 27  
1514 Rolfe Road  
33-10-10-27-200-022  
May 17, 2017

0 115 230 460 Feet

