



**PERMIT TO CONSTRUCT
Onsite Wastewater System**

File Nbr: **2017040040**
County: Charleston

Name: STEVE GATES

Type Facility: HOUSE /48R

Subdivision:

Block:

Lot: B

Address: 1184 HARTS BLUFF RD
WADAMALAW, SC 29487

Site: HARTS BLUFF
WADALAW, SC

Program Code: 362

System Code: 270

TM#: 196-00-00-024

Water Supply: PRIVATE

PERMIT TO CONSTRUCT SYSTEM SPECIFICATIONS

Daily Flow (gpd): 480

Tank Sizes (gal): Septic Tank: 1000

Pump Chamber:

Grease Trap:

LTAR: .80

Trenches: Length (ft): 108 Width (in): 120 Max. Depth (in): 10

Agg. Depth (in): 6

Min Pump Capacity: gpm at

ft. of Head

SPECIAL INSTRUCTIONS/CONDITIONS

THIS PERMIT IS SITE SPECIFIC. ANY CHANGES TO THE SYSTEM MUST BE APPROVED BY DHEC. ALTERNATIVE TRENCH PRODUCTS APPROVED UNDER STATE RULES AND REGULATIONS MAY BE SUBSTITUTED. ANY UNAPPROVED CHANGES WILL VOID THIS PERMIT.

- All applicable setbacks set forth in Regulation 61-56 apply. 75' setback to well
- Maximum Trench Depth not to exceed ten (10) inches
- Do not cut, fill, bulldoze, scrape or change the grade of the natural soils in the septic system area.
- Do not install under wet soil conditions.
- No parking, driving, building or paving over the area of septic system before or after installation.
- Minimum 12" cover over system after installation with 5' buffers and 10' tapers from outside edges of trenches.
- Preconstruction conference required for property owners who wish to install their own system.

PERMIT TO CONSTRUCT SYSTEM DIAGRAM

(NTS)

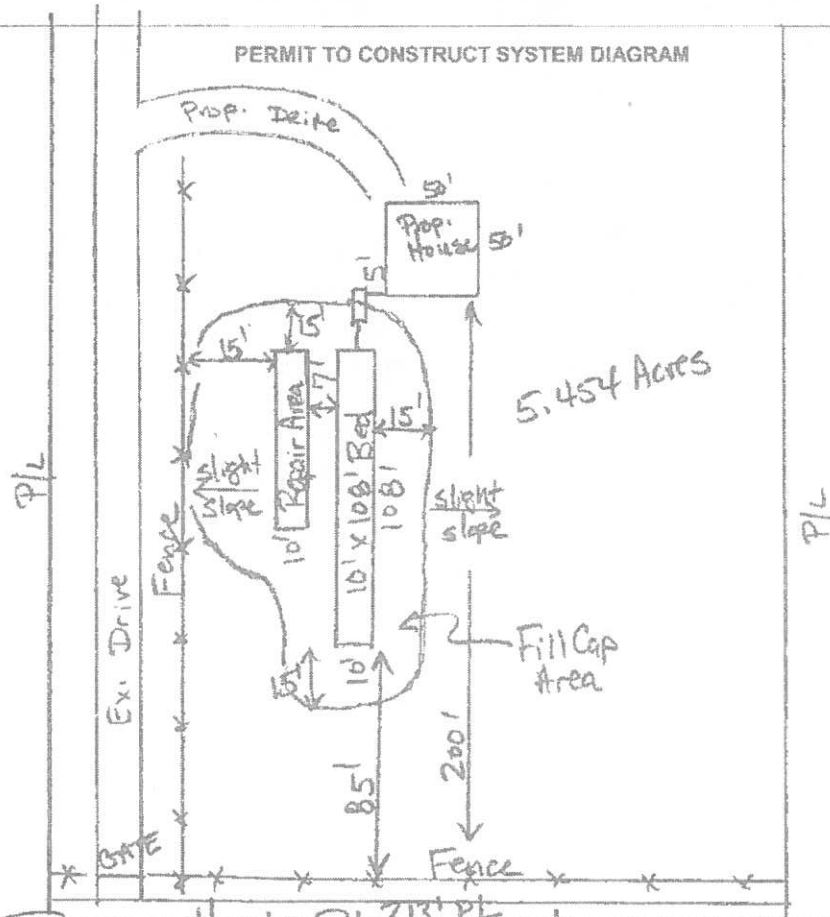

Issued/Revised By: *Rubany J. Jurek*

Date: *5/16/2017*

DHEC 1781 (01/2014)

This Permit is Appealable Under the Administrative Procedures Act.

There may be an Additional Fee for Changes in this Permit that Require a Site Reevaluation.