

Soils Map

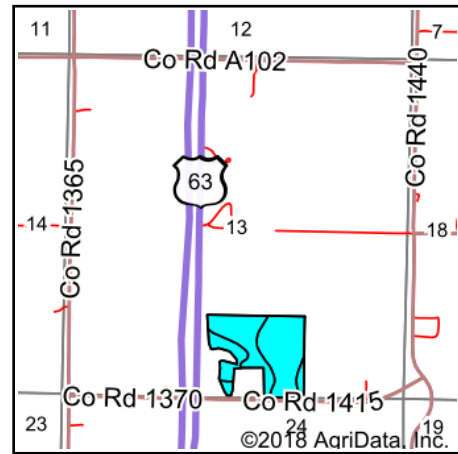

State: **Missouri**
 County: **Randolph**
 Location: **13-54N-14W**
 Township: **North Sugar Creek**
 Acres: **34.4**
 Date: **4/2/2018**

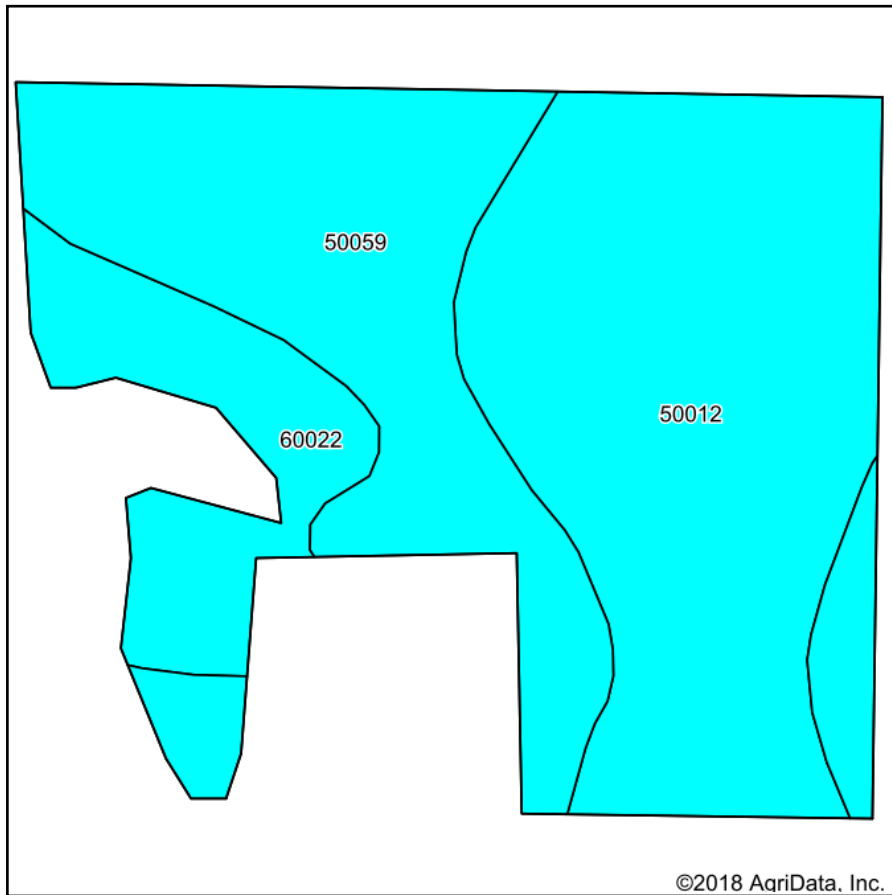

TROPHY
 PROPERTIES AND AUCTION
 LAND PROFESSIONAL RESIDENTIAL

Maps Provided By:



© AgriData, Inc. 2018

surety
 CUSTOMIZED ONLINE MAPPING

www.AgriDataInc.com



Area Symbol: MO175, Soil Area Version: 17

Code	Soil Description	Acres	Percent of field	Non-Irr Class Legend	Non-Irr Class *c
50012	Putnam silt loam, 0 to 1 percent slopes	16.51	48.0%		IIIw
50059	Mexico silt loam, 1 to 4 percent slopes, eroded	13.14	38.2%		IIle
60022	Leonard silt loam, 1 to 6 percent slopes, eroded	4.75	13.8%		IIle

*c: Using Capabilities Class Dominant Condition Aggregation Method

Soils data provided by USDA and NRCS.