



All Measurements are
For FSA Programs Only

Wetland Determination Identifiers

- Restricted Use
 - ▽ Limited Restrictions
 - Exempt from Conservation Compliance Provisions
- Disclaimer: Wetland identifiers do not represent the size, shape or specific determination of the area. Refer to your original determination (CPA-026 and attached maps) for exact wetland boundaries and determinations, or contact NRCS.

Ralls Co. FSA

C=Com Yellow GR, SB=Soybeans COM Gr
WHT=Wheat SRW Gr, MILO=SORGH GRS GR
DCSB=Soybeans COM Gr DC
H=Grass FTA FG I, LS=Grass FTA LS
GZ or T31=grass FTA Gz(01) or GZ(31)
Alf=Alfalfa FG, O Gr=Oats spr gr
CLOVR=Clover Red Fg
FP=Wildlife Food Plot
*Unless notated on Map

1:9,890

Program Year: 2018

Created: 10/4/2017

Flown: 2016-06-17

clu
crp
plss

Farm 1865
Tract 17252

Soils Map

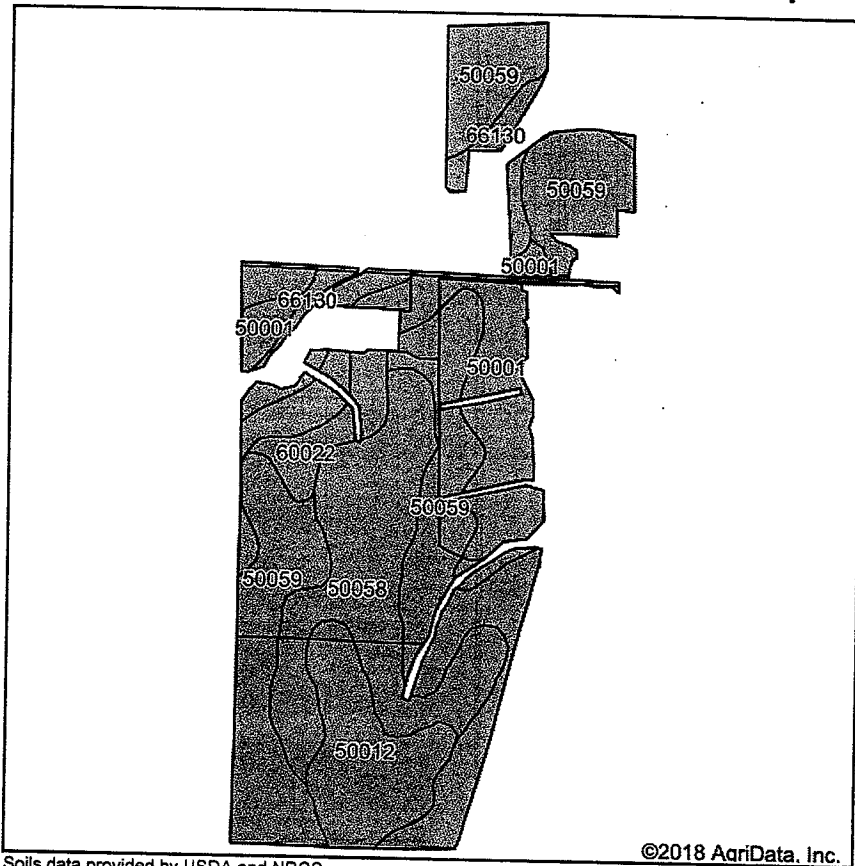

Soils data provided by USDA and NRCS.

©2018 AgriData, Inc.

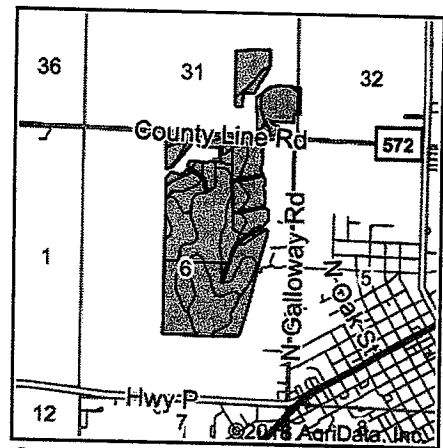

State: **Missouri**
 County: **Audrain**
 Location: **6-52N-5W**
 Township: **Cuivre**
 Acres: **202.98**
 Date: **3/13/2018**



TROPHY
 PROPERTIES AND AESTHETICS

Maps Provided By:



surety
 CUSTOMIZED ONLINE MAPPING
 © AgriData, Inc. 2018 www.AgriDataInc.com



Area Symbol: MO007, Soil Area Version: 20

Area Symbol: MO173, Soil Area Version: 18

Code	Soil Description	Acres	Percent of field	Non-Irr Class Legend	Non-Irr Class *c	Soybeans	Winter wheat	Corn	Grain sorghum
50059	Mexico silt loam, 1 to 4 percent slopes, eroded	63.53	31.3%		IIIe				
50058	Mexico silt loam, 0 to 2 percent slopes	42.83	21.1%		IIIw				
50001	Armstrong loam, 5 to 9 percent slopes, eroded	30.90	15.2%		IIIe	2	2	5	4
50059	Mexico silt loam, 1 to 4 percent slopes, eroded	24.07	11.9%		IIIe				
50012	Putnam silt loam, 0 to 1 percent slopes	22.39	11.0%		IIIw				
60022	Leonard silt loam, 1 to 6 percent slopes, eroded	7.70	3.8%		IIIe				
66130	Moniteau silt loam, 1 to 3 percent slopes, rarely flooded	5.09	2.5%		IIIw				
66130	Moniteau silt loam, 1 to 3 percent slopes, rarely flooded	4.86	2.4%		IIIw				
50001	Armstrong loam, 5 to 9 percent slopes, eroded	1.61	0.8%		IIIe	2	2	5	4
Weighted Average						0.3	0.3	0.8	0.6

*c: Using Capabilities Class Dominant Condition Aggregation Method

Soils data provided by USDA and NRCS.