

Soils Map

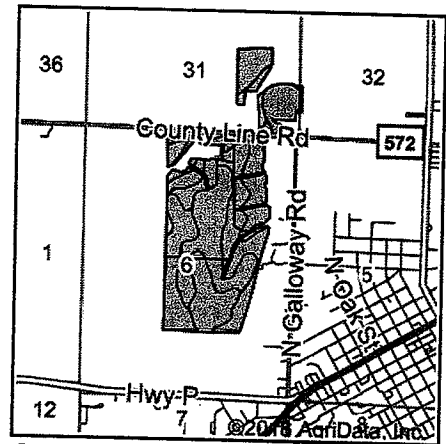

State: Missouri
County: Audrain
Location: 6-52N-5W
Township: Cuivre
Acres: 202.98
Date: 3/13/2018

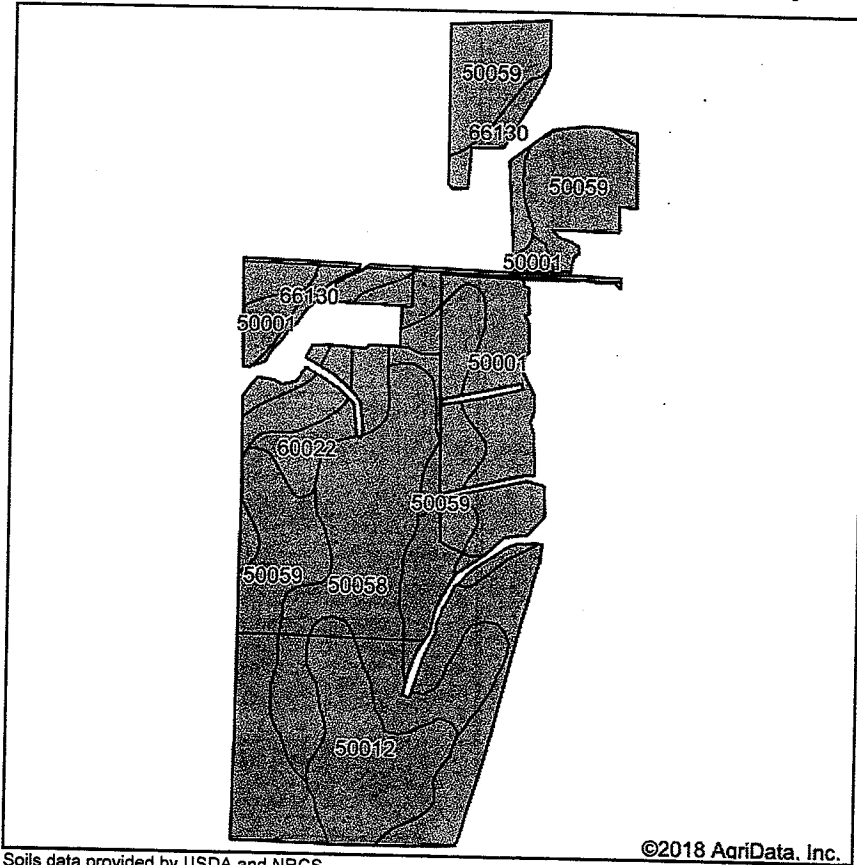

Maps Provided By:



Area Symbol: MO007, Soil Area Version: 20
Area Symbol: MO173, Soil Area Version: 18

Code	Soil Description	Acres	Percent of field	Non-Irr Class Legend	Non-Irr Class *c	Soybeans	Winter wheat	Corn	Grain sorghum
50059	Mexico silt loam, 1 to 4 percent slopes, eroded	63.53	31.3%		IIIe				
50058	Mexico silt loam, 0 to 2 percent slopes	42.83	21.1%		IIIw				
50001	Armstrong loam, 5 to 9 percent slopes, eroded	30.90	15.2%		IIIe	2	2	5	4
50059	Mexico silt loam, 1 to 4 percent slopes, eroded	24.07	11.9%		IIIe				
50012	Putnam silt loam, 0 to 1 percent slopes	22.39	11.0%		IIIw				
60022	Leonard silt loam, 1 to 6 percent slopes, eroded	7.70	3.8%		IIIe				
66130	Moniteau silt loam, 1 to 3 percent slopes, rarely flooded	5.09	2.5%		IIIw				
66130	Moniteau silt loam, 1 to 3 percent slopes, rarely flooded	4.86	2.4%		IIIw				
50001	Armstrong loam, 5 to 9 percent slopes, eroded	1.61	0.8%		IIIe	2	2	5	4
Weighted Average						0.3	0.3	0.8	0.6

*c: Using Capabilities Class Dominant Condition Aggregation Method

Soils data provided by USDA and NRCS.