

Noble Twp
Wabash County

For Sale

***Get Started Farming with
a Contract Hog Farm,
Additional Outbuilding
& Nice Place to Live***



2,300 Sq. Ft. 2-Story House
4 Bedrooms, 2 Bathrooms
with 24'x25' Attached Garage,
partial basement and
geothermal heating/cooling.

34'x258' Hog Barn
with cross flow ventilation,
8' deep full pit with good slats,
wet/dry feeders and 24
ton feed capacity.

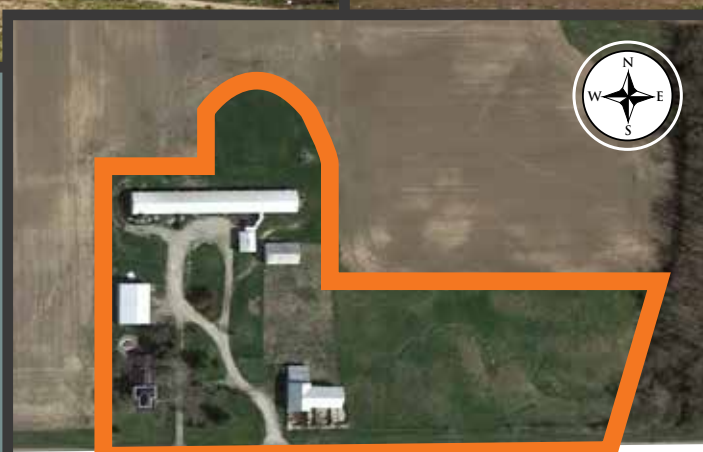

W SR 124

24'x31' Nursery
with painted metal exterior.
Tender foot sits on full pit.

30'x90' Pin-Frame Barn
with attached lean-to. Great
for 4H hobbies and storage.

45'x64' Machinery Storage
with 45'x40' insulated shop.

30'x50' Storage Barn
with galvanized metal exterior

6.99[±] Acres



Jon Rosen
260.740.1846
jonr@halderman.com



Owner: Keith Clupper
HALDERMAN
REAL ESTATE & FARM MANAGEMENT
HLS# JRR-12176 (18)

800.424.2324 | halderman.com



HALDERMAN

REAL ESTATE & FARM MANAGEMENT

P O B o x 297

Wabash, IN 46992

Noble Twp
Wabash County

For Sale

6.99[±] Acres

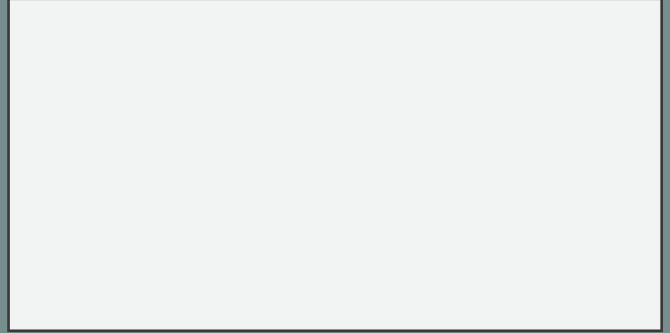

Get Started Farming with
**a Contract Hog Farm, Additional
Outbuilding & Nice Place To Live**

PROPERTY INFORMATION

LOCATION:

Approximately 1/4 mile east of CR 500 W and
SR 124 on the north side of the SR

4772 W. SR 124, Wabash, IN 46992

ZONING:

Agricultural

TOPOGRAPHY:

Level-Gently Rolling

SCHOOL DISTRICT:

MSD of Wabash County, Southwood Schools

ANNUAL TAXES:

\$1,306.72

For more information, please contact:

Jon Rosen

260.740.1846

jonr@halderman.com

