



Stand

StandID

 2017 Harvest Area (+/- 52.6 ac)

TType Image
#03422 East Calion
+/- 52.73 acres (Tax Acres)
Sec.05-16S/13W
Calhoun Co., AR

 = property boundary

1 in = 1,320 feet

0 660 1,320
 Feet

Created By: DN
Neeley Forestry Service, Inc.
915 Pickett St., Camden, AR 71701
Date: 3/16/2018

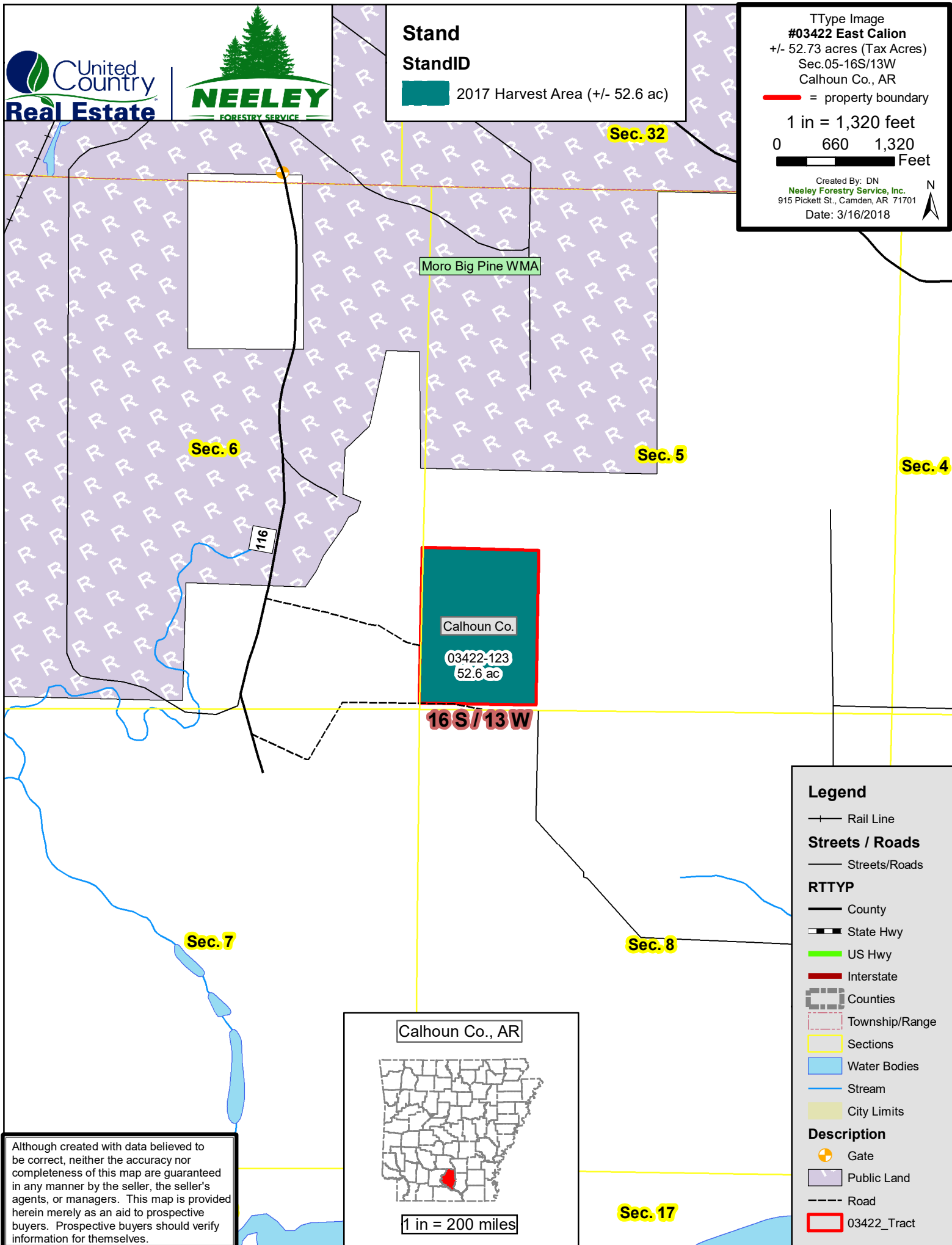

Moro Big Pine WMA

Sec. 6

Sec. 32

Sec. 5

Sec. 4

116

Calhoun Co.

03422-123
52.6 ac

16S/13W

Sec. 7

Sec. 8

Sec. 17

Calhoun Co., AR



1 in = 200 miles

Legend

 Rail Line

Streets / Roads

 Streets/Roads

RTTYP

 County

 State Hwy

 US Hwy

 Interstate

 Counties

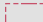
 Township/Range

 Sections

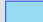
 Water Bodies

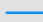
 Stream

 City Limits

Description

 Gate

 Public Land

 Road

 03422_Tract

Although created with data believed to be correct, neither the accuracy nor completeness of this map are guaranteed in any manner by the seller, the seller's agents, or managers. This map is provided herein merely as an aid to prospective buyers. Prospective buyers should verify information for themselves.