



Four Bar Ranch +/-3600 Acres Real & Edwards County, TX



This is a rare opportunity to own part of a large family ranch that has been in a family for generations. Ranches of this size, located this far east, with great access don't come on the market often. The ranch is less than 35 minutes from I-H 10, boasting over +/- 2.7 miles of highway frontage on SH41. Whether you are looking for a hunting/recreational ranch, working livestock ranch or simply an investment, this ranch meets all of those criteria.

Located in far northwestern Real County with a small portion lying in Edwards County
5 water wells

Electricity and land line telephone available

Ranch has perimeter low fencing on three sides with high fencing along south boundary

Cross fenced into 7 pastures

Variety of terrain varying from sprawling, fertile flats to super hill top views

Thick vegetation including **abundant live oaks**

Game includes whitetail, turkey, hog, axis, aoudad, fallow, sika, and occasional elk

Good internal road system

¼ mineral interests to convey

Reduced Price! \$1795/acre

listing #3600

Western Hill Country Realty

glynn@westernhillcountryrealty.com

Glynn Hendley: Broker

www.westernhillcountryrealty.com

830-683-4435



Four Bar Ranch +/-3600 Acres Real & Edwards County, TX

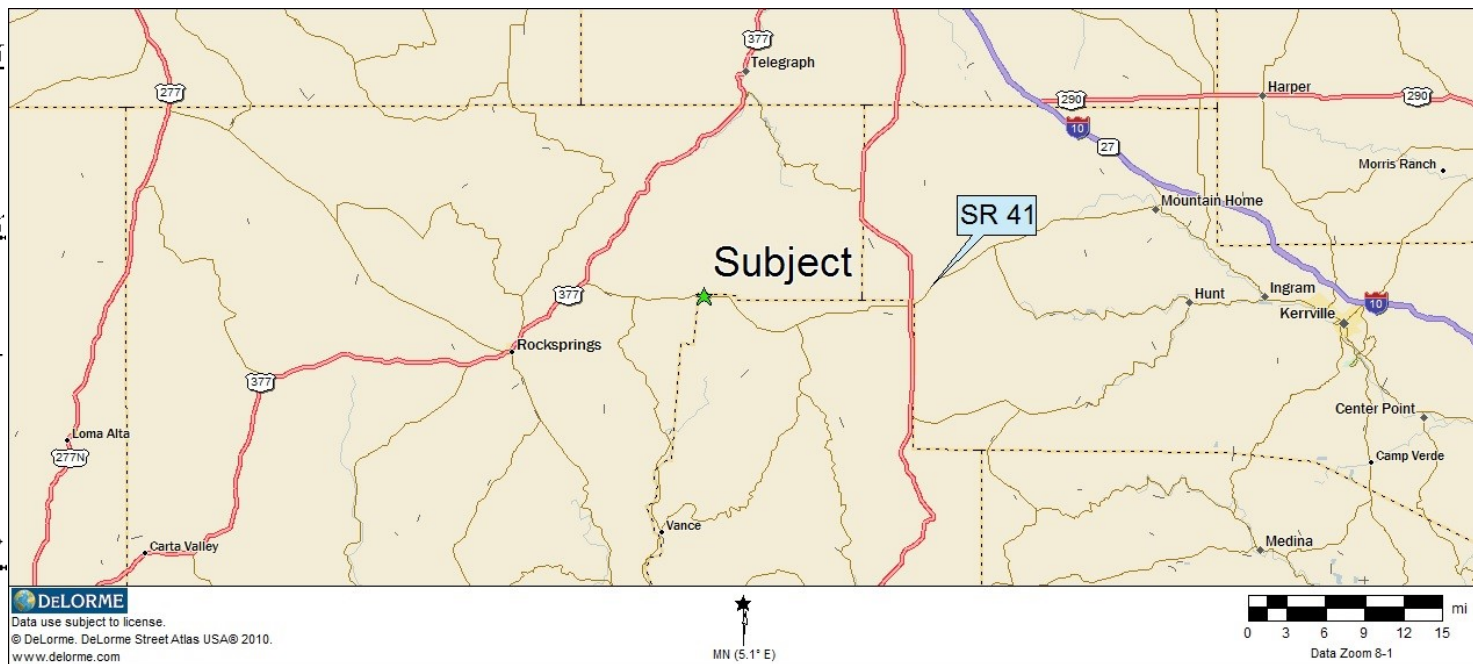
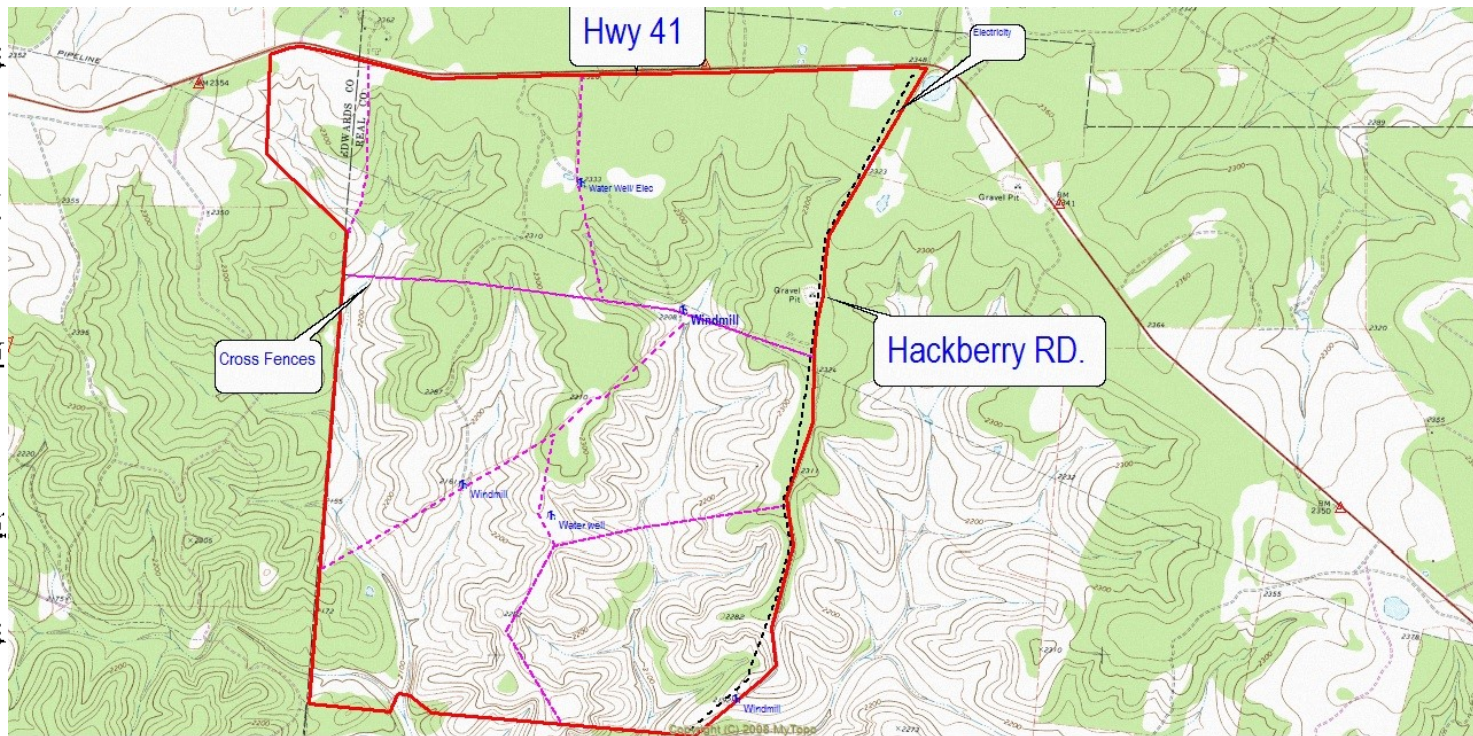



Four Bar Ranch +/-3600 Acres Real & Edwards County, TX



Western Hill Country Realty
glynn@westernhillcountryrealty.com

Glynn Hendley: Broker
www.westernhillcountryrealty.com

830-683-4435



Four Bar Ranch +/-3600 Acres Real & Edwards County, TX

